

CERTIFIED LAND CORNER RESTORATION

Index No. **S-17**

State of Wisconsin } ss.
County of Oneida }

I Phillip T. Hansen, do hereby certify that on the 25th day of ~~January~~ January, 1979, I ~~restored~~ established the N 1/16 corner of Section 26 & 27 Township 35 North, Range 11 East, Fourth Principal Meridian, as described hereon; and that from this evidence I established a new monument and accessories as described hereon to perpetuate the original location of this corner.

Resident witnesses:
Glen Barker
Jim Claffin
Herb Wagoner

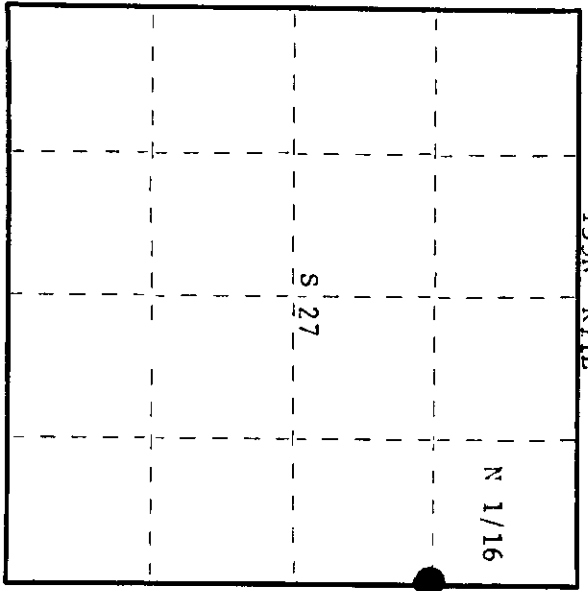
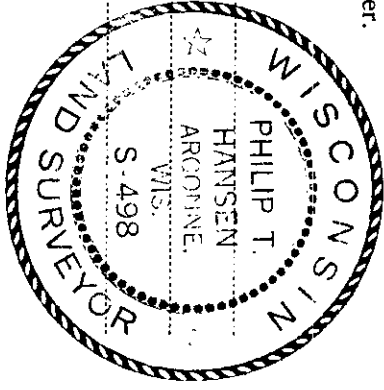

O = Corner monument restored.

History of original corner establishment:
No records of any surveys on this line or corner.

Description of corner evidence found:
Corner established by traverse and computation from NE 1/16 corner section 27 to 1/4 corner between section 26 and 27. Computed distance 2659.848 feet at bearing S 1° 40' 35" W. Set N 1/16 at 1329.924 feet intermediate.

Description of monument and accessories I established to perpetuate the original location of this corner.
Set 1 1/2" iron pipe with 2" brass cap projecting 12" above ground, stamped:
A post, believed set by H.C. Lawrence, Registered Land Surveyor, bears S64° E 4.39 feet from this monument. No record of notes on his corner.
Marked NBT's -
Cedar 6" N88° E 16.48 feet S498
Black Spruce 8" S23° W 7.85 feet, T35N R11E
both scribed 1/16 BT. N 1/16 27 + 26
CPI-1979

Dated at Rhinelander, Wis., this 31st day of January, 1979.

Signature *Phillip T. Hansen* Title Registered Land Surveyor Registration No. S-498
(County Surveyor, Registered Land Surveyor, or other duly authorized official)

Office of Register of Deeds, County of Oneida
Instrument was filed in this office for record on the 14th day of February, 1979.
at 3:30 o'clock M.

Signature *Doris Vergas Fuchsm*
(Register of Deeds)

By Deputy

3511273000