

CERTIFIED LAND CORNER RESTORATION

Index No. S-14

History of original corner establishment:

State of Wisconsin }
County of Oneida } ss.

I, Phillip T. Hansen, do hereby certify that on the 8th day of February, 1979, I ~~found~~ established ~~by~~ the NW 1/16 corner of Section 27 Township 35, North, Range 11, East, Fourth Principal Meridian,

as described hereon; and that from this evidence I established a new monument and accessories as described hereon to perpetuate the original location of this corner.

Resident witnesses:

Glen Barker
Herb Wagoner

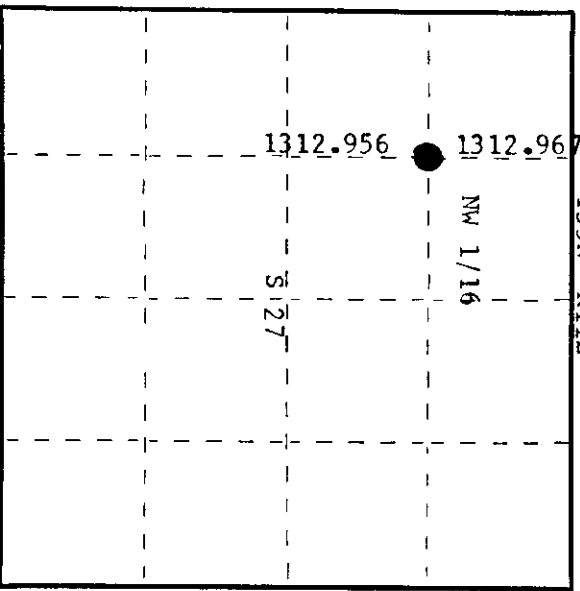
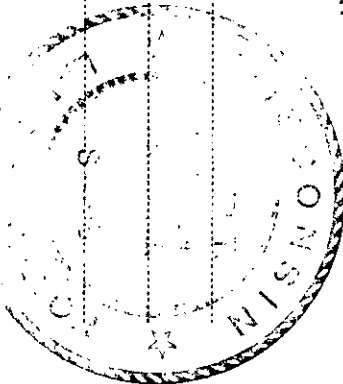

○ = Corner monument restored.

Description of corner evidence found:

No evidence of any corner found. Corner established by traverse and computation from W 1/16 between sections 22 & 27 to WC 1/16 section 27. Computed distance is 2625.973' at bearing S 1-01-18E. Computed location of NW 1/16 corner is 1312.967' of W 1/16 and 1312.956' of WC 1/16.

Description of monument and accessories I established to perpetuate the original location of this corner.

Set a 1 1/2" iron pipe with 2" brass cap projecting 24" above ground. Cap stamped:
Marked NBT's -
Maple 8" S60°W 49.09' - scribed 1/16 BT
White Spruce 5" S82°E 21.15' - scribed 1/16 BT
S498
T35N R11E
NW 1/16 S+27
CPI-1979

Dated at Rhineland, Wis., this 20th day of February, 1979.

Signature: Phillip T. Hansen Title Registered Land Surveyor Registration No. S-498
(County Surveyor, Registered Land Surveyor, or other duly authorized official)

Office of Register of Deeds, County of Oneida, 34 day of March, 1979.
I hereby certify that the within instrument was filed in this office for record on the 30 day of March, 1979 at 30 o'clock P. M.

Doris Veraga Kunkin
(Register of Deeds)

By: _____ Deputy

3511273030