

CERTIFIED LAND CORNER RESTORATION

State of Wisconsin }
 County of Oneida } ss.

I Philip T. Hansen, do hereby certify that on the 26 day of August, 19 75, I found evidence of the S 1/16 corner of Sec. 27 and 28 Township 35 N, Range 11 East, Fourth Principal Meridian, as described hereon; and that from this evidence I established a new monument and accessories as described hereon to perpetuate the original location of this corner:

Description of original monument and accessories and subsequent restorations:

Corner established by H. C. Lawrence, Registered Land Surveyor, 1958. From reestablished $\frac{1}{4}$ corner, he ran a random line S 1° 00" E to intersect E-W fence line 24 lks west of iron pipe set at corner of Sec 27, 28, 33 and 34. Set S 1/16 corner at 19.85 $\frac{1}{2}$ chains intermediate 12 links east of random line. Marked hemlock 15" N 10° W, 165 $\frac{1}{2}$ lks and W. Birch 8" S 43° E 46 lks.

Description of corner evidence found:

Recovered 4" cedar post, squared and scribed S 1/16, S 27, S 1/16 S 28 in fair condition.
 Recovered White Birch 8" S 43° E 46 lks, now a decayed stump.
 Hemlock 15" (16") N 10° W 165.5 lks, scribed S 1/16 S 28 BT

Description of monument and accessories I established to perpetuate the location of this corner:

Replaced 4" cedar post with 1 $\frac{1}{2}$ " iron pipe with 2" brass cap stamped
 NBT Red Pine 8" S 63° W 54.6 lks scribed 1/16 BT

S 498
 T 35 N R 11 E
 S28/S27
 S 1/16
 CPI 1975

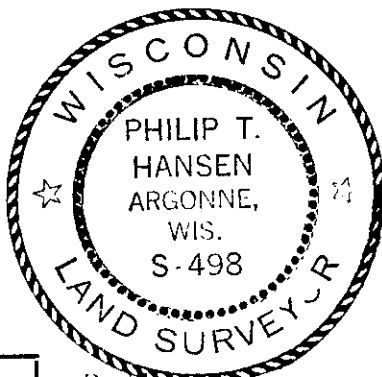

T 35 N R 11 E

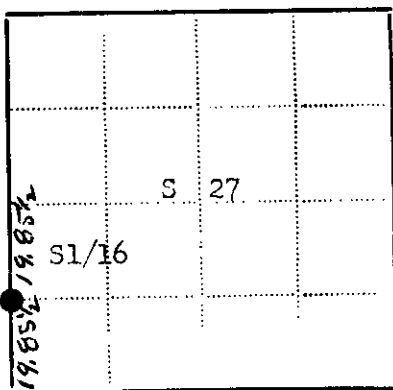

Resident witnesses Glen Barker and Jim Claflin

Dated at Rhineland Wisconsin, this 15th day of September 19 75

Signature Philip T. Hansen Title Reg. Land Surveyor
 (County Surveyor, Registered Land Surveyor, or other duly authorized official)

Surveyors Registration No. S-498

Office of Register of Deeds Oneida County of Oneida

I hereby certify that the within instrument was filed in this office for record on the 14th day of October, 19 75, and was filed in Book No. _____ Page No. _____ of County Records.

Signature Doris Verage Kuehn Title Register of Deeds

Township 35 North, Range 11 East, Section 27 Index No. _____ Page No. _____

3511281000

21-13