

CERTIFIED LAND CORNER RESTORATION

Index No. U-10

State of Wisconsin

County of Oneida } ss.

I, Phillip T. Hansen, do hereby

certify that on the 26th day

of September, 1978, I ~~restored~~

~~restored~~ established the SW 1/16

corner of Section 28

Township 35, North, Range

11 East, Fourth Principal Meridian,

as described hereon; and that from this evidence

I established a new monument and accessories

as described hereon to perpetuate the original

location of this corner.

Resident witnesses:

Jim Clafflin

Herb Wagoner

John Masbaum

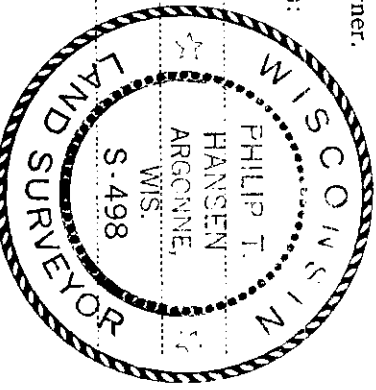

T35N R11E

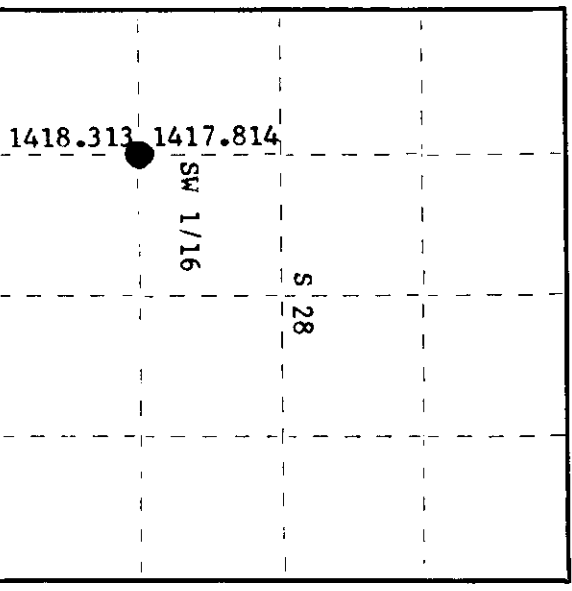

○ = Corner monument restored.

History of original corner establishment:

No records of any previous surveys.

Description of corner evidence found:

No evidence of any corner recovered.

Corner established by traverse and computation. Computed line between W 1/16 section 28 & 33, and the W.C. 1/16 section 28 is 2836.127 feet at bearing N 3° 54' 34" E.

Computed location of SW 1/16 at 1418.313 feet N 3° 54' 34" E of W 1/16 and 1417.814 ft. S 3° 54' 34" W of WC 1/16.

Description of monument and accessories I established to perpetuate the original location of this corner.

Set a 1 1/2" iron pipe with 2" brass cap, stamped:

Monument projects 24" above ground.

Marked NBT's -

White Pine 12" S32°E, 3.86 feet

Maple 6" N79°E, 20.17 feet, scribed 1/16 BT

S498
T35N R11E
SW 1/16 S 28
CPI-1978

Dated at Rhineland, Wis., this 4th day of October, 1978

Signature: Phillip T. Hansen Title: Registered Land Surveyor Registration No. S-498
(County Surveyor, Registered Land Surveyor, or other duly authorized official)

Office of Register of Deeds, County of Oneida, I hereby certify that the within instrument was filed in this office for record on the 18th day of October, 1978 at 1:50 o'clock P. M.

Doris Verage Kuehn
(Register of Deeds)

By: _____ Deputy

3511281030