

CERTIFIED LAND CORNER RESTORATION

Index No. V-9

State of Wisconsin }
County of Oneida } ss.

I, Phillip T. Hansen, do hereby certify that on the 26th day of July, 19 78, I ~~recovered~~ re-established the Section corner of 28, 29, 32 & 33 Township 35, North, Range 11 East, Fourth Principal Meridian, as described hereon; and that from this evidence I established a new monument and accessories as described hereon to perpetuate the original location of this corner.

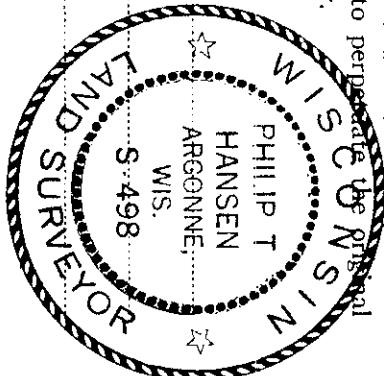

Resident witnesses:

Glen Barker
Jim Clafflin
Herb Wagoner
John Masbaum

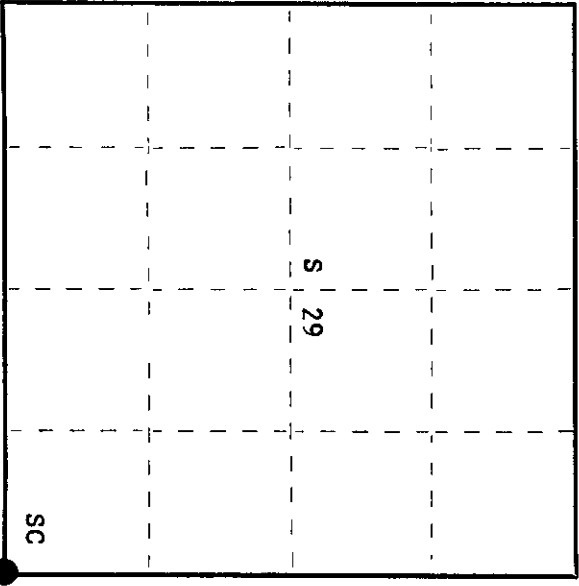

○ = Corner monument restored.

History of original corner establishment:

Original corner established by Wm. E. Dougherty, Deputy Surveyor, in 1859, from which tamarack 8" bears S38°E, 8 links and tamarack 9" bears N65°W, 14 links.

Description of corner evidence found: No evidence of any corner recovered. Corner set by double proportion. Ran traverse from section corner 4, 5, 32 and 33 34-11 and 35-11, to section corner 20, 21, 28 & 29. Computed distance 10,714.589 at bearing N 2° 59' 45" E. Ran traverse from 1/4 corner between section 28 & 33 to section corner 29, 30, 31 & 32. Computed distance is 7618.364 feet at bearing N 88° 38' 57" W. As we were not sure that the accepted corners were original locations, set corner at intersection of traverse and computed lines. Corner sets S 2° 59' 45" W, 5486.153 feet from section corner 20, 21, 28 & 29 N 88° 38' 57" W, 2458.452 feet of 1/4 corner between 28 & 33 N 2° 59' 45" E, 5228.436 feet from Sec. Corner 32, 33, 5 and 4 and S 88° 38' 57" E, 5159.912 feet from section corner 29, 30, 31 and 32.

Description of monument and accessories I established to perpetuate the original location of this corner.

Set a 2 1/2" Berntsen A-1 Federal Monument (O.C.) projecting 30" above ground. Cap stamped: Marked NBT and set three witness pipes.
Black Spruce 7" N70°E, 101.7 feet, scribed SC BT.
#1 witness pipe 1 1/2" x 4' west 14 feet T35N R11E
#2 witness pipe 1 1/2" x 4' N45°W, 10 feet 29 + 28
#3 witness pipe 1 1/2" x 4' south 12 feet 32 + 33
witness monuments project 24". S498-1978

Dated at Rhineland, Wis. this 7th day of August, 19 78.

Signature Phillip T. Hansen Title Registered Land Surveyor Registration No. S-498
(County Surveyor, Registered Land Surveyor, or other duly authorized official)

Office of Register of Deeds, County of Oneida
Instrument was filed in this office for record on the 18th day of September, 19 78
at 1:00 o'clock P. M.

Doris Verage Tucker
(Register of Deeds)

By Doris Verage Tucker Deputy

3511290000