

CERTIFIED LAND CORNER RESTORATION

Index No. **V-7**

State of Wisconsin } ss.
County of **Oneida**

I **Phillip T. Hansen**, do hereby certify that on the **27th** day established **July**, 19 **78**, I ~~found~~ ~~examined~~ the **Quarter** corner of **Section 29 & 32**

Township **35**, North, Range **11 East**, Fourth Principal Meridian,

as described hereon; and that from this evidence I established a new monument and accessories as described hereon to perpetuate the original location of this corner.

Resident witnesses:
Glen Barker
Jim Clafflin
Herb Wagoner
John Masbaum

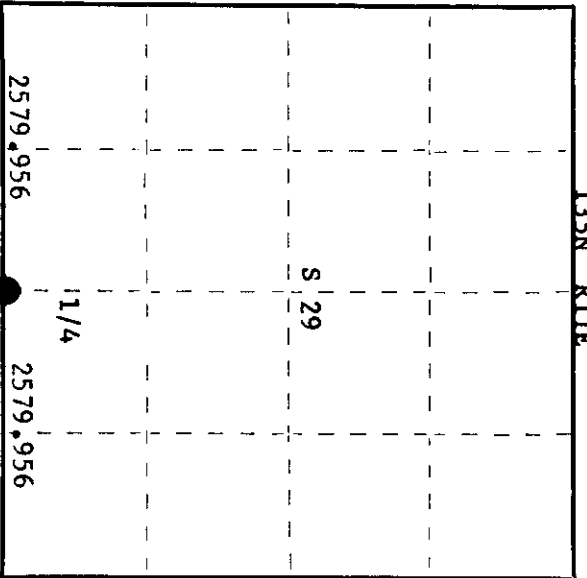
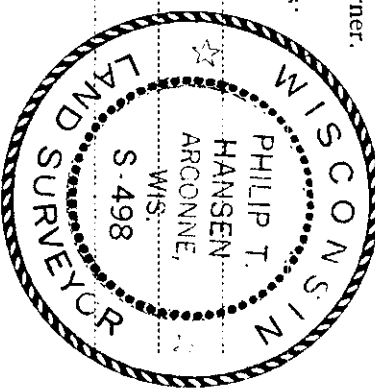

○ = Corner monument restored.

History of original corner establishment:

Original corner established by Wm. E. Dougherty, Deputy Surveyor, in 1859, from which white birch 8" bears N 22° W, 10 links; ash 10" bears S 35° E, 10 links.

Description of corner evidence found:

No evidence of any corner recovered. Corner established by proportion from traverse and computation. Ran traverse from section corner 28, 29, 32 and 33 to section corner 29, 30, 31 and 32. Computed distance is 5159.912 feet at bearing N 88° 38' 57" W. Established corner at 2579.956 feet intermediate.

Description of monument and accessories I established to perpetuate the original location of this corner.

**Set 2 1/2" A-1 Berttsen Federal Monument (O.C.) projecting 12" above ground, cap stamped: Marked NBT's - cedar 9" S66°E 14.10 feet T35N R11E
cedar 10" S63°W 35.82 feet 1/4 S 29
black spruce 7" N50°W, 10.11 feet 1/4 S 32
cedar 6" N17°E 31.60 feet S498-1978
all scribed 1/4 BT**

Dated at **Rhinelander**, Wis., this **7th** day of **August**, 19 **78**

Signature **Phillip T. Hansen** Title **Registered Land Surveyor** Registration No. **S-498**
(County Surveyor, Registered Land Surveyor, or other duly authorized official)

Office of Register of Deeds, County of **Oneida**, I hereby certify that the within instrument was filed in this office for record on the **18th** day of **September**, 19 **78** at **1:00** o'clock **P.M.**

Doris George Fushler
(Register of Deeds)

By: _____ Deputy

3511290020