

CERTIFIED LAND CORNER RESTORATION

Index No. 7-9

State of Wisconsin }  
 County of Oneida } ss.

I, Phillip T. Hansen, do hereby certify that on the 21st day

~~of~~ August, 1978, I ~~found~~ established the Quarter ~~corner~~

corner of Sections 28 and 29

Township 35, North, Range

11 East, Fourth Principal Meridian,

as described hereon; and that from this evidence I established a new monument and accessories as described hereon to perpetuate the original location of this corner.

Resident witnesses:

Glen Barker

Jim Clafflin

Herb Wagoner

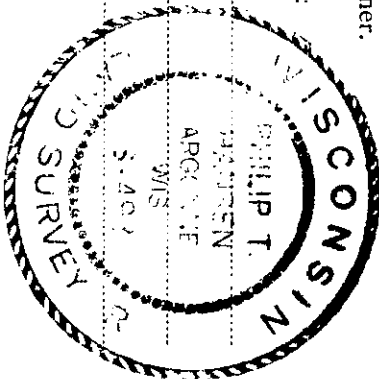

History of original corner establishment:  
 Original corner established by Wm. E. Dougherty, Deputy Surveyor, in 1859 from which Tamarack 8" bears S42°W 9 links; Tamarack 10" bears S60°E 29 links.  
 No records of any subsequent survey.

Description of corner evidence found:

No evidence of any corner recovered.

Corner established by traverse and computation. Ran traverse from section corners 20, 21, 28 and 29 to section corner 28, 29, 32 and 33. Computed distance 5486.153 feet at bearing S 2° 59' 45" W. Established corner at 2743.077 feet intermediate.

Description of monument and accessories I established to perpetuate the original location of this corner.

Set a 2-1/2" Bernitsen A-1 Federal Monument - stamped:

Monument projects 6" above ground.

Placed a rock cairn around base.

Marked NBT's -	W.Spruce 10" N54°W	34.87 feet	T35N R11E
	W.Spruce 8" S88°W	42.73 feet	1/4 29 + 28
	B.Spruce 7" S67°W	30.00 feet	
	Maple 6" S28°W	21.53 feet.	S498 - 1978
	all scribed 1/4 BT.		

Dated at Rhineland, Wis., this 26th day of December, 1979

Signature Phillip T. Hansen Title Registered Land Surveyor Registration No. S-498  
 (County Surveyor, Registered Land Surveyor, or other duly authorized official)

Office of Register of Deeds, County of Oneida  
 Instrument was filed in this office for record on the 14th day of January, 1980  
 at 1:30 o'clock P. M.

Doris Berge Tucker  
 (Register of Deeds)

By \_\_\_\_\_ Deputy

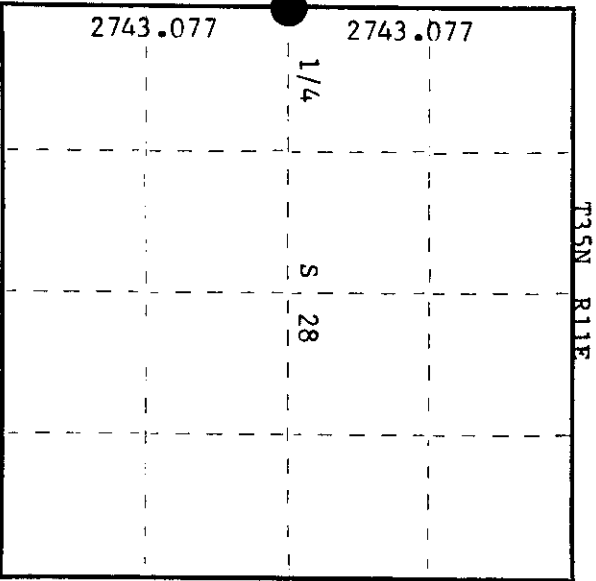

○ = Corner monument restored.

CERTIFIED LAND CORNER RESTORATION

Index No. 7-9

State of Wisconsin

County of Oneida } ss.

History of original corner establishment:  
No records of any survey.

I, Phillip T. Hansen, do hereby certify that on the 16th day of August, 1978, I ~~found~~ restored the E 1/4 corner of Section 29 Township 35, North, Range 11 East, Fourth Principal Meridian, as described hereon; and that from this evidence I established a new monument and accessories as described hereon to perpetuate the original location of this corner.

Resident witnesses:  
Glen Barker  
Jim Clarlin  
Herb Wagoner  
John Kasbaum

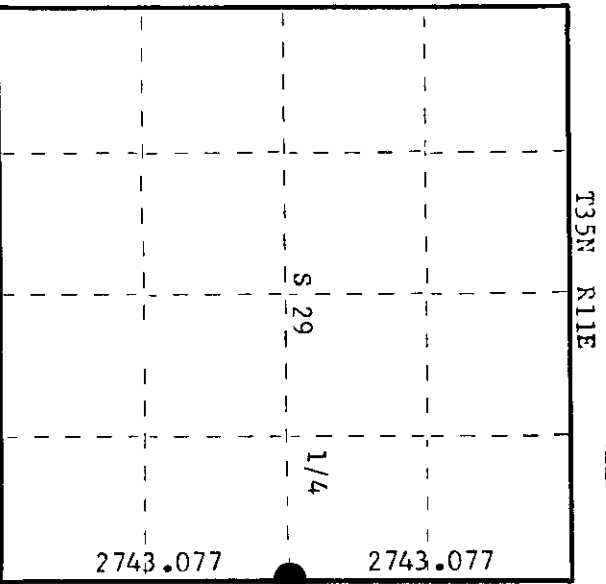
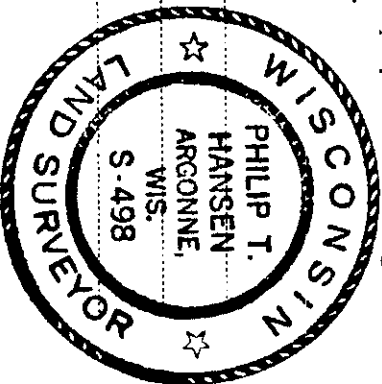

○ = Corner monument restored.

Description of corner evidence found:

No evidence of any corner recovered.  
Corner established by traverse and computation. Kan traverse from section corner 20, 21, 28, 29 to section corner 28, 29, 32 and 33. Computed distance is 5486.153 feet at bearing S 20° 59' 45" W.  
Set E 1/4 at 2743.07 feet intermediate.

Description of monument and accessories I established to perpetuate the original location of this corner.

Set a 2-1/2" Berritsen A-1 Federal Monument (O.C.) projecting 6" - stamped:

Placed rock cairn around base of monument.

Marked NBT's -

W. Spruce 10"	N54°W	34.87 feet	T35N R11E
W. Spruce 8"	S88°W	42.73 feet	1/4 S29 + S28
B. Spruce 7"	S67°W	30.00 feet	
Maple 6"	S28°W	21.53 feet	S498 - 1978

all scribed 1/4 BT

Dated at Rhineland, Wis. this 21st day of August, 1978.

Signature: Phillip T. Hansen Title: Registered Land Surveyor Registration No. S-498  
(County Surveyor, Registered Land Surveyor, or other duly authorized official)

Office of Register of Deeds, County of Oneida, I hereby certify that the within instrument was filed in this office for record on the 18th day of August, 1978 at 2:00 o'clock P.M.

Kevin T. Lange  
(Register of Deeds)

By \_\_\_\_\_ Deputy

3511292000