

CERTIFIED LAND CORNER RESTORATION

Index No. S-9

State of Wisconsin

County of Oneida } ss.

History of original corner establishment:
No records of any previous survey.

I Philip T. Hansen, do hereby certify that on the 16th day of August, 1978, I ~~found~~ established the N 1/16 corner of ~~the~~ Sections 28 & 29 Township 35, North, Range 11 East, Fourth Principal Meridian, as described hereon; and that from this evidence I established a new monument and accessories as described hereon to perpetuate the original location of this corner.

Resident witnesses:
Glen Barker
Jim Claflin
Herb Wagoner
John Masbaum

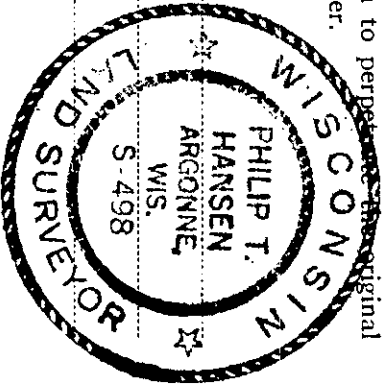

Description of corner evidence found:

No evidence of any corner recovered.
Corner established by traverse and computation. Ran traverse from section corner 21, 22, 28 and 29 to section corner 28, 29, 32 and 33 to establish E 1/4 corner at 2743.007 ft. at bearing S 2° 59' 45" W. Set N 1/16 corner at 1371.539 feet intermediate.

Description of monument and accessories I established to perpetuate the original location of this corner.
Set 1-1/2" iron pipe with 2" brass cap, projecting 27" above ground, cap stamped:

Marked NBT's -
Black Spruce 6" N12°W 8.35 feet S498
Maple 6" S50°W 20.49 feet, scribed 1/16 BT. T35N R11E
N 1/16 29 + 28

CPI-1978

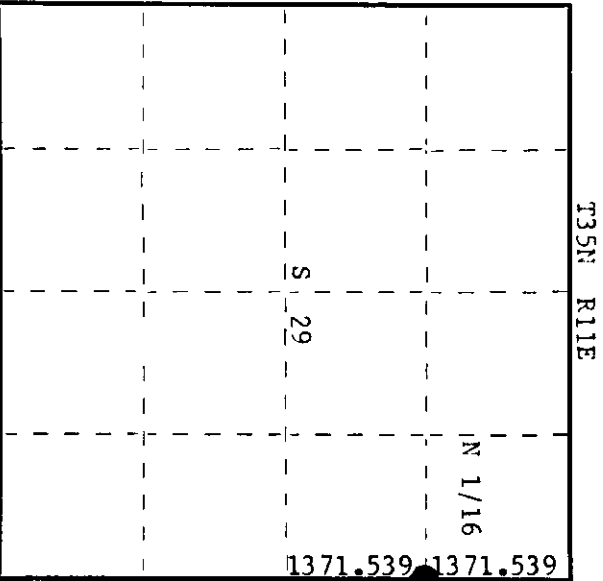

O = Corner monument restored.

Dated at Rhineland, Wis., this 21st day of August, 19 78

Signature: Philip T. Hansen Title: Registered Land Surveyor Registration No. S-498
(County Surveyor, Registered Land Surveyor, or other duly authorized official)

Office of Register of Deeds, County of Oneida
Instrument was filed in this office for record on the 21st day of August, 1979
at 2:00 o'clock P.M. I hereby certify that the within

Signature: James Leeger Fischer
(Register of Deeds)

By: _____ Deputy

3511293000