

CERTIFIED LAND CORNER RESTORATION

Index No. V-5

State of Wisconsin

County of Oneida } ss.

I Phillip T. Hansen, do hereby certify that on the 24th day of March, 1976, I found evidence of the Section corner of 29-30, 31-32 Township 35 North, Range 11 East, Fourth Principal Meridian,

as described hereon; and that from this evidence I established a new monument and accessories as described hereon to perpetuate the original location of this corner.

Resident witnesses:

Jim Clafflin

Herb MacGoner

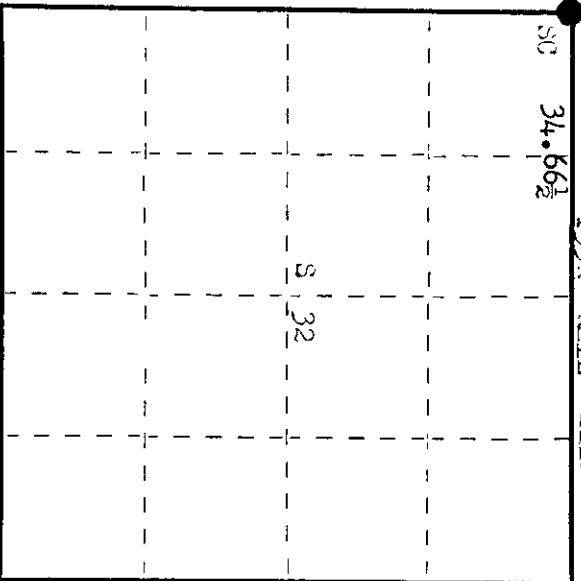
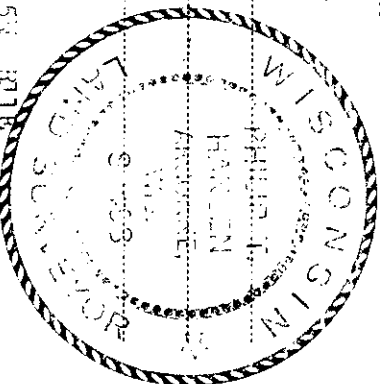

○ = Corner monument restored.

History of original corner establishment: Original corner established by Wm. W. Dougherty, Deputy Surveyor, in 1859, from which W. Birch 8" bears 147° 22 lks and Fir 8" bears 380° 13 lks. Corner set by proportion by D.H. Vaughan, County Surveyor, in 1906. He claims to have recovered the 1/4 corner between sec. 29 and 32 at 34.66 1/2 chains. Corner recovered by H.C. Lawrence, Registered Land Surveyor, in 1952. Recovered an iron pipe and old wooden post in open pasture land.

Description of corner evidence found: recovered 4" squared cedar post, scribed 229, 330, 331, 332 in good condition. This set beside 2 1/2" iron pipe with brass cap, not scribed. No RTs were recovered.

Description of monument and accessories I established to perpetuate the original location of this corner.

Replaced both iron pipe and wood post with 2 1/2" iron pipe with brass cap stamped. Set W.M. - 1" x 3/8" iron pipe due west 25 lks, projects 3" above ground. 1" x 60" iron pipe due north 50 lks, projects 6" above ground. 1" x 3/8" iron pipe due south 20 lks, projects 6" above ground. Corner pipe and W.M.'s painted blue.

T35N R11E
30 | 29
31 | 32
1976

Dated at Rhinelander, Wis., this 18th day of May, 1976.

Signature Phillip T. Hansen Title Registered Land Surveyor Registration No. 1111B
(County Surveyor, Registered Land Surveyor, or other duly authorized official)

Office of Register of Deeds, County of Oneida. I hereby certify that the within instrument was filed in this office for record on the 10th day of May, 1976 at 2:00 o'clock P.M.

Phillip T. Hansen
(Register of Deeds)

By: _____ Deputy

351130 0086