

CERTIFIED LAND CORNER RESTORATION

Index No. W-5

State of Wisconsin

County of Oneida } ss.

History of original corner establishment:
This line run by Gaartz prior to 1952. H.C. Lawrence, Registered Land Surveyor, found his post while running the line in 1952. No records of any post set or BT's marked.

I, Phillip T. Hansen, do hereby certify that on the 27th day of October, 1978, I ~~restored~~ found established the N 1/16 corner of Sections 31 and 32 Township 35, North, Range 11 East, Fourth Principal Meridian, as described hereon; and that from this evidence I established a new monument and accessories as described hereon to perpetuate the original location of this corner.

Resident witnesses:
Glen Barker
Jim Clafflin
Herb Wagoner

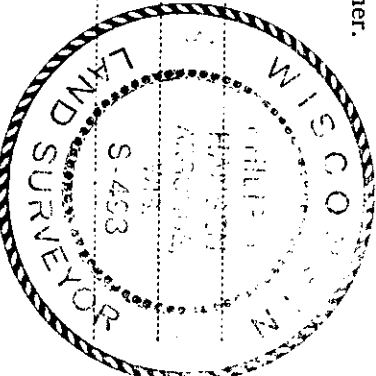

Description of monument and accessories I established to perpetuate the original location of this corner.
Set 1 1/2" iron pipe with 2" brass cap projecting 18" above ground. Cap stamped:
Marked NBT's -
Cedar 6" N43°E 6.37 feet, scribed 1/16 BT S498
Cedar 5" N48°W 17.12 feet, scribed 1/16 BT T35N R11E
N 1/16 31 32
CPI-1978

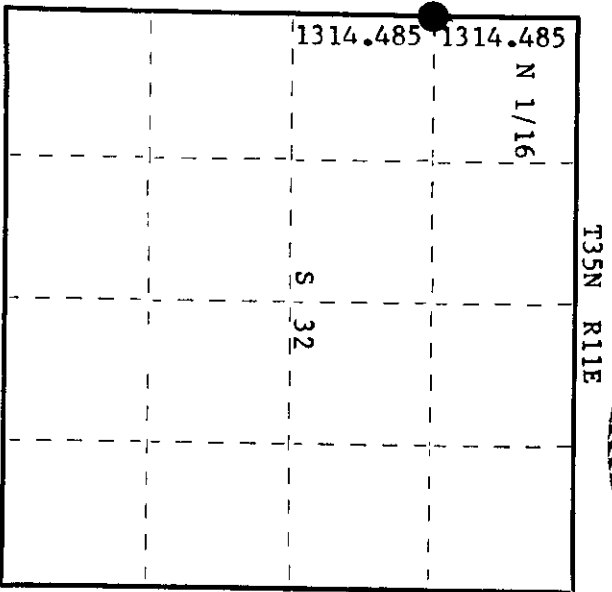

○ = Corner monument restored.

Description of corner evidence found:
No evidence of any corner recovered.

Corner established by traverse and computation. Ran traverse from previously recovered section corners 29, 30, 31 and 32 to 1/4 corner between sections 31 and 32. Computed distance at 2628.97 feet at bearing N 8° 48' 54" E. Set N 1/16 at 1314.485 feet intermediate.

Dated at Rhineland, Wis., this 13th day of November, 1978

Signature: Phillip T. Hansen Title Registered Land Surveyor Registration No. S-498
(County Surveyor, Registered Land Surveyor, or other duly authorized official)

Office of Register of Deeds, County of Oneida
I hereby certify that the within instrument was filed in this office for record on the 27th day of November, 1978 at 1:10 o'clock P.M.

Dennis George Puchner
(Register of Deeds)

By: _____ Deputy

35113/3000