

CERTIFIED LAND CORNER RESTORATION

Index No. 2-6

State of Wisconsin }
County of Oneida } ss.

I Phillip T. Hansen, do hereby certify that on the 15th day of November, 1978, I found ~~restored~~ the W 1/16 corner of Section 32 & 5 Township 35-34, North, Range 11 East, Fourth Principal Meridian, as described hereon; and that from this evidence I established a new monument and accessories as described hereon to perpetuate the original location of this corner.

Resident witnesses:

Glen Barker
Jim Clafflin
Herb Wagoner

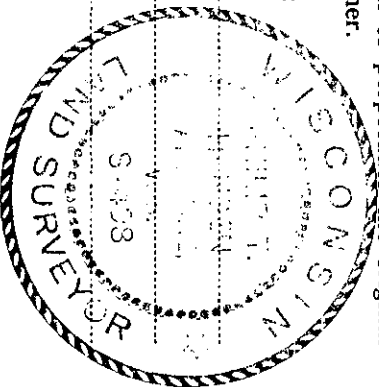

History of original corner establishment:
No records of any previous survey.

Description of corner evidence found:
No evidence of any corner recovered. Established W 1/16 corner by traverse and computation. Ran traverse from section corner 31 and 32, 5 and 6, east, 5604.256 feet to section corner 4 and 5, 32 and 33. Computed bearing N 89° 13' 25" E. Set 1/4 corner at 7802.128 feet intermediate. Set W 1/16 corner at 1401.064' intermediate between 1/4 corner and section corner 31, 32, 5 and 6.

Description of monument and accessories I established to perpetuate the original location of this corner.
Set 2" iron pipe with brass cap projecting 18" above ground, cap stamped:

Marked NBT's -
W. Ash 5" S34°W 33.6 feet T35N R11E
Sugar 5" due west 16.43 feet W 1/16 S+32
both scribed 1/16 BT T34N R11E
S498 - 1978

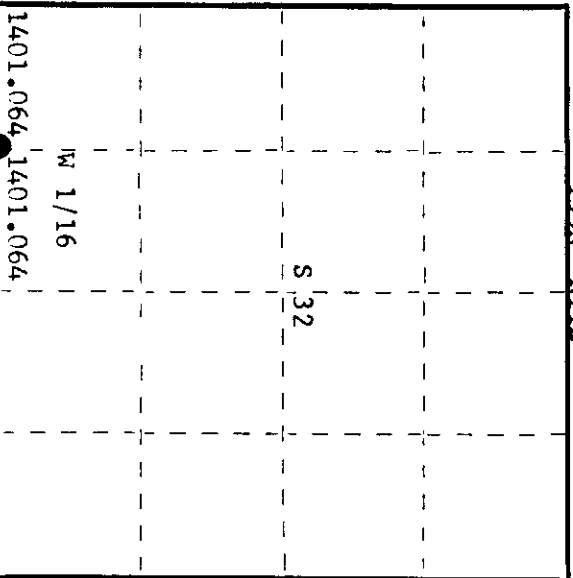

○ = Corner monument restored.

Dated at Rhineland, Wis., this 4th day of December, 1978

Signature Phillip T. Hansen Title Registered Land Surveyor Registration No. S-498
(County Surveyor, Registered Land Surveyor, or other duly authorized official)

Office of Register of Deeds, County of Oneida. I hereby certify that the within instrument was filed in this office for record on the 10th day of January, 1979 at 100 o'clock P. M.

Doreen Wagoner
(Register of Deeds)

By: _____ Deputy

0400781159

CERTIFIED LAND CORNER RESTORATION

Index No. 2-6

State of Wisconsin }
County of Oneida } ss.

History of original corner establishment:
No records of any previous surveys.

I Philip T. Hansen, do hereby certify that on the 27th day of October, 1978, I ~~found~~ recovered the W 1/16 corner of Sections 32 and 5 Township 35 & 34, North, Range 11 East, Fourth Principal Meridian, as described hereon; and that from this evidence I established a new monument and accessories as described hereon to perpetuate the original location of this corner.

Description of corner evidence found:

No evidence of any corner recovered.
Corner established by traverse and computation. Ran traverse between 1/4 corner, sections 32 and 5 and section corner 5, 6, 31 and 32 T34, 35N, R11E. Computed distance 2802.128 feet at bearing N 89° 13' 15" E. Set W 1/16 at 1401.064 feet intermediate.

Resident witnesses:

Glen Barker
Jim Claflin
Herb Wagoner

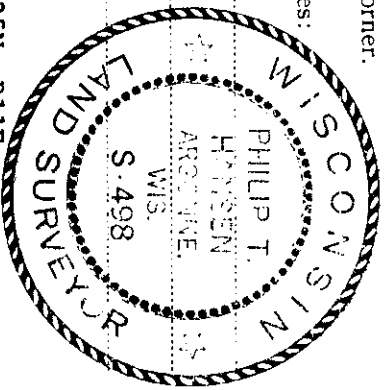

T35N R11E

Description of monument and accessories: I established to perpetuate the original location of this corner. Set 2" iron pipe with brass cap, projecting 18" above ground. Cap stamped:

Marked NBT's - Sugar 5" S13°E, 8.32 feet
Cedar 9" N74°E, 50.25 feet, scribed 1/16 BT

T35N R11E
W 1/16 S+32
T34N R11E
S498 - 1978

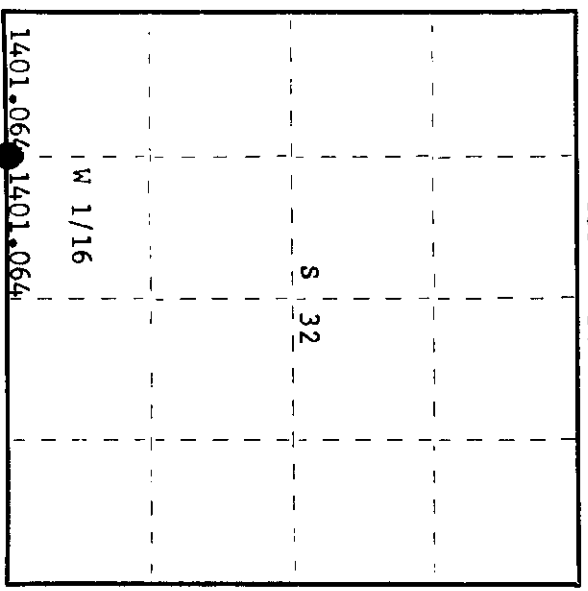

○ = Corner monument restored.

Dated at Rhineland, Wis., this 30th day of October, 1978

Signature Philip T. Hansen Title Registered Land Surveyor Registration No. S-498
(County Surveyor, Registered Land Surveyor, or other duly authorized official)

Office of Registrar of Deeds, County of Oneida
Instrument was filed in this office for record on the 6th day of November, 1978
at 10:00 o'clock A. M.

Doree Leverage Fisher
(Registrar of Deeds)

By: _____ Deputy

3511320030