

CERTIFIED LAND CORNER RESTORATION

Index No. Y-9

State of Wisconsin

County of Oneida } ss.

I Phillip T. Hansen, do hereby certify that on the 6th day of September, 1978, I ~~found~~ established the S 1/16 corner of Sections 32 & 33 Township 35, North, Range 11 East, Fourth Principal Meridian, as described hereon; and that from this evidence I established a new monument and accessories as described hereon to perpetuate the original location of this corner.

Resident witnesses:

Glen Barker
Jim Clafflin
Herb Wagoner

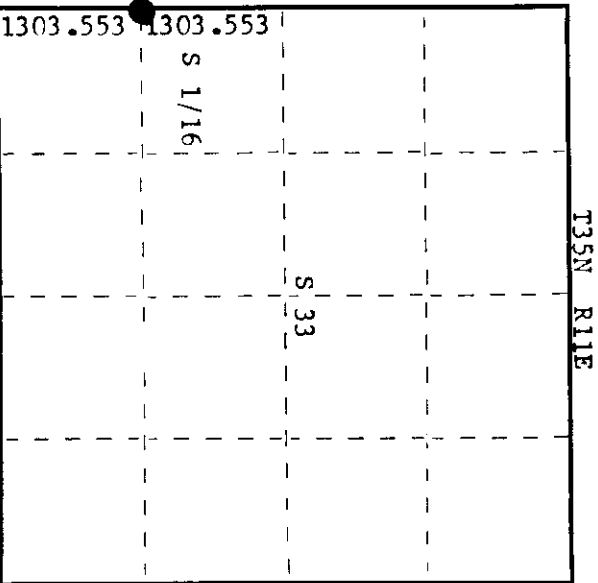
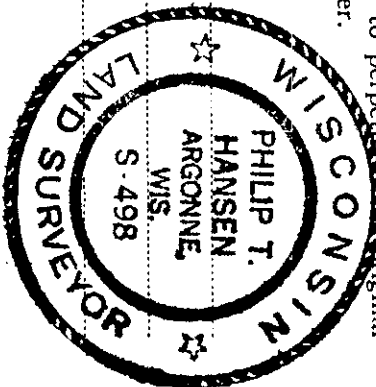

○ = Corner monument restored.

History of original corner establishment:
No record of any previous surveys.

Description of corner evidence found:

No evidence of any corners recovered.
Corner established by traverse and computation. Computed distance between W 1/4 corner and section corner 32, 33, 5 and 4 is 2617.106 feet at bearing S 1° 59' 34" W. Set S 1/16 at 1308.553 feet intermediate.

Description of monument and accessories I established to perpetuate the original location of this corner.

Set 1-1/2" iron pipe with 2" brass cap - stamped:
Monument projects 30" above ground.

Marked NBT's -

B. Spruce 10" N 14° E 66.35' S498
T35N R11E
Cedar 7" S 5° W 48.9 ft. scribed 1/16 BT. S32 + S33
S 1/16

CPI-1978

Dated at Rhineland, Wis., this 11th day of September, 1978

Signature Phillip T. Hansen Title Registered Land Surveyor Registration No. S-498
(County Surveyor, Registered Land Surveyor, or other duly authorized official)

Office of Register of Deeds, County of Oneida I hereby certify that the within instrument was filed in this office for record on the 21st day of May, 1979 at 2:00 o'clock P. M.

Donna Verage Kuehn
(Register of Deeds)

By _____ Deputy

3511321000

CERTIFIED LAND CORNER RESTORATION

Index No. Y-9

State of Wisconsin }
County of Oneida } ss.

I, Phillip T. Hansen, do hereby certify that on the 11th day of September, 1978, I ~~restored~~ established the S 1/16 corner of Sections 32 & 33 Township 35, North, Range 11 East, Fourth Principal Meridian,

as described hereon; and that from this evidence I established a new monument and accessories as described hereon to perpetuate the original location of this corner.

Resident witnesses:

Jim Clafflin

Herb Wagoner

John Masbaum

History of original corner establishment:

No record of any previous survey.

Description of corner evidence found:

No evidence of any corner recovered.
Corner established by traverse and computation from section corner 32, 33 to S 1/4 corner between sections 32 and 33. Computed distance 2617.106 feet at bearing S 1° 59' 34" W.
Set S 1/16 corner at 1308.553 feet intermediate.

Description of monument and accessories I established to perpetuate the original location of this corner.

Set a 1 1/2" iron pipe with 2" brass cap, stamped: S498
Monument projects 30" above ground. T35N R11E
Marked NBT's - Black Spruce 10" N14°E, 66.35 feet S 1/16 32+33
Cedar 7" S5°W, 48.9 feet, scribed 1/16 BT CPI-1978

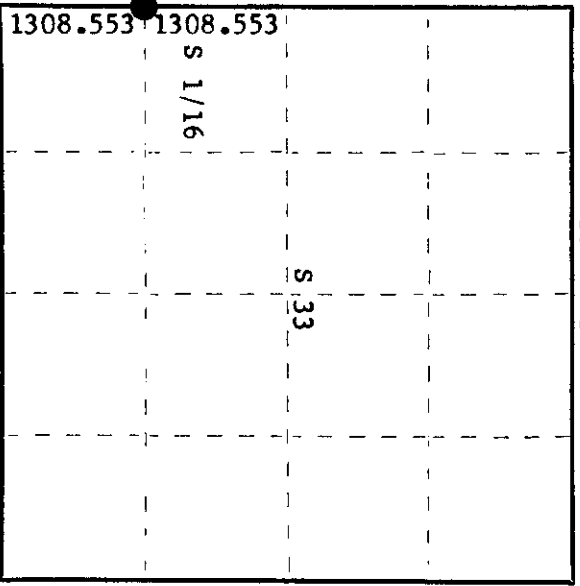

○ = Corner monument restored.

Dated at Rhineland, Wis., this 18th day of September, 1978

Signature: [Signature] Title Registered Land Surveyor Registration No. S-498
(County Surveyor, Registered Land Surveyor, or other duly authorized official)

Office of Register of Deeds, County of Oneida, I hereby certify that the within instrument was filed in this office for record on the 9th day of September, 1978 at 1:50 o'clock P. M.

[Signature]
(Register of Deeds)

By: _____ Deputy