

CERTIFIED LAND CORNER RESTORATION

Index No. W-9

State of Wisconsin }  
County of Oneida } ss.

I Phillip T. Hansen, do hereby certify that on the 19th day of September, 1978, I found established corner ~~corner~~ the N 1/16 corner of sections 32 & 33 Township 35 North, Range 11 East, Fourth Principal Meridian,

as described hereon; and that from this evidence I established a new monument and accessories as described hereon to perpetuate the original location of this corner.

Resident witnesses:

Glen Barker

Jim Clafflin

Herb Wagoner

History of original corner establishment:  
No record of any previous surveys.

Description of corner evidence found:

No evidence of any corner recovered.  
Corner established by traverse and computation. Ran traverse from section corner 28, 29, 32 and 33 to section corner 32, 33, 4 and 5. Set 1/4 corner at 2617.16 feet, bearing S 1° 59' 34" W. Set N 1/16 corner at 1308.553 feet intermediate.

Description of monument and accessories I established to perpetuate the original location of this corner.

Corner falls on large 3' x 3' boulder. Marked point with 3" x 3" X. Set 1 1/2" iron pipe with 2" brass cap for witness corner, stamped:

Marked NBT's to true corner:  
White Birch 8" N89°W, 21.42 feet S498  
White Birch 8" S56°W, 8.00 feet, scribed 1/16 BF. T35N R11E  
N 1/16 32+33 W.C.

S 20 ft.  
CPI-1978

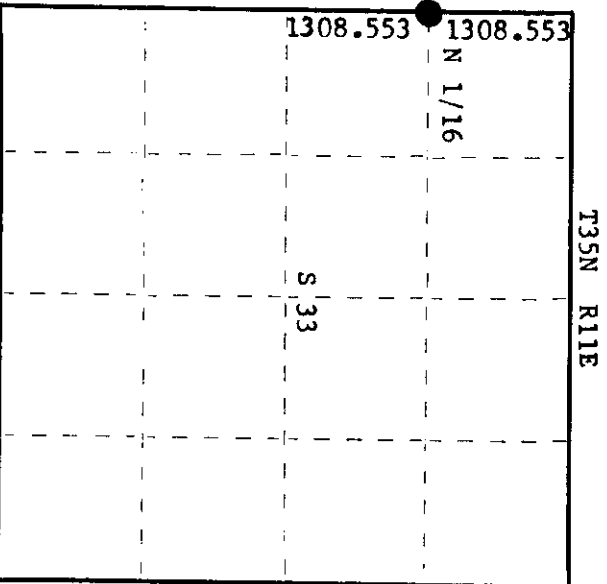

○ = Corner monument restored.

Dated at Rhinelander, Wis., this 25th day of September, 1978

Signature: Phillip T. Hansen Title: Registered Land Surveyor Registration No. S-498  
(County Surveyor, Registered Land Surveyor, or other duly authorized official)

Office of Register of Deeds, County of Oneida  
Instrument was filed in this office for record on the 9th day of October, 1978  
at 1:30 o'clock P. M.

Doris M. Keefe  
(Register of Deeds)

By: \_\_\_\_\_ Deputy