

State of Wisconsin } ss.
 County of Oneida

I, Phillip T. Hansen, do hereby
 certify that on the 12th day
19 78, I ~~found~~
~~restored~~ established the E 1/16
~~corner of~~ Sections 33 and 4
Township 35 S. & 34, North, Range
11 East, Fourth Principal Meridian,

as described hereon; and that from this evidence
 I established a new monument and accessories
 as described hereon to perpetuate the original
 location of this corner.

Resident witnesses:

Glen Barker
Jim Clafin
Herb Wagoner

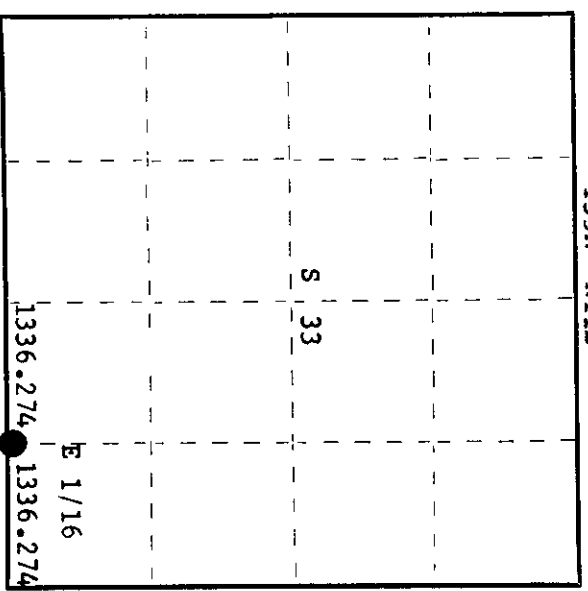
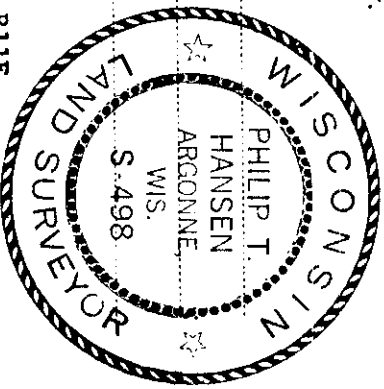

○ = Corner monument restored.

History of original corner establishment: Corner established by H.C. Lawrence, Registered Land Surveyor, during retracement survey in 1948. He ran the section line from section corner 33 & 34 40.58 chains to recover a 4" hemlock post for 1/4 corner. Set a 5" cedar post at 20.29 links, corrected bearing N 88° 24' W. Marked NBT's - white birch 10" N 10° W 15 links and white birch 9" S 5° E, 27 1/2 links.

Corner reset by P.T. Hansen, Registered Land Surveyor, in 1976 by setting temporary point from BT's and measuring 20.29 chains from 1/4 corner. Set 2" iron pipe with brass cap, projecting 18" above ground. Placed rock cairn around the base. Marked NBT - Sugar 6" N 36° W, 30.5 links.

Description of corner evidence found:

Corner reset from traverse and computation during subdivision of section 33.
 Traversed distance from 1/4 corner to section corner 33, 34, 2672.548 feet at bearing S 86° 35' 17" E. Set E 1/16 at 1336.274 feet which was .95' S 53° W from our established corner.

Description of monument and accessories I established to perpetuate the original location of this corner.
 Moved corner monument to corrected position.

New measurement to established BT's -
 W. Birch 12" N6°W, 29.2 feet
 W. Birch 10" S4°W, 19.0 feet
 Sugar 6" N37°W, 20.13 feet

Dated at Rhineland, Wis., this 18th day of September, 19 78

Signature Phillip T. Hansen Title Registered Land Surveyor Registration No. S-498
 (County Surveyor, Registered Land Surveyor, or other duly authorized official)

Office of Register of Deeds, County of Oneida
 instrument was filed in this office for record on the 25th day of September, 19 78
 at 9:50 o'clock P. M.

Doree Leage Fuchs
 (Register of Deeds)

By Doree Leage Fuchs Deputy

0100M112M

CERTIFIED LAND CORNER RESTORATION

Index No. **Z-12**

State of Wisconsin } ss.

County of Oneida

I, Philip T. Hansen, do hereby

certify that on the 28th day

of April, 1976, I found

evidence of the E 1/16

corner of Section 4 and 33

Township 24 S. 35, North, Range

11 East, Fourth Principal Meridian,

as described hereon; and that from this evidence

I established a new monument and accessories

as described hereon to perpetuate the original

location of this corner.

Resident witnesses:

Olson Packer

Alvin Martin

Herb Becker

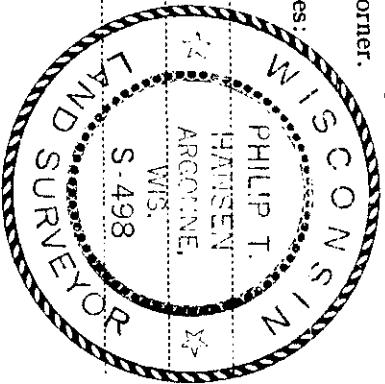

History of original corner establishment: Corner established by H.O. Lawrence, Registered Land Surveyor, during his retracement survey in 1948. He recovered a 4" hemlock post, witnessed by a hemlock 16" S53°E 7' lks, and a 3" birch 10" N44°E 17' lks. The corner was marked by a 4" x 4" x 1/16" x 1/16" cedar post at 20.29 lks, 32 lks south for 1/16, marked NPTs, w. Birch 10" N10°W 45 lks, w. Birch 9" S5°E 27' lks. True bearing of line N33° 24' W.

Description of corner evidence found: Recovered 5" cedar post, squared and scribed 1/16 24, E 1/16 33, corner was not in correct position, as it had followed to have been moved because of logging operations. Set a temporary joint from recovered pipe and established correct position by chaining east from 1/4 corner distance of 20.29 chains. Recovered 10" w. Birch 10" (12") N10°W 45 lks, scribed 33 24. Recovered 9" w. Birch 9" (10") S 3°E 27.5 lks, scribed 24 PT.

Description of monument and accessories I established to perpetuate the original location of this corner. Set a 2" iron pipe with brass cap stamped. Pipe projects 18" above ground level. Placed a rock cairn around base of monument. Pipe 6" N36°E. 30.5 lks scribed 1/16 PT. Pipe and PTs painted blue.

0498
T351 111E
1/16 33
34
1976

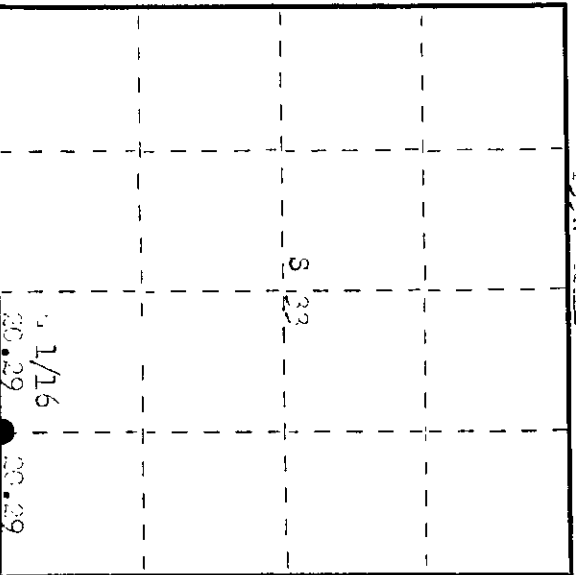

O = Corner monument restored.

Dated at Oneida, Wis., this 14th day of April, 1976

Signature Philip T. Hansen Title Registered Land Surveyor Registration No. 2498
(County Surveyor, Registered Land Surveyor, or other duly authorized official)

Office of Register of Deeds, County of Oneida, I hereby certify that the within instrument was filed in this office for record on the 3rd day of August, 1976 at 10:30 o'clock A. M.

Signature Donna DeWage Kuehn
(Register of Deeds)

By Donna DeWage Kuehn Deputy