

CERTIFIED LAND CORNER RESTORATION

Corrected Corner Y-13 restored on 5/14/76 Index No. Y-13

History of original corner establishment:

Corner ~~restored~~ on May 14, 1976. Recovered H.C. Lawrence's 4" scribed cedar post white birch and maple BT's.

State of Wisconsin

County of Oneida } ss.

I Phillip T. Hansen, do hereby certify that on the 6th day of September, 1978, I ~~know~~ know established ~~know~~ know of the S 1/16 corner of Sections 33 & 34

Township 35 North, Range 11 East, Fourth Principal Meridian,

as described hereon; and that from this evidence I established a new monument and accessories as described hereon to perpetuate the original location of this corner.

Resident witnesses:

Glen Barker

Jim Clafflin

Herb Wagoner

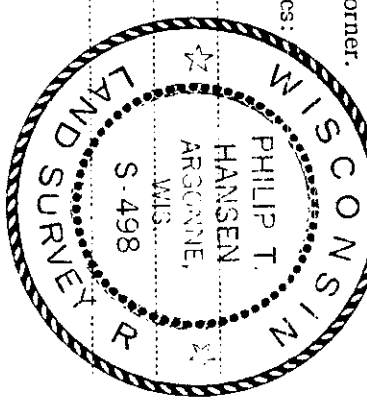

T35N R11E

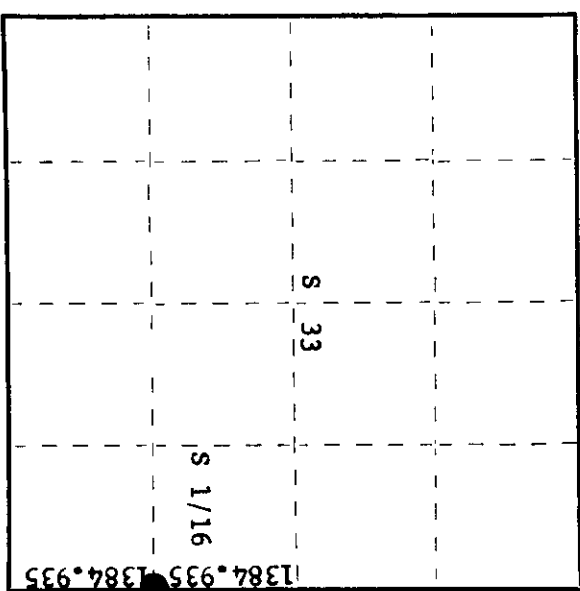

○ = Corner monument restored.

Description of corner evidence found:

Corner established by traverse and computation to subdivide section 33. Ran traverse from E 1/4 corner to section corner 33, 34, 4 and 3. Computed distance was 2769.87 feet at bearing S 4° 51' 15" W. Set S 1/16 corner at 1384.935 feet intermediate. This does not correspond with Lawrence's corner. Lawrence's location was S 8° E, 76.9 feet from our location.

Description of monument and accessories I established to perpetuate the original location of this corner.

Reset 1" iron pipe in its proper position at 1384.935 feet. Monument projects 20" above ground. Measurements to NBT's - yellow birch 7" due west 11.28 feet. maple 5" due south 26.55 feet, scribed 1/16 BT.

Dated at Rhinelander, Wis., this 11th day of September, 1978

Signature Phillip T. Hansen Title Registered Land Surveyor Registration No. S-498
(County Surveyor, Registered Land Surveyor, or other duly authorized official)

Office of Register of Deeds, County of Oneida
Instrument was filed in this office for record on the 35th day of September, 1978
at 2:50 o'clock P. M.

Doris Verage Fuchs
(Register of Deeds)

By: _____ Deputy

3511331000

CERTIFIED LAND CORNER RESTORATION

Index No. **Y-13**

State of Wisconsin

County of Oneida

ss.

I, Phillip T. Hansen, do hereby

certify that on the 24th day

of March, 1976, I found

evidence of the S 1/16

corner of Section 33 & 34

Township 35

North, Range

11 East, Fourth Principal Meridian,

as described hereon; and that from this evidence I established a new monument and accessories as described hereon to perpetuate the original location of this corner.

Resident witnesses:

Jin Clafflin

Herb Wagoner

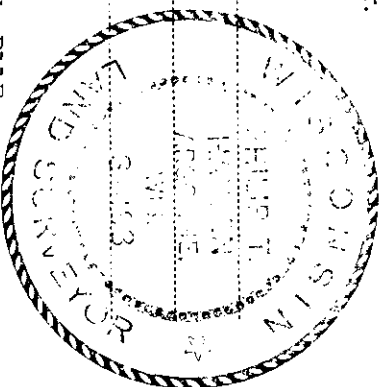

T35N R1E

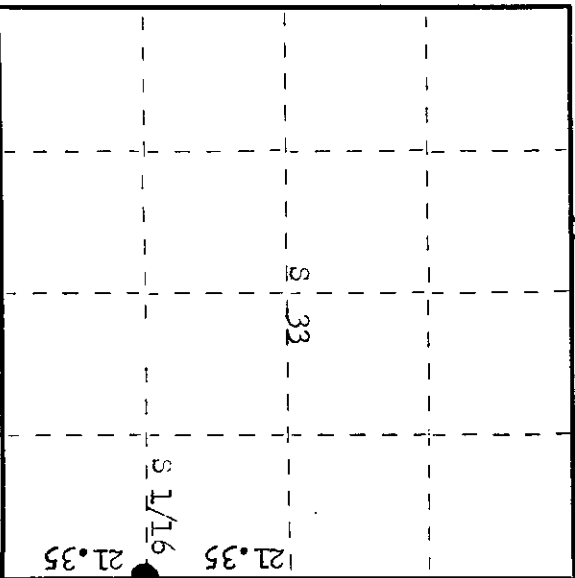

○ = Corner monument restored.

History of original corner establishment: Corner set by H.C. Lawrence, Registered Land Surveyor. He ran the line between section 33 and 34 a distance of 85.40 chains to a point 2.48 chains west of section corner 27-28, 33 and 34. Set S 1/16 corner at 21.35 chains N³ 40' E and 52 lks east of random line. Marked NBTs - W. Birch 9" N34°W 28 lks and Maple 8" S9 1/2°E 34 1/2 lks.

Description of corner evidence found: recovered 4" squared cedar post scribed S 1/16 S33, S34 in fair condition.

Recovered OBTs - white Birch 9" (12") N34°W 28 lks, scribed S33 BT. Maple 8" (10") S9°30'E (S6°E) 34.5 lks (36.0 lks).

Description of monument and accessories I established to perpetuate the original location of this corner. Replaced 4" cedar post with 1" iron pipe with 2" brass cap stamped. Pipe projects 20" above ground. NBTs - Maple 8" N14°W 35.0 lks, scribed 1/16 BT. Pipe and BTs painted blue.

S498
T35N R1E
S 1/16 33/34
CPI-1976

Dated at Rhinelander, Wis., this 24th day of May, 1976.

Signature *Phillip T. Hansen* Title, Registered Land Surveyor Registration No. S-498
(County Surveyor, Registered Land Surveyor, or other duly authorized official)

Office of Register of Deeds, County of Oneida. I hereby certify that the within instrument was filed in this office for record on the 10th day of March, 1976 at 9:00 o'clock P.M.

Phillip T. Hansen
(Register of Deeds)

By _____ Deputy

0001E1155