

CERTIFIED LAND CORNER RESTORATION

Index No. Y-12

State of Wisconsin

County of Oneida } ss.

History of original corner establishment:
No records of any previous survey.

I Phillip T. Hansen, do hereby certify that on the 11th day of September, 1978, I ~~found~~ established the SE 1/16 corner of Section 33

Township 35, North, Range 11 East, Fourth Principal Meridian, as described hereon; and that from this evidence I established a new monument and accessories as described hereon to perpetuate the original location of this corner.

Resident witnesses:

Jim Claflin

Glen Barker

Herb Wagoner

Description of corner evidence found:
No evidence of any corner recovered.
Established corner by traverse and computation. Computed distance from E 1/16 corner between Sections 33 and 4 to EC 1/16. Section 33 is 2719.553 feet at bearing N 1° 53' 13" E. Computed location of EC 1/16 is 1359.776 feet north at E 1/16 and 1359.777 feet south of EC 1/16.

Description of monument and accessories I established to perpetuate the original location of this corner.

Set 1 1/2" iron pipe with 2" brass cap, stamped:
Monument projects 34" above ground.
Marked NBT's -
Sugar 8" N34°E, 19.94 feet
Sugar 7" N16°W, 6.13 feet, scribed 1/16 BT

S498
T35N R11E
S33
SE 1/16
CPI-1978

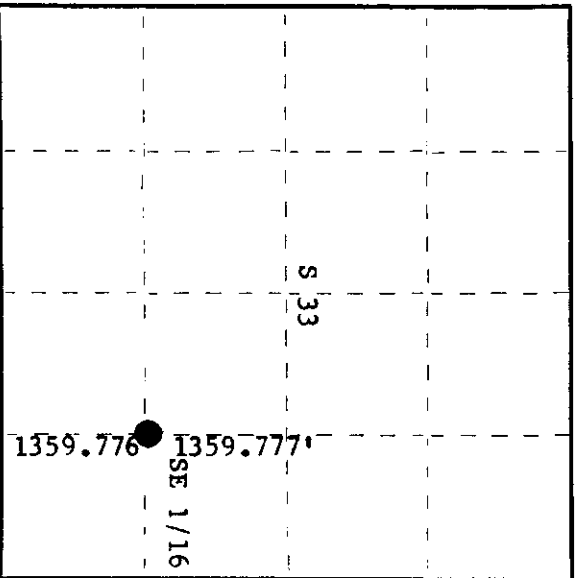

○ = Corner monument restored.

Dated at Rhineland, Wis., this 18th day of September, 1978

Signature Phillip T. Hansen Title Registered Land Surveyor Registration No. S-498
(County Surveyor, Registered Land Surveyor, or other duly authorized official)

Office of Registrar of Deeds, County of Oneida I hereby certify that the within instrument was filed in this office for record on the 9th day of September, 1978 at 1:30 o'clock P. M.

Dore Hange
(Registrar of Deeds)

By: _____ Deputy

3511331010