

CERTIFIED LAND CORNER RESTORATION

Index No. Y-11

State of Wisconsin } ss.

County of Oneida

I Phillip T. Hansen, do hereby certify that on the 6th day of September, 19 78, I ~~found~~ established the SC 1/16 corner of Section 33 Township 35 North, Range 11 East, Fourth Principal Meridian, as described hereon; and that from this evidence I established a new monument and accessories as described hereon to perpetuate the original location of this corner.

Resident witnesses:
Glen Barker
Jim Clafflin
Herb Wagoner

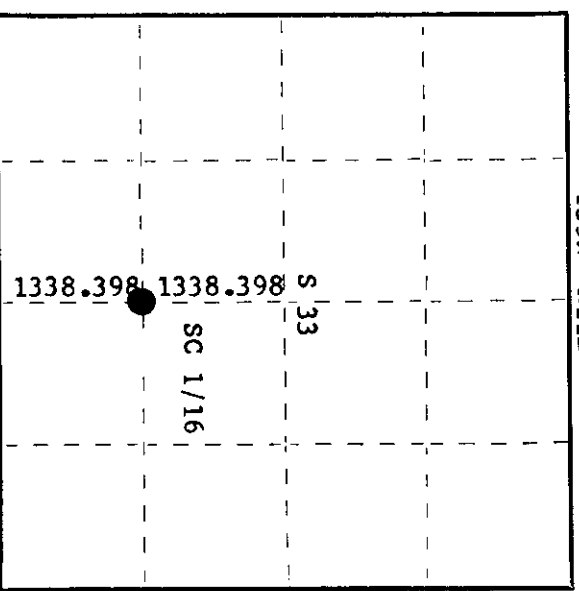
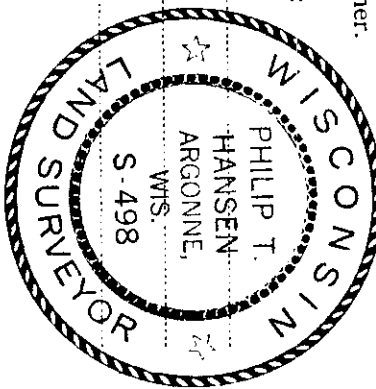

○ = Corner monument restored.

History of original corner establishment:
 No record of any previous survey.

Description of corner evidence found:
 No evidence of any corner recovered.
 Corner established by traverse and computation. C 1/4 corner established from N-S and E-W 1/4 lines. C 1/4 corner is 2676.796 feet, N 1° 11' 01" W of S 1/4 corner. Corner set at 1338.398 feet intermediate.

Description of monument and accessories I established to perpetuate the original location of this corner.
 Set 1 1/2" iron pipe with brass cap, stamped:
 Monument projects 30" above ground.
 Marked NBT's - Sugar 7" N29°E, 27.97 feet
 Sugar 6" S30°E, 27.18 feet, scribed 1/16 BT.

S498
 T35N R11E
 SC 1/16 S 33
 CPI-1978

Dated at Rhineland, Wis., this 11th day of September, 19 78

Signature: Phillip T. Hansen Title: Registered Land Surveyor Registration No. S-498
 (County Surveyor, Registered Land Surveyor, or other duly authorized official)

Office of Register of Deeds, County of Oneida
 Instrument was filed in this office for record on the 25th day of September, 19 78
 at 2:50 o'clock P. M.

Doris Leeger Fuchs
 (Register of Deeds)

By: _____ Deputy

351133 1020