

CERTIFIED LAND CORNER RESTORATION

Index No. Y-10

State of Wisconsin

County of Oneida } ss.

I Phillip T. Hansen, do hereby certify that on the 6th day of September, 19 78, I ~~found~~ established the SW 1/16 corner of section 33

Township 35, North, Range 11 East, Fourth Principal Meridian,

as described hereon; and that from this evidence I established a new monument and accessories as described hereon to perpetuate the original location of this corner.

Resident witnesses:

Glen Barker

Jim Claflin

Herb Wagoner

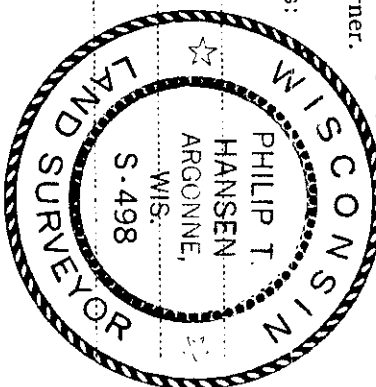

T35N R11E

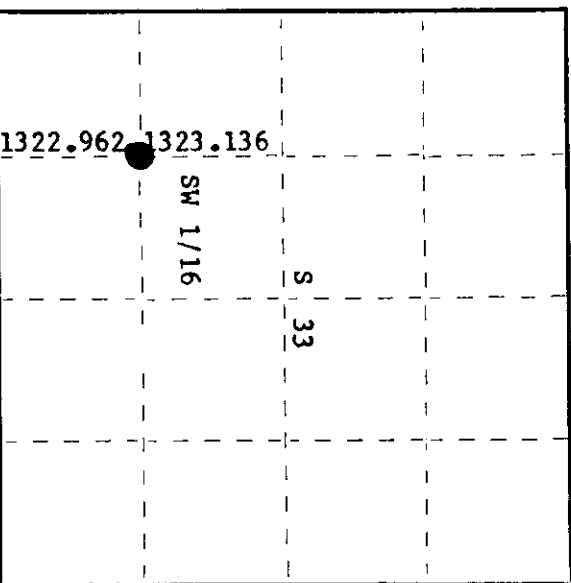

○ = Corner monument restored.

History of original corner establishment:
No records of any previous survey.

Description of corner evidence found:

No evidence of any corner recovered. Corner established by traverse and computation. Computed line between W 1/16 corner and the WC 1/16 at 2646.098' at bearing N 0° 23' 13" E. Set corner at 1322.962' N 0° 23' 13" E of W 1/16 and 1323.136' S 0° 23' 13" W of WC 1/16.

Description of monument and accessories I established to perpetuate the original location of this corner.

Set 1 1/2" iron pipe with 2" brass cap, stamped:
Monument projects 24" above ground.
Marked NPT's - Sugar 7" N57°E, 12.65 feet
Sugar 6" S26°W, 27.17 ft, scribed 1/16 BR.

S498
T35N R11E
SW 1/16 S 33
GPI-1978

Dated at Rhinelander, Wis., this 11th day of September, 19 78

Signature: Phillip T. Hansen Title: Registered Land Surveyor Registration No. S-498
(County Surveyor, Registered Land Surveyor, or other duly authorized official)

Office of Register of Deeds, County of Oneida
Instrument was filed in this office for record on the 25th day of September, 19 78
at 2:50 o'clock P. M.

Dorcas Venage Kuehn
(Register of Deeds)

By: _____ Deputy

03010331135