

CERTIFIED LAND CORNER RESTORATION

Index No. X-10

State of Wisconsin } ss.
County of Oneida

I, Phillip T. Hansen, do hereby certify that on the 6th day of September, 1978, I ~~found~~ established the WC 1/16 corner of Section 33 Township 35 North, Range 11 East, Fourth Principal Meridian, as described hereon; and that from this evidence I established a new monument and accessories as described hereon to perpetuate the original location of this corner.

Resident witnesses:

- Glen Barker
- Jim Clafin
- Herb Wagoner

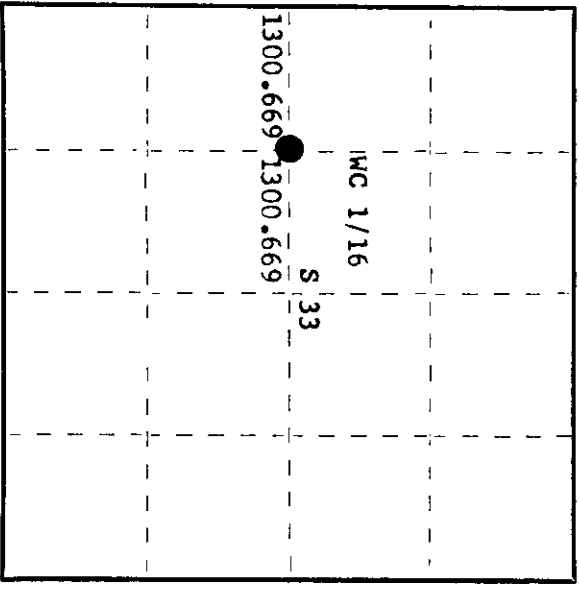
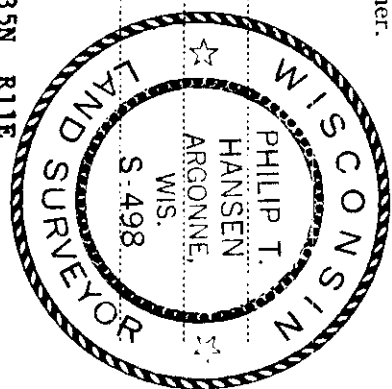

History of original corner establishment:
No records of any previous surveys.

Description of corner evidence found:
No evidence of any corner recovered.
Corner established by traverse and computation. C 1/4 corner established from N-S and E-W 1/4 lines. Computed distance from C 1/4 corner to W 1/4 corner is 2601.339 feet at bearing S 88° 32' 26" E. Corner set at 1300.669 feet intermediate.

Description of monument and accessories I established to perpetuate the original location of this corner.
Set 1 1/2" iron pipe with 2" brass cap, stamped:
Monument projects 24" above ground.
Marked NBT's -
W. Spruce 6" S89°E, 34.0'
W. Spruce 9" N37°W, 19.75'
scribed 1/16 BT.
S498
T35N R11E
WC 1/16 S 33
CPI-1978

Dated at Rhinelander, Wis. this 11th day of September, 1978

Signature: *Phillip T. Hansen* Title: Registered Land Surveyor Registration No. S-498
(County Surveyor, Registered Land Surveyor, or other duly authorized official)
Office of Register of Deeds, County of Oneida
Instrument was filed in this office for record on the 25th day of September, 1978 at 2:58 o'clock P.M.

Signature: *Dore Leverage Fuchs*
(Register of Deeds)

By: Deputy

3511332030