

State of Wisconsin }  
 County of Langlade } ss.

I, Philip T. Hansen, do hereby certify that on the 18th day of November, 1976, I found evidence of the Section corner of Sec. 36, 31, 6-1 Township 34 & 35, North, Range 11 & 12, Fourth Principal Meridian, as described hereon; and that from this evidence I established a new monument and accessories as described hereon to perpetuate the original location of this corner.

Resident witnesses:

Glen Barker

Jim Claflin

Herb Wagoner

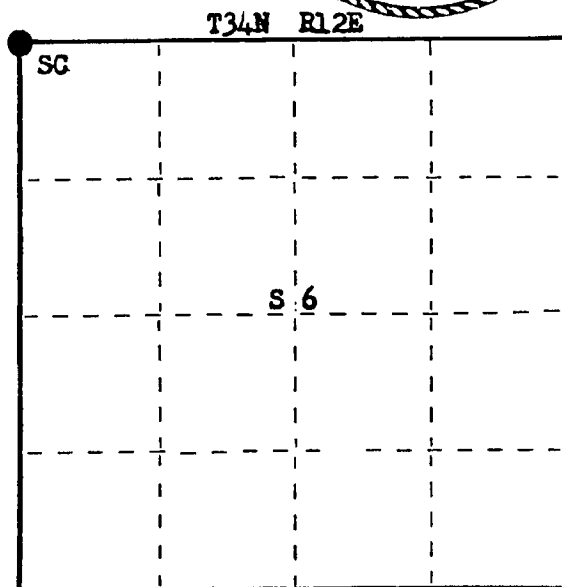
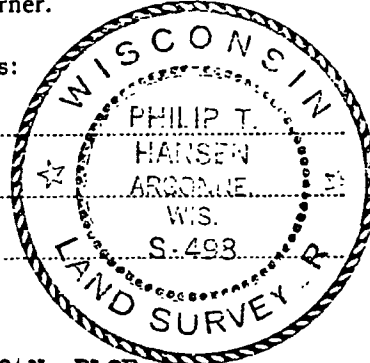

○ = Corner monument restored.

CERTIFIED LAND CORNER RESTORATION

3511360000  
 4/28/17 M ONEIDA INDEX AS 2-25 IN 35-11  
 BETTER COPY FROM LANGLADÉ CITY Index No. A-25 MQR 34-11

History of original corner establishment: Original Corner established by Alfred Millard, Deputy Surveyor, in 1857 from which Spruce 12" bears N 61° W 17 links, White Pine 8" bears S 50° W 49 links, White Pine 12" bears S 23° E 42 links and White Pine 10" bears N 60° E 33 links.

H.C. Lawrence, Registered Land Surveyor, recovered an old post of large size in 1953, no mention of any old BTs recovered or new BTs established. Origin of old post unknown.

Description of corner evidence found:

Recovered 7" cedar post, 8 ft. tall, squared and scribed 36 T35N R11E, 31, T35N R12E, 6, T34N R12E, 1, T34N R1E. Post was recovered in fair condition.  
 Recovered OBT - Elm 14" N 60° E 63 links, scribed S31 BT (now dead).

Description of monument and accessories I established to perpetuate the original location of this corner.

Replaced old cedar post with 2½" Berntsen A-1 Federal Monument, aluminum with magnet in cap and base. Cap stamped:

Monument projects 24" above ground.

Built rock cairn around base of monument.

NBTs - Sugar 6" S 44° E 52.7 links, scribed SC BT.

White Pine 10" S 6° E 50 links, scribed SC BT.

White Spruce 12" S 8° W 56 links, scribed SC BT.

Maple 7" N 16° W 94 links, scribed SC BT.

R	T35N	R
11	36 31	12
E	1 6	E
	T34N	
	S498 1976	

Dated at Rhineland, Wis., this 23rd day of November, 1976.

Signature Philip T. Hansen Title Registered Land Surveyor Registration No. S-498  
 (County Surveyor, Registered Land Surveyor, or other duly authorized official)

Office of Register of Deeds, County of Langlade, I hereby certify that the within instrument was filed in this office for record on the \_\_\_\_\_ day of \_\_\_\_\_, 19\_\_\_\_ at \_\_\_\_\_ o'clock \_\_\_\_\_ M.

(Register of Deeds)

By \_\_\_\_\_ Deputy

# U.S. PUBLIC LAND SURVEY MONUMENT RECORD

Note: This form is intended and designed to fulfill all requirements of Wisconsin Administrative Code, Chapter A-E 7.08 U.S. Public Land Survey Monument Record (3) (a) (b) (c) (d) (e) (f) (g) (h) (i). An additional sheet may be added if necessary to conform with said requirements.

(a) Corner location: Township 35 North  
Range 11 East/West  
Town/City/Village SCHOEPKE  
County ONEIDA

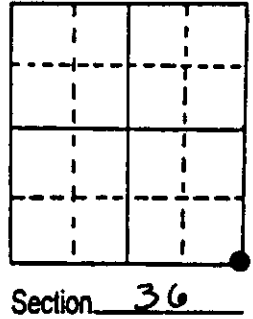
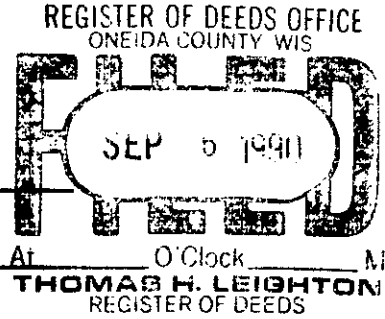

(b) (f) (g) (h) Description of monument found at this corner and if it was accepted, state all evidence (material, testimonial, occupational, plats, records, other monuments) used as a basis for accepting. If not accepted or if nothing was found, state evidence used as basis for establishing location. If reestablished through lost corner proportionate methods, indicate all monuments, distances and directions used to establish. Indicate type of monument found or set and sign post.

1859 - FELLOWS ESTABLISHED ORIGINAL CORNER

1976 - CONSOLIDATED PAPER CO. PERPETUATED CORNER & SET 3" AL MONUMENT

1990 - I FOUND 3" AL MONUMENT & 3 EXISTING BT'S. MADE 1 NEW BT.

(c) (d) (e) Plan view of corner with ties to at least 4 witness monuments. If in disagreement with previously established corner, show the distances between the two corners and also indicate the ties to the disputed corner.

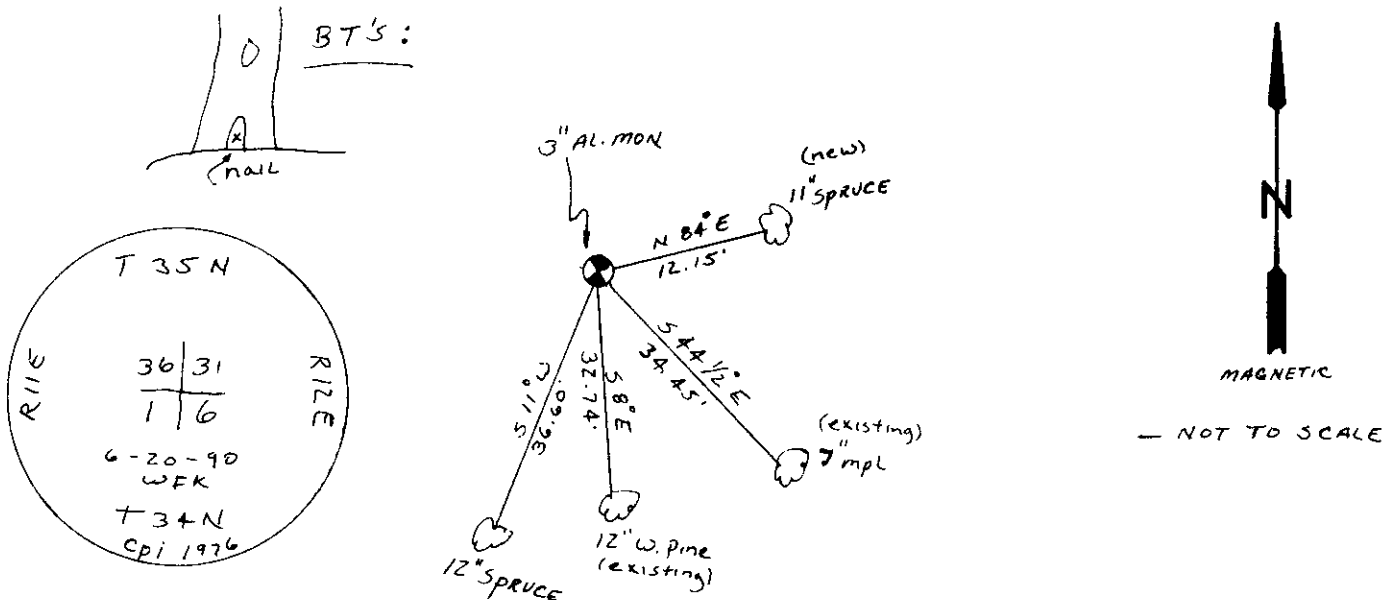

(i) I, WILLIAM F. KELLY  
(type or print name) certify that the corner location on this record was determined by me or under my direction and control and that this U.S. Public Land Survey Monument Record is correct and complete to the best of my knowledge and belief.

William F. Kelly Signature Date 8-28-90

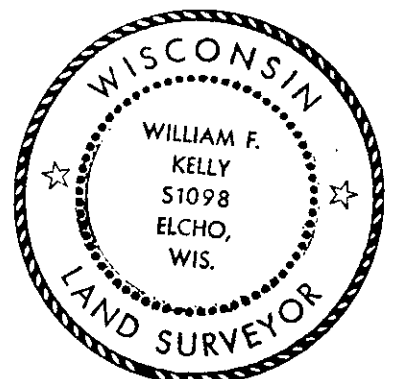

Index No. 2-75

Stamp  
3511360600