

CERTIFIED LAND CORNER RESTORATION

Index No. **Y-25**

State of Wisconsin }  
 County of **Oneida** } ss.

I **Phillip T. Hansen**, do hereby certify that on the **30th** day of **November**, 19 **76**, I found evidence of the **S 1/16** corner of **Section 31 and 36** Township **35** North, Range **12 East**, Fourth Principal Meridian, as described hereon; and that from this evidence I established a new monument and accessories as described hereon to perpetuate the original location of this corner.

Resident witnesses:  
**Glen Barker**  
**Jim Martin**  
**Herb Wagoner**

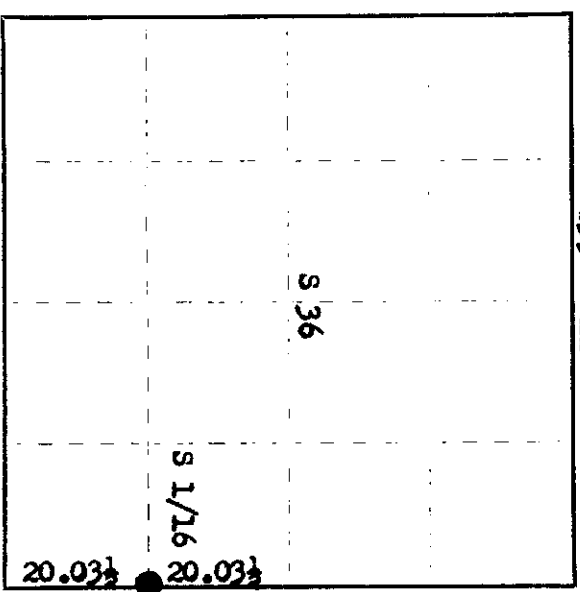
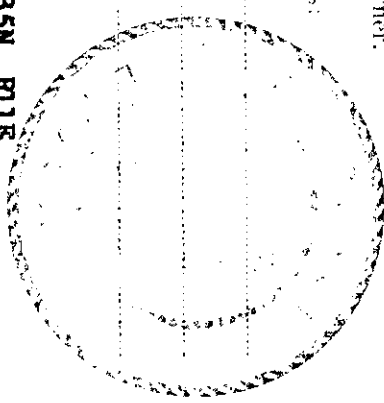

History of original corner establishment:

Corner established by H.C. Lawrence, Registered Land Surveyor, in 1959. Ran random line S 3° 00' E from recovered Section Corner 25, 30, 31 and 36 80.14 chains to close out 4.7 links east of Township Corner. Set 6" cedar post for south 1/16 at 60.10 chains, equidistant between 1/4 corner and Township Corner, 35 links west. Marked cedar stump 12" S 20° E 7 1/2 links and Cedar 10" N 80° E 33 links.

Description of corner evidence found:

Recovered 6" cedar post, squared and scribed S 1/16 S31 R12E, S 1/16 S36 R12E in fair condition. Also an old cedar stake scribed 1/8S laying beside it.  
 Recovered OBTs - Cedar stump 12" S 20° E (S 12° E) 7.5 links, scribed S 1/16 BO. Cedar 10" S 80° E 33 links, scribed S 1/16 S31 BT.

Description of monument and accessories I established to perpetuate the original location of this corner.

Replaced 6" cedar post with 1 1/2" OD iron pipe with 2" brass cap, stamped:  
 Monument projects 2' above ground.  
 MBT - Cedar 8" N 60° W 49.5 links, scribed 1/16 BT.

S498  
 R T35N R  
 11 36 31 12  
 E E  
 CPI-1976

Dated at **Rhinelander**, Wis., this **13th** day of **December**, 19 **76**

Signature **Phillip T. Hansen**, Title **Registered Land Surveyor** Registration No. **S-498**  
 (County Surveyor, Registered Land Surveyor, or other duly authorized official)  
 Office of Register of Deeds, County of **Oneida**  
 Instrument was filed in this office for record on the **26th** day of **December**, 19 **76**  
 at **10** o'clock **P.** M.

**Terrie George Keebler**  
 (Register of Deeds)

BY **Phillip T. Hansen** Deputy

3511361000