

State of Wisconsin } ss.

County of Oneida

I Phillip T. Hansen, do hereby certify that on the 3rd day of December, 1976, I found evidence of the C 1/4 corner of Section 36 Township 35, North, Range 11 East, Fourth Principal Meridian, as described hereon; and that from this evidence I established a new monument and accessories as described hereon to perpetuate the original location of this corner.

Resident witnesses:  
Glen Barker  
Jim Clafin  
Herb Wagoner

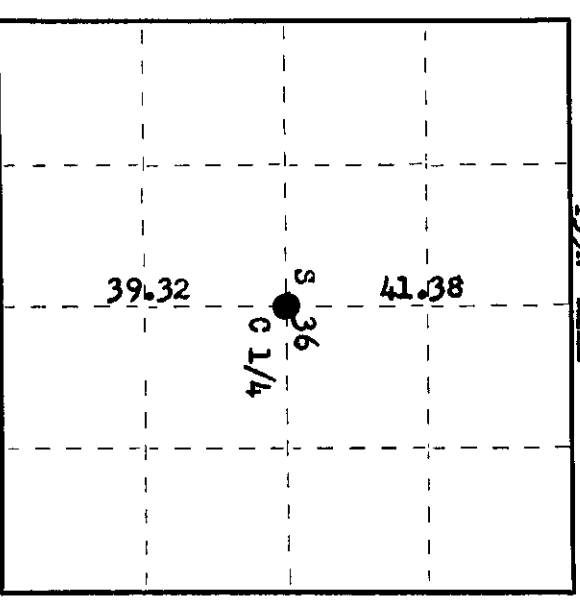
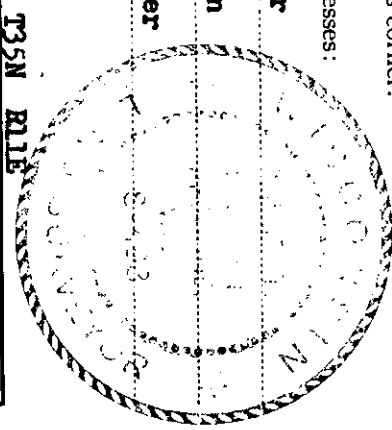

○ = Corner monument restored.

History of original corner establishment:

H.C. Lawrence, Registered Land Surveyor, recovered and accepted Fence Corner as C 1/4 corner. Fence runs west and north from this corner, an old birch 1/4" bears N 38° W 31 links. No record of NBTs established. Set a 3" cedar post.

Description of corner evidence found:

Recovered 3" cedar post, squared and scribed C 1/4 S S36 C 1/4 S in fair condition.  
 Recovered OBTs - White Birch N 38° W 31 links, now down and decayed.  
 White Pine 18" S 89° W 13.7 links, scribed C 1/4 S BT.  
 Maple 16" N 12° W 29.7 links, scribed C 1/4 S BT.  
 No record of these BTs.

Description of monument and accessories I established to perpetuate the original location of this corner.

Replaced 3" cedar post with 2 1/2" iron pipe with brass cap, stamped:  
 Monument projects 2 1/2' above ground level.  
 NBT - Sugar 10" N 12° E 58.6 links, scribed C 1/4 BT.  
 Placed rock cairn around base of monument.

3498  
 T35N R11E  
 C 1/4 S 1/4  
 GPI-1976

Dated at Rhinelander, Wis., this 3rd day of December, 1976

Signature: Phillip T. Hansen Title: Registered Land Surveyor Registration No. S-498  
 (County Surveyor, Registered Land Surveyor, or other duly authorized official)

Office of Register of Deeds, County of Oneida. I hereby certify that the within instrument was filed in this office for record on the 3rd day of December, 1976 at 1:00 o'clock P. M.

Deane W. Berger  
 (Register of Deeds)

By: \_\_\_\_\_ Deputy

07029222