

CLIP IF WEST

	01	05	09	13	17	21	25
A	6	5	4	3	2	1	
E	7	8	9	10	11	12	
J	18	17	16	15	14	13	
N	19	20	21	22	23	24	
R	30	29	28	27	26	25	*
V	31	32	33	34	35	36	
Z							

CERTIFIED CORNER PERPETUATION

CHECK BOX IF INFO ON BACK:

- 1 THE COMMON CORNER OF SECTIONS 19, 24, 25, & 30, T36 N, R34E
- 2 ORIGINAL GOVERNMENT SURVEYOR: ALEX ANDERSON, DATE: JULY, 1864
- 3 ORIGINAL BEARING TREES -DIST. IN FEET- RECOVERY NOTES
- 4 FIR 8" N55°W 21 LKS- 13.86' -
- 5 TAMARAC 9" N30°E 33 LKS- 21.78' -
- 6 TAMARAC 7" S14°E 7 LKS- 4.62 -
- 7 FIR 6" S38°W 12 LKS- 7.92 -
- 8 ORIGINAL TOPOG CALLS -DIST. IN FEET- PRESENT TOPOGRAPHY
- 9 CREEK NORTH 16.64 CHS- 1098.24' -
- 10 LEAVE TAM. SWP W 15.00 CHS- 990' -
- 11 SUBSEQUENT RECORDS IN COUNTY SURVEYOR OFFICE WITH REFERENCE HERETO:
- 12 FB 86- 22, 24, 33, 34, & 45. FB 86- 17, 18, 19, 20, 21, 28, & 30 FB 91- 204
- 13
- 14 SUBSEQUENT MONUMENTS OF RECORD - SURVEYOR - DATE - RECORD NO
- 15 - - - -
- 16 - - - -
- 17 SUBSEQUENT BT'S OR WM'S -DIST. IN FEET- SURVEYOR - DATE - RECORD NO
- 18 12" BASS E55°N (N35E) - 9' - MITCHELL - 1937 - FB 86- 22
- 19 14" MAPLE W55°S (S35W) - 20' - " - " - "
- 20
- 21 OTHER INFO IN RECORDS: FB 86-21 SAYS 2634' N FROM 1/4 BET. 25 & 30 TO SEC COR.
- 22 24, 25, 30, 19. FB 86- 22 SAYS 5266' N FROM THIS COR TO SEC COR 18, 13, 24, 19.
- 23 FB 86- 23 SAYS 5154' WEST TO SEC COR 23, 24, 25, 26.
- 24 EVIDENCE FOUND AT CORNER: OLD PIPE WITH CAP FOUND - (MITCHELL, 1937)
- 25
- 26
- 27 PERSONS WHO SAW EVIDENCE: PDH - CAN
- 28 OTHER REASONS FOR LOCATING CORNER HERE: MEASURED DISTANCE COMPARES TO
- 29 RECORD DISTANCE
- 30
- 31 PRESENT CORNER MONUMENT: 2" x 30" FLANGED GALVANIZED IRON PIPE WITH A
- 32 GALVANIZED IRON CAP - PROTRUDES 1 FT. FROM GROUND
- 33 PRESENT WITNESS MONUMENTS: 1 1/2" x 30" SOLID ROUND IRON BARS
- 34 (BT'S MEASURED TO HEAD OF ALUMINUM NAIL IN BLAZE)
- 35 GENERAL AREA DESCRIPTION: ON W EDGE OF ROAD N & S
- 36
- 37 STATE PLANE COORDINATES-N ZONE: REGISTER OF DEEDS OFFICE
- 38 N ONEIDA COUNTY
- 39 E FILED
- 40 BASIS FOR TIE BEARINGS:
- 41 MAG. AZ. - NO DECL. ADJUST.

MAY 06 2016

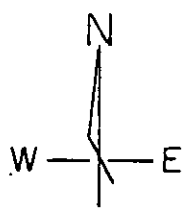

- = THIS CORNER
- ⊙ = IRON WITNESS MONUMENT
- = OTHER REFERENCE

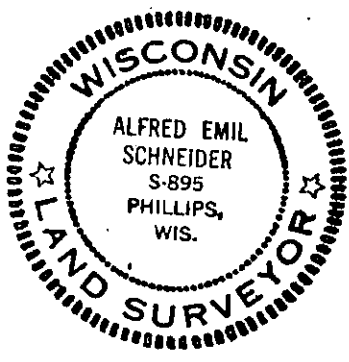
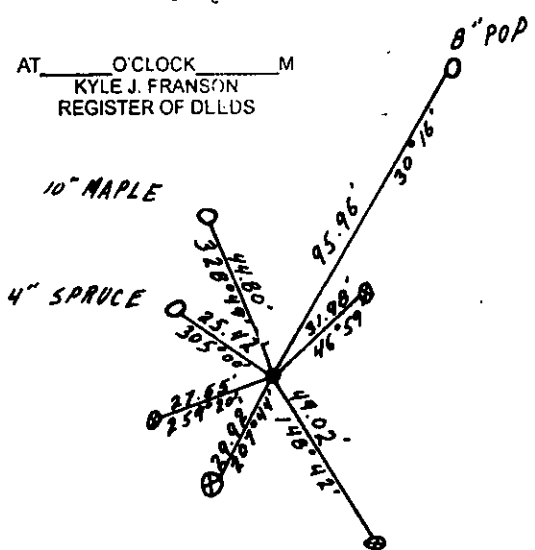

I CERTIFY THAT ON THE 23 DAY OF JULY, 1975, I PERPETUATED THIS CORNER AS SHOWN HEREON AND I HAVE DRAFTED THIS INSTRUMENT. DATED THIS

31 DAY OF July, 1975.

Alfred E. Schneider, LAND SURVEYOR

3603240000

SEQUENCE N3528-E0300

364 R-1

SEAL