

U.S. PUBLIC LAND SURVEY MONUMENT RECORD

Note: This form is intended and designed to fulfill all requirements of Wisconsin Administrative Code, Chapter A-E 5.02, U.S. Public Land Survey Monument Record (3) (a) (b) (c) (d) (e) (f) (g) (h) (i). An additional sheet may be added if necessary to conform with said requirements.

(a) Corner location: Township 36 North

Range 4 East

Town/City/Village Lynne

County Oneida

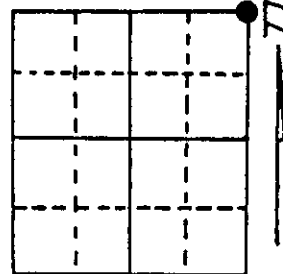

Section 35

(b) (f) (g) (h) Description of monument found at this corner and if it was accepted, state all evidence (material, testimonial, occupational, plats, records, other monuments) used as a basis for accepting. If not accepted or if nothing was found, state evidence used as basis for establishing location. If reestablished through lost corner proportionate methods, indicate all monuments, distances and directions used to establish.

Recovered V.A. Maine's 5" x 5" Cedar post (scribing visible) in rock cairn, also a portion of C.D. Vaugh's post laying beside upright post. Someones 1-1/2" iron pipe with 3" alloy cap (not stamped) beside post. No visible sign of BTs - area was all burned off at time of survey.

Replaced V.A. Maine's post with a 2-1/4" Oneida County Monument.

Original corner established by Edward D. Palmer, Gov't Deputy Surveyor in 1865, from which Maple bears N67W, 16 lks., Birch bears N16E, 11 lks., 10" Hemlock bears S44E, 21 lks. and 9" Cedar bears S33W, 36 lks.

(c) (d) (e) Plan view of corner with ties to at least 4 witness monuments. If in disagreement with previously established corner, show the distances between the two corners and also indicate the ties to the disputed corner.

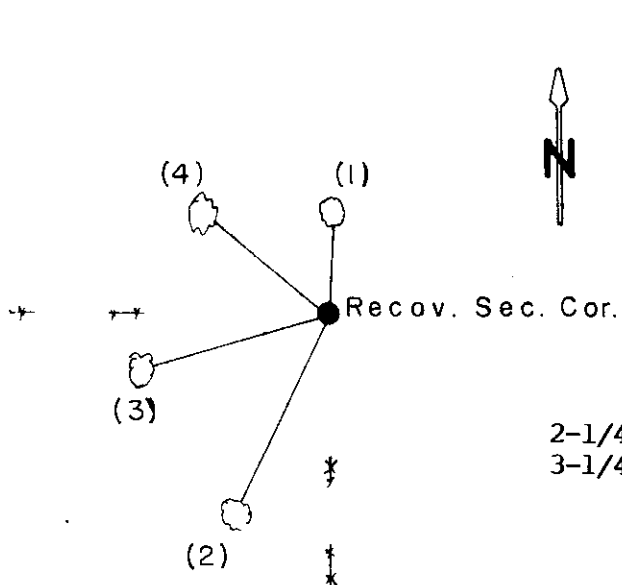

- (1) 4" Elm N 4° E 16.16'
- (2) 5" Red Maple S 26° W 35.28'
- (3) 4" Red Maple S 74° W 31.49'
- (4) 7" Red Maple N 49° W 25.18'

2-1/4" Alum. Oneida Co.
3-1/4" Alloy Cap

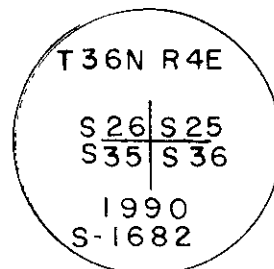

(i) I, Glen Barker
(type or print name) certify that the corner location on this record was determined by me or under my direction and control and that this U.S. Public Land Survey Monument Record is correct and complete to the best of my knowledge and belief.

Glen Barker
Signature Date 11/4/91

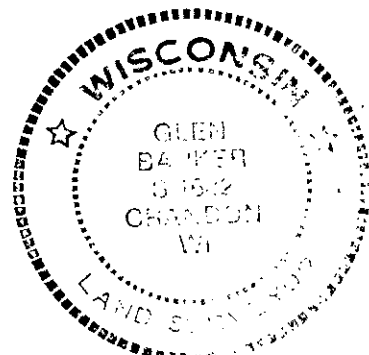

Index No. 21