

# U.S. PUBLIC LAND SURVEY MONUMENT RECORD

**Note:** This form is intended and designed to fulfill all requirements of Wisconsin Administrative Code, Chapter A-E 7.08 U.S. Public Land Survey Monument Record (3) (a) (b) (c) (d) (e) (f) (g) (h) (i). An additional sheet may be added if necessary to conform with said requirements.

(a) Corner location: Township 36 North  
 Range 5 East/West

Town/City/Village Little Rice

County Oneida

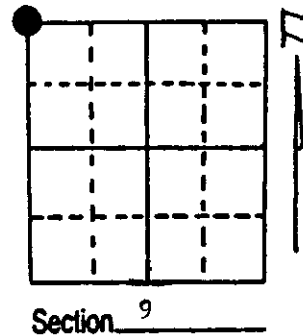

(b) (f) (g) (h) Description of monument found at this corner and if it was accepted, state all evidence (material, testimonial, occupational, plats, records, other monuments) used as a basis for accepting. If not accepted or if nothing was found, state evidence used as basis for establishing location. If reestablished through lost corner proportionate methods, indicate all monuments, distances and directions used to establish. Indicate type of monument found or set and sign post.

6/1863 - Joseph H. Jenkins established this corner. No BTs given in Jenkins notes.

1/15/1935 - A. J. Lytle found original Section Corner Post with notches in perfect state of preservation and two bearing trees with scribing marks:  
 5" Tamarack, S31°E, 21 Links (13.86') 4" Cedar, N26°W, 42 Links (27.72')  
 He made no new BTs. His traverse distance West was 7907.955 feet and South was 5371.74 feet.

2/22/1995 - Milo E. Stefan found a 2" x ?' (assumed 60") aluminum monument marked for corner with BTs. Our traverse gave a distance West of 7907.20' and South 5370.10'. I accept this monument as the Section Corner and restore same.

(c) (d) (e) Plan view of corner with ties to at least 4 witness monuments. If in disagreement with previously established corner, show the distances between the two corners and also indicate the ties to the disputed corner.

- 1) 2" Aluminum Monument
- 2) 6" Tamarack, N48°E, 93.52'
- 3) 5" Tamarack, S79°E, 21.48'
- 4) 6" Tamarack, S11°E, 56.00'
- 5) 4" Tamarack, N73°W, 47.12'
- 6) Plastic Sign Post, North, 1.0'

Distances to nail in side of BTs.  
 Stump blaze scribed "BT".  
 Bearing tree poster placed on each BT.

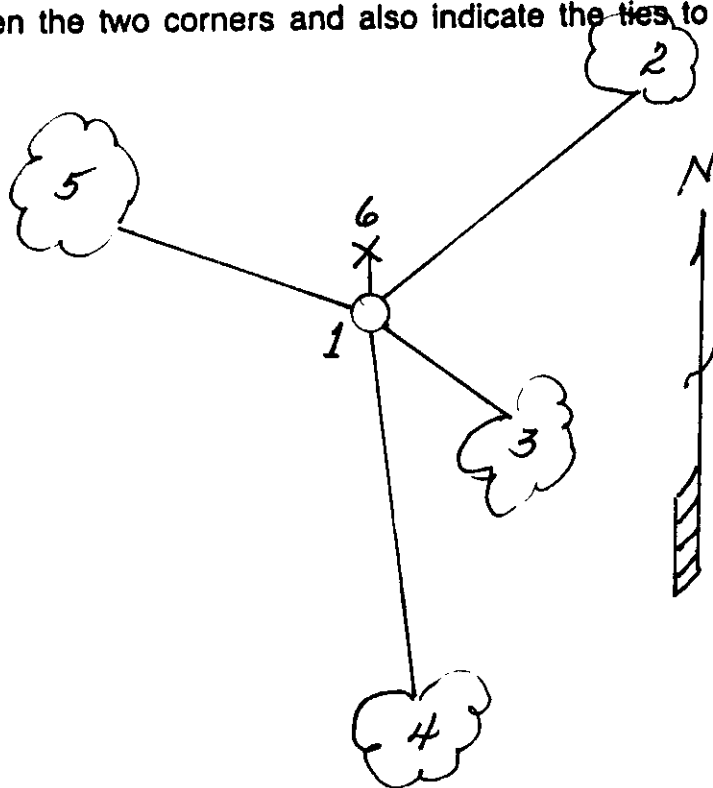

REGISTER OF DEEDS OFFICE  
 ONEIDA COUNTY WIS  
**FILED**  
 MAY 23 1995  
 At \_\_\_\_\_ O'Clock \_\_\_\_\_ M  
**THOMAS H. LEIGHTON**  
 REGISTER OF DEEDS

(i) I, Milo E. Stefan  
 (type or print name) certify that the corner location on this record was determined by me or under my direction and control and that this U.S. Public Land Survey Monument Record is correct and complete to the best of my knowledge and belief.

Milo E. Stefan  
 Signature

May 8,, 1995  
 Date



Index No. E-9

3605050000

# U.S. PUBLIC LAND SURVEY MONUMENT RECORD

Note: This form is intended and designed to fulfill all requirements of Wisconsin Administrative Code, Chapter A-E 7.08 U.S. Public Land Survey Monument Record (3)(a-i).

(a) CORNER LOCATION  
 Cor. of Secs. 4, 5, 8 & 9  
 Township 36 North  
 Range 5 East of the 4th P.M.  
 Town of Little Rice  
 County of Oneida

WISCRS - Oneida County  
 N: 161,081.60 USft  
 E: 144,268.56 USft  
 Datum: NAD 83(2011)  
 GNSS Method: RTN - Direct  
 GNSS Control: WISCORS VRS

	SEC. 5		
	T36N	R5E	

(b) HISTORY OF ORIGINAL CORNER ESTABLISHMENT

Original Surveyor: \_\_\_\_\_ Original Accessories: \_\_\_\_\_  
 Date of Survey Commenced: \_\_\_\_\_ See previous USPLS Monument Record  
 Completed: \_\_\_\_\_

(b)(f)(g)(h) Description of monument found at this corner and if it was accepted, state all evidence (material, testimonial, occupational, plats, records, other monuments) used as a basis for accepting. If not accepted or if nothing was found, state evidence used as basis for establishing location. If re-established through lost corner proportionate methods, indicate all monuments, distances and directions used to establish. Indicate type of monument and sign post found or set.

*This is a perpetuation of a previous USPLS Monument Record by Milo E. Stefan, RLS dated May 8, 1995 and filed in the office of the Oneida County Register of Deeds. A complete history of the corner can be found on the previous monument record. I accept the previous location as a true and faithful perpetuation or reestablishment of the original corner location and further perpetuate it as follows.*

*Sep. 11, 2018: I found and accepted the record monument, a 2-1/2" diam. aluminum pipe with a 3-1/4" diam. Oneida Co. aluminum cap projecting 10" above the bog surface. I found or established accessories as shown below. I set a wood sign post bearing Northeast, 0.9 ft.*

*The coordinate value shown has been verified by at least one of the following methods: 1) comparison to a previously GPS determined published value; 2) the value is the average of two or more GPS observations at a markedly different time; 3) one or more distances were measured back to the GPS observed corner from temporary GPS observed offset locations.*

REGISTER OF DEEDS OFFICE  
 ONEIDA COUNTY  
 FILED

DEC 31 2018

KYLE J. FRANSON  
 REGISTER OF DEEDS

(c)(d)(e) Plan view of corner with ties to at least 4 witness monuments. If in disagreement with previously established corner, show the distances between the two corners and also indicate the ties to the disputed.

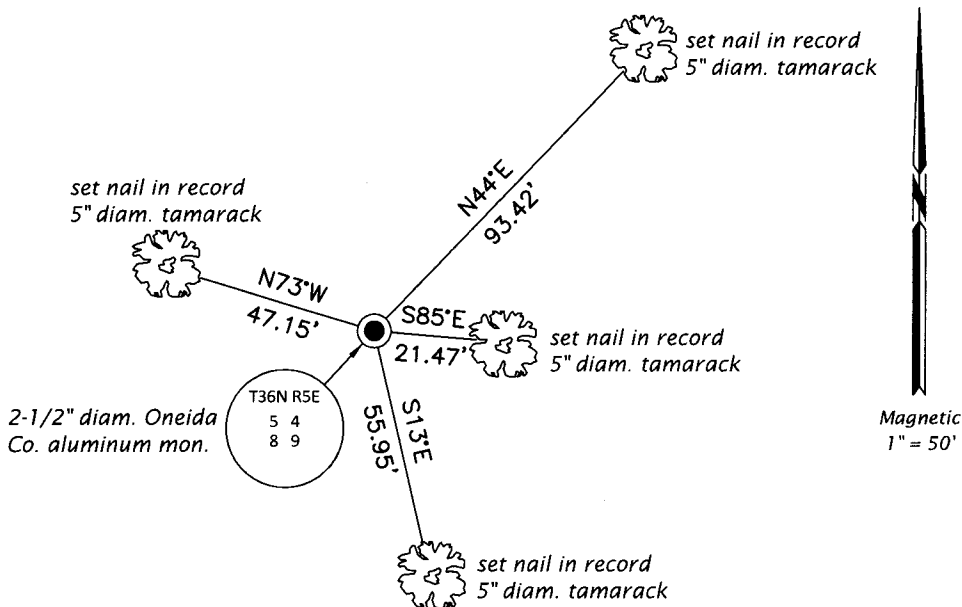

(i) I, Jeffrey W. Austin, Professional Land Surveyor No. S-1885, hereby certify that the corner location on this record was determined by me or under my direction and control and that this U.S. Public Land Survey Monument Record is correct and complete to the best of my knowledge and belief.

\_\_\_\_\_  
 Signature 13 DEC 2018  
Date