

U.S. PUBLIC LAND SURVEY MONUMENT LOCATION RECORD

Recorders Data

CORNER: North 1/4 SECTION: 12 TOWNSHIP 36 NORTH RANGE 6 EAST/WEST

FOR M.C. CORNER INDICATE: NAME OF WATERWAY N/A SECTION LINE N/A

(CITY)(VILLAGE)(TOWN) OF: Nokomis COUNTY OF: Oneida

Description of monument found or placed and all other evidence used as a basis for monument location; including all monuments and related measurements required if the corner location is reestablished by lost corner proportionate methods. Also indicate name of original surveyor, survey date, corner monument set and established bearing trees, witness or reference monuments with ties from available records.

Found and accepted an old 1 1/2" dia. iron pipe with uncapped top 4" below existing gravel roadway surface and flush with older blacktop surface below the latter at this corner location. Also found an old wood post, wood stake and a 3' tall yellow painted 1/2" dia. iron pipe N08°E about 20'.

In 1862, J.H. Jenkins/GLO set a wood post as the corner and marked OBTs, an 18" Py S34°W 70 lks and a 15" Py N55°W 35 lks, all of which are now obliterated.

Maps of 1956-57 Nepco surveys by W. Stuth of Owens-Illinois in 1987, indicate an iron pipe or cap by plat legend at this corner and a W.C. (witness corner) 15' North; the latter now gone.

A corner perpetuation sheet by Scherer/Wis DOT in 1974, filed as L-402 in Oneida County survey records, indicates ties to a spike found in bituminous road surface at this corner location, from a 6" Pj S73°W 88.55', found and noted below, and from a PK nail in a 10' high wood gate post S68°E 28.60', which is now gone. The spike referred to may be the 40d spike I also found in the top center of iron pipe at the corner.

This recovery completed June 4, 1998; there were no witnesses other than passer-bys.

No other corner evidence observed or detected within the roadway intersection area.

Plan view map of monument location with bearing and distance ties to a minimum of four (4) described witness or reference monuments of concrete, natural stone, iron, live bearing trees or equivalent material. If applicable, also show a minimum of two (2) bearing and distance ties to any other monument found and not accepted; including the bearing and distance from the accepted monument. Indicate the basis for bearings of reference ties if not referenced to magnetic north.

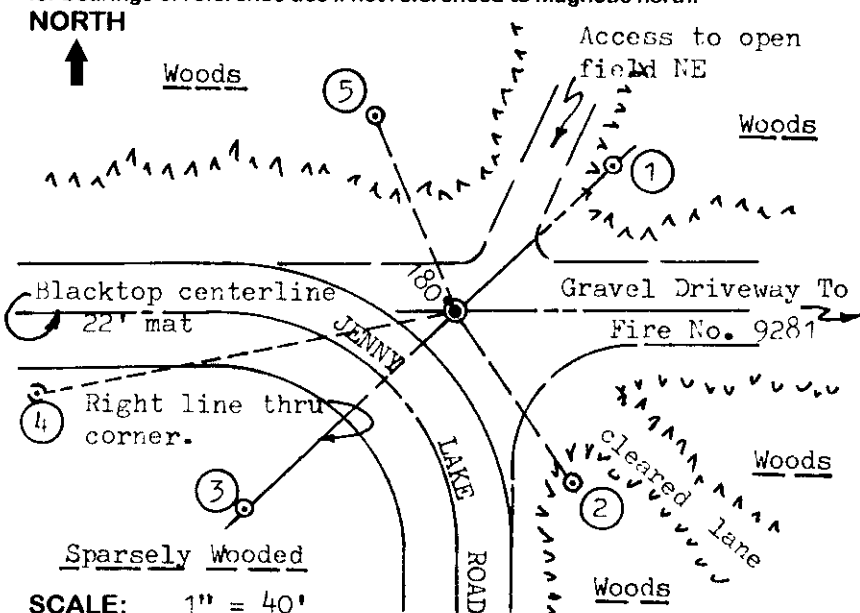

WITNESS MONUMENT TIES:

- ① 1" dia. by 24" long iron pipe set with standard Reference Mark cap in top flush to grade and 1.2' East of 8" Pr center, N47°E 44.55'.
- ② New BT 10" Pr S34°E 43.08'.
- ③ 1" dia. by 24" long iron pipe set with standard Reference Mark cap in top flush to grade, S47°W at 60.79'.
- ④ Old BT by Wis DOT, now 14" Pj with no markings visible, S79°W 89' +/-.
- ⑤ New BT 7 1/2" Pj N22°W 44.20' with BT sign nailed to South face.

Note: Standard white poly 'T' marker post set 6" SW of Witness No. 3.

Unless otherwise indicated, all bearing tree ties are to a .25" dia. by 2.5" long PK nail with a 1.25" dia. steel washer driven into unblazed right face and a .25" dia. by 2.5" long PK nail with a 2" dia. steel washer stamped 'BT' is also driven into unblazed face of bearing tree at DBH; the basis for measured bearings is magnetic to nearest degree and all tie distances are horizontal measure to nearest 1/100th feet.

LAND SURVEYOR CERTIFICATION:

I, William C. Rohde, hereby certify that I am a duly licensed Professional Land Surveyor in Wisconsin, that this USPLS monument location was determined by me or under my direction and control, and that this U.S. Public Land Survey Monument Location Record is true and correct to the best of my knowledge and belief.

William C. Rohde Date: 6-6-98
Signature

		12	

INDEX NO. E 23

SECTION LOCATION MAP

INDEX NO. E 23
3606010020

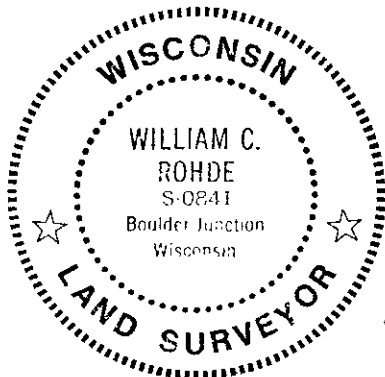

RLS SEAL

SHEET NO. 1 OF 1

This form is intended to fulfill requirements of Chapter A-E 7.08 (3)(a)(b)(c)(d)(e)(f)(g)(h)(i) U.S. Public Land Survey Monument Location Record, Wisconsin Administrative Code. Use reverse side for geodetic location data and/or continuation purposes.