

At _____ O'Clock _____ M
THOMAS H. LEIGHTON

This form is intended to fulfill the requirements of Chapter A-E7.08 (3) of the Wisconsin Public Land Survey Monument Location Record, Wisconsin Administrative Code. Use the reverse side of form for continuation.

U.S. PUBLIC LAND SURVEY MONUMENT LOCATION RECORD

Recorders Data

USPLS CORNER: WEST 1/4 SECTION: 2 TOWNSHIP: 36 NORTH RANGE: 6 EAST
 NAME OF WATERWAY FOR M.C. CORNER: N/A SECTION LINE: N/A
 (CITY)(VILLAGE)(TOWN) OF: NOKOMIS COUNTY OF: ONEIDA

Description of monument found or placed and all other evidence used as the basis for monument location; including monuments and measurements required if the corner location was reestablished by lost corner proportionate methods. Also indicate name of the original surveyor, original survey date and the corner monument, bearing trees, witness or other reference monuments established, including measured bearing and distance ties, from available survey records.

In October 1862, Joseph H. Jenkins/GLO set a wood post as the original corner and noted OBTs: a 12" Pj S21°E 18 links and a 7" Pj N78°W 22 links; all are now obliterated.

In August 1970, Forrest Wincentsen/RLS 155 notes an iron pipe at this corner and BTs: a 6" Pj S51°E 29' and an 8" Pj N06°30'E 40.9' per his field notes on page 25 of Wincentsen Book 1 in Oneida County survey records and also by notation on his Plat of Survey filed as C-597 and dated May 1949; both BTs are now obliterated.

In May 2002, Aero-Metric, Inc. notes a 2" iron pipe found with wood post at this corner per GPS data sheet filed in Oneida County survey records.

On October 6, 2006, I found an old rusty 1.5" dia. iron pipe with uncapped top 6" above grade, a standard 'T' marker post 10" SW and an old 4" dia. x 5' high wood marker post with squared/scribed upper faces and peaked top 12" NNW; I left old iron pipe in place and drove a standard 2" dia. x 30" long aluminum pipe monument with stamped Oneida County cap over it to 12" above grade for new ties noted below.

Corner falls in a Pr plantation about 70' West of an unimproved N/S woods roadway centerline between curves to the West and East; there were no direct witnesses.

Plan view map of monument location with bearing and distance ties to a minimum of four(4) described witness or reference monuments of concrete, natural stone, iron, live bearing trees or equivalent material. If applicable, also show a minimum of two(2) bearing and distance ties to any other monument found and not accepted; including the bearing and distance from the accepted monument.

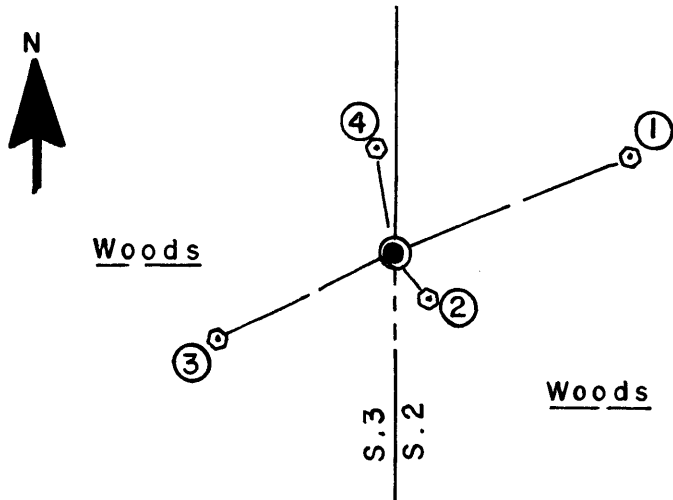

WITNESS MONUMENT TIES:

- ① New 12" Pr BT N67°E 13.22'.
- ② Old 13" Pr BT S38°E 3.09' with an upper blaze shut and lower blaze nearly shut.
- ③ Old 11" Pr BT S63°W 10.06' with an upper blaze shut and lower blaze nearly shut .
- ④ Old 11" Pr BT N10°W 5.45' with an upper blaze shut and lower blaze nearly shut with visible scribing.

I painted old BT blazes and flagged new BT, posts and monument blaze orange.

SCALE: 1"=10'

Unless otherwise indicated, all bearing tree ties are to a .25" dia. by 2.5" long PK nail with a 1.25" dia. steel washer driven into unblazed right face and a .25" dia. by 2.5" long PK nail with a 2" dia. steel washer stamped BT is also driven into unblazed face of bearing tree at DBH; the basis for measured bearings is by compass to nearest degree and all tie distances are measured horizontal by steel tape corrected to nearest 1/100th feet at standard temperature of 68° F.

RLS SEAL:



LAND SURVEYOR CERTIFICATE:

I, William C. Rohde, hereby certify that I am duly licensed as a Professional Land Surveyor in the State of Wisconsin; that this USPLS monument location was determined by me and/or under my direct supervision and control; and that this U.S. Public Land Survey Monument Location Record is true and correct to the best of my knowledge and belief.

Signed: *William C. Rohde*
William C. Rohde RLS 841

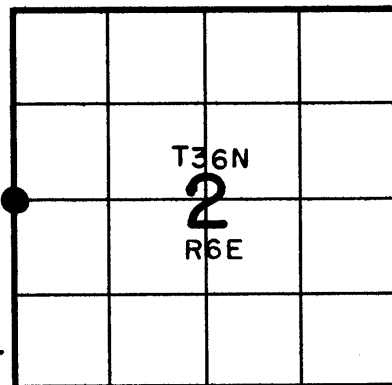

SECTION LOCATION MAP
INDEX NO. C 17

3606032000