

CERTIFIED LAND CORNER RESTORATION

Index No. 7-4

State of Wisconsin } ss.
County of Oneida

History of original corner establishment:
No evidence of any previous corner.

I, Glen Barker, do hereby certify that on the 17th day of January, 1984, I ~~XXXXXX~~ Restab. ~~corner of the~~ E 1/16 corner of Sections 7 & 18 Township 36, North, Range 6 East, Fourth Principal Meridian, as described hereon; and that from this evidence I established a new monument and accessories as described hereon to perpetuate the original location of this corner.

Resident witnesses:

J. Clafin - RLS

H. Wagoner

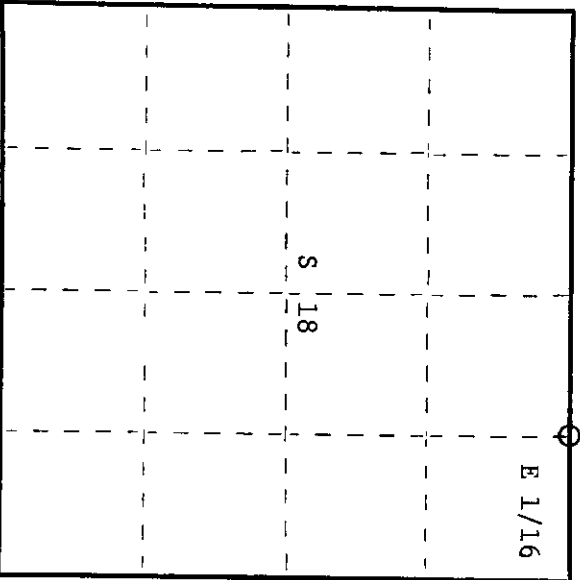
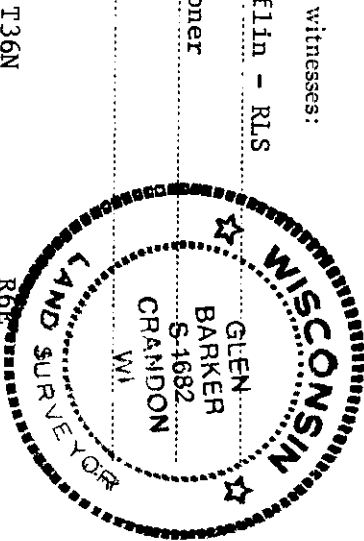

○ = Corner monument restored.

Description of corner evidence found:

- Total distance from section corner 7-8-17-18 to 1/4 corner between section 7 & 18 is 2654.48'
- Set E 1/16 1327.22' intermediate.

Description of monument and accessories I established to perpetuate the original location of this corner.

Set a 1"x18" iron pipe 3.0' south of center line of ~~the~~ Lea Road for true corner 6" below road bed.

Set a 1" iron pipe with 2" diameter alloy cap 36.0' south of true corner for reference corner - cap stamped: S1682 T36N R6E

Monument projects 18" above ground
Marked NBTs to true corner

- Red pine 5" N30W 39.70' E 1/16 S 7 R.C.
- Red pine 8" N49E 71.25' S 18
- N 36 ft. CPI - 1984

Dated at Rhinelander, Wis., this 20th day of February, 1984.

Signature Glen Barker Title Registered Land Surveyor Registration No. S1682
(County Surveyor, Registered Land Surveyor, or other duly authorized official)

Office of Register of Deeds, County of Oneida I hereby certify that the within instrument was filed in this office for record on the 23rd day of May, 1984 at 11:00 o'clock a M.

Dennis Veninger Kuehn
(Register of Deeds)

By: _____ Deputy