

CERTIFIED LAND CORNER RESTORATION

Index No. T-2

State of Wisconsin } ss.  
County of Oneida }

History of original corner establishment:  
Established corner position falls 33.0' west of fence line running south.

I Glen Barker do hereby  
certify that on the 24th day  
of January, 1984, I ~~XXX~~ Estab.  
~~certified~~ the W 1/16  
corner of Sections 7 & 18  
Township 36 North, Range  
6 East, Fourth Principal Meridian,  
as described hereon; and that from this evidence  
I established a new monument and accessories  
as described hereon to perpetuate the original  
location of this corner.

Resident witnesses:  
J. Claflin - RLS  
H. Wagoner

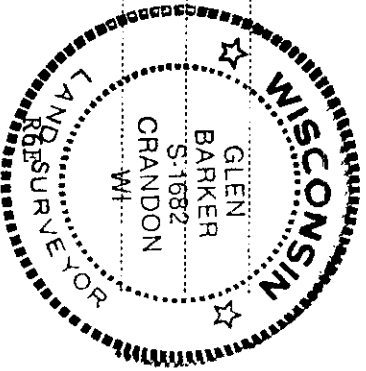

Description of corner evidence found:

- Total distance from section corner 12-13/7-18 T36N R586E to 1/4 corner between sections 7 & 18 is 2153.34'.
- Set W 1/16 on a proportional measurement to the original distance.
- W 1/16 sets 915.79' of section corner and 1237.55' of 1/4 corner.

Description of monument and accessories I established to perpetuate the original location of this corner.

- Set a 1x18" iron pipe in the center line of Lee Road for true corner 6" below road surface. Set a 1" iron pipe with 2" diameter alloy cap 33.0' south for reference corner cap stamped:

Monument projects 12" above ground.			
Marked NBTs to true corner			
Jack pine 6"	N81E	41.79'	W 1/16 S 7 REF.
Jack pine 7"	N51W	55.17'	S 18 Cor.
			N. 33 ft.
			CPI - 1984

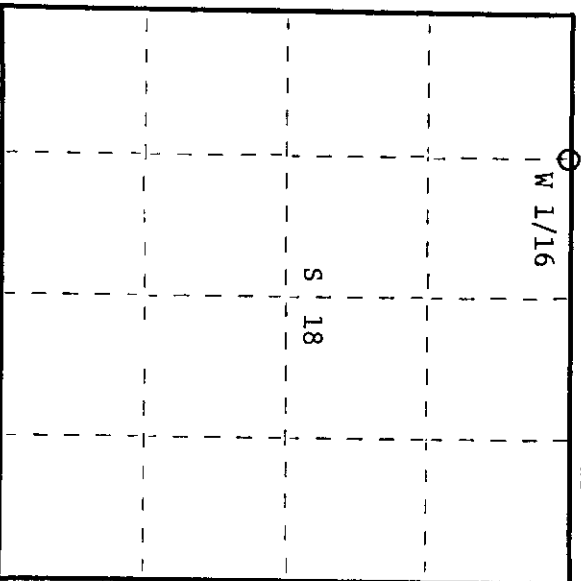

○ = Corner monument restored.

Dated at Rhinelander, Wis., this 20th day of February, 1984

Signature: *Glen Barker* Title: Registered Land Surveyor Registration No. S1682  
(County Surveyor, Registered Land Surveyor, or other duly authorized official)

Office of Register of Deeds, County of Oneida  
Instrument was filed in this office for record on the 23rd day of May, 1984  
at 10:00 o'clock a.m.

*Dorice Savage Tucker*  
(Register of Deeds)

By: \_\_\_\_\_ Deputy

3606070030