

At _____ O'Clock _____ M
THOMAS H. LEIGHTON

This form is intended to fulfill the requirements of Chapter A-E7.08 (REGISTERED U.S. Public Land Survey Monument Location Record, Wisconsin Administrative Code. Use the reverse side of form for continuation.

U.S. PUBLIC LAND SURVEY MONUMENT LOCATION RECORD

Recorders Data

USPLS CORNER: WEST 1/4 SECTION: 9 TOWNSHIP: 36 NORTH RANGE: 6 EAST
 NAME OF WATERWAY FOR M.C. CORNER: N/A SECTION LINE: N/A
~~(CITY)(VILLAGE)(TOWN)~~ OF: NOKOMIS COUNTY OF: ONEIDA

Description of monument found or placed and all other evidence used as the basis for monument location; including monuments and measurements required if the corner location was reestablished by lost corner proportionate methods. Also indicate name of the original surveyor, original survey date and the corner monument, bearing trees, witness or other reference monuments established, including measured bearing and distance ties, from available survey records.

In October 1862, Joseph H. Jenkins/GLO set a wood post as original corner and noted OBTs: an 8" Tamarack N57°W 80 links and a 7" Tamarack S45°E 62 links; all are now obliterated.

Per a 1963 survey, this corner is noted by others on an Owens-Illinois diagram of Section 9 by William H. Stuth/RLS 1418 dated 12/15/86 and per a 1968 survey, this corner is also noted by others on an Owen-Illinois diagram of Section 8 by William H. Stuth/RLS 1418 dated 12/15/86.

On August 11, 2006 I found a "T" steel fence post 39" high, which by careful scalping and probing revealed that it was apparently driven into the soil cavity of and old 4" squared wood marker post found flat on grade nearby. I also found a standard white poly "T" marker post nearby which I pulled and reset 12" West of the corner. I could not pull the steel "T" post so I sawed it off about 12" above grade and drove a standard 2" dia. x 30" long aluminum pipe monument with stamped Oneida County cap over it to 12" above grade for new ties. I left old wood post and sawed off steel T post flat on grade nearby.

Corner falls about 50' East of an unimproved woods roadway where I painted the West face of a 6" Pj to mark walk-in point. I painted old BT blazes and flagged new BTs, post, monument and walk-in West to roadway blaze orange. This is a GPS corner per Oneida County survey records. There were no direct witnesses.

Plan view map of monument location with bearing and distance ties to a minimum of four(4) described witness or reference monuments of concrete, natural stone, iron, live bearing trees or equivalent material. If applicable, also show a minimum of two(2) bearing and distance ties to any other monument found and not accepted; including the bearing and distance from the accepted monument.

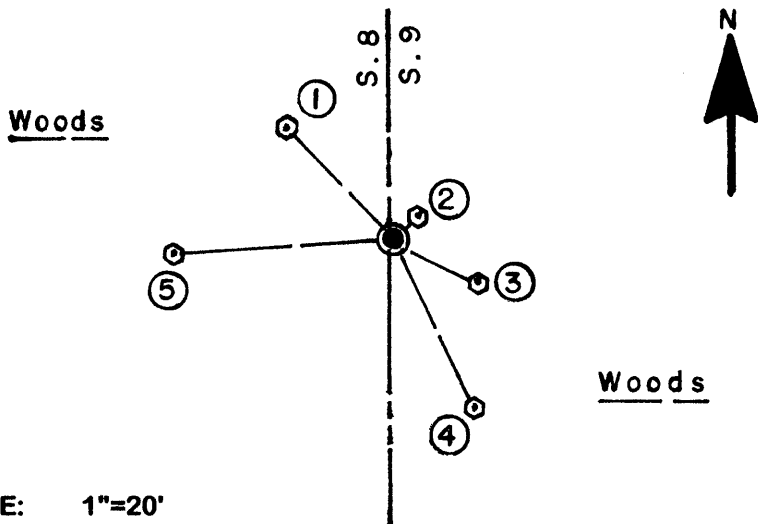

WITNESS MONUMENT TIES:

- ① New 11" Pr BT N44°W 15.99'.
- ② Old 12" Pj BT N44°E 3.38' with both upper & lower face blazes open & scribed but decaying.
- ③ Old 8" Pj BT S63°E 9.78' with upper blaze shut and lower blaze open & scribed.
- ④ New 9" Pr BT S26°E 19.92'.
- ⑤ Probable old 20" BT S86°W 23.04' with very faint upper & lower blaze scars.

SCALE: 1"=20'

Unless otherwise indicated, all bearing tree ties are to a .25" dia. by 2.5" long PK nail with a 1.25" dia. steel washer driven into unblazed right face and a .25" dia. by 2.5" long PK nail with a 2" dia. steel washer stamped BT is also driven into unblazed face of bearing tree at DBH; the basis for measured bearings is by compass to nearest degree and all tie distances are measured horizontal by steel tape corrected to nearest 1/100th feet at standard temperature of 68° F.

RLS SEAL:



LAND SURVEYOR CERTIFICATE:

I, William C. Rohde, hereby certify that I am duly licensed as a Professional Land Surveyor in the State of Wisconsin; that this USPLS monument location was determined by me and/or under my direct supervision and control; and that this U.S. Public Land Survey Monument Location Record is true and correct to the best of my knowledge and belief.

Signed: *William C. Rohde*
William C. Rohde RLS 841

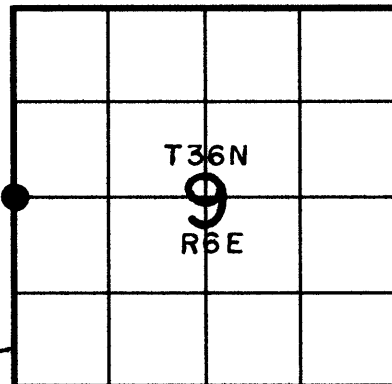

SECTION LOCATION MAP

INDEX NO. G 9
3606082000

Date Signed: February 26, 2006