

# U.S. PUBLIC LAND SURVEY MONUMENT LOCATION RECORD

Recorders Data

CORNER: West 1/4 SECTION: 16 TOWNSHIP 36 NORTH RANGE 6 EAST/WEST

FOR M.C. CORNER INDICATE: NAME OF WATERWAY N/A SECTION LINE N/A

~~(CITY)~~(VILLAGE)(TOWN) OF: Nokomis COUNTY OF: Oneida

Description of monument found or placed and all other evidence used as a basis for monument location; including all monuments and related measurements required if the corner location is reestablished by lost corner proportionate methods. Also indicate name of original surveyor, survey date, corner monument set and established bearing trees, witness or reference monuments with ties from available records.

Found a masonry spike in a small circular blacktop patch in existing roadway with orange ring painted around it by Austin for Oneida County GPS project in progress. I carefully removed the patch with spike to reveal an old 1/2" dia. steel rebar 2 1/2" below blacktop road surface, which I accepted at this corner location. No other metallic indication was detected by electronic locator within the roadway intersection. To aid future recovery, I drove 1/4" dia. by 2 1/2" long PK nails 1 ft. North, South, East and West on right cardinal lines thru the corner center in the blacktop pavement surface. Spike found was above rebar location.

In 1862, Jenkins/GLO set a wood post as the original corner and marked BTs, a 12" Py N74°E 93 lks and a 15" Py N52°W 82 lks, which are all now obliterated.

In 1951, Kirby/Genisot Engineering, indicates a monument in place in center of roadway centerline juncture at this corner location but with no ties, per his Plat of Survey, filed as B-660 in Oneida County survey records.

In 1977, Schmit indicates a solid small circle at this corner location area per his Plat of Survey, filed as B-1307, in Oneida County records; upon recent query, he confirmed that I had found the monument he had used.

This recovery completed June 4, 1998; there were no witnesses other than vehicle drive-bys.

Plan view map of monument location with bearing and distance ties to a minimum of four(4) described witness or reference monuments of concrete, natural stone, iron, live bearing trees or equivalent material. If applicable, also show a minimum of two(2) bearing and distance ties to any other monument found and not accepted; including the bearing and distance from the accepted monument. Indicate the basis for bearings of reference ties if not referenced to magnetic north.

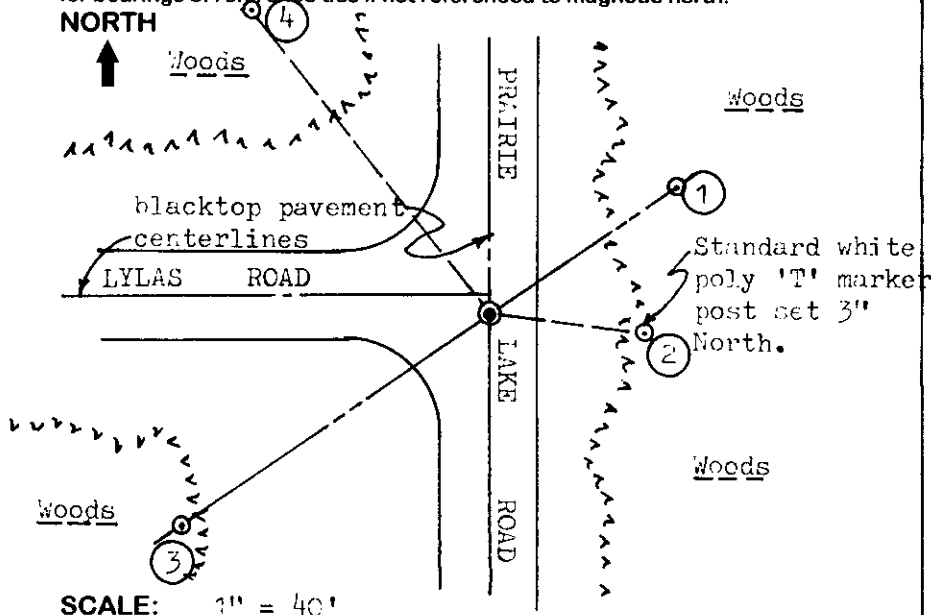

### WITNESS MONUMENT TIES:

- ① 1" dia. by 24" long iron pipe set with standard Reference Mark cap flush with grade N55°E 47.48'.
- ② 1 1/4" dia. older iron pipe found with uncapped top 3" above grade and a red top white plastic guard marker stake 6" East, S83°E 32.95'.
- ③ 1" dia. by 26" long iron pipe set with standard Reference Mark cap flush with grade and 2' East of a 10" Pr, S55°W 78.17'.
- ④ New BT 10" Pr N38°W 81.13' with BT sign nailed to SE face.

SCALE: 1" = 40'

Unless otherwise indicated, all bearing tree ties are to a .25" dia. by 2.5" long PK nail with a 1.25" dia. steel washer driven into unblazed right face and a .25" dia. by 2.5" long PK nail with a 2" dia. steel washer stamped 'BT' is also driven into unblazed face of bearing tree at DBH; the basis for measured bearings is magnetic to nearest degree and all distances are horizontal measure to nearest 1/100th feet.

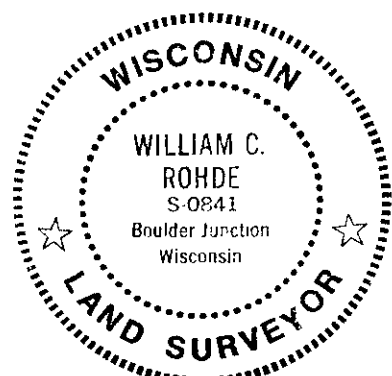

### LAND SURVEYOR CERTIFICATION:

I, William C. Rohde, hereby certify that I am a duly licensed Professional Land Surveyor in Wisconsin, that this USPLS monument location was determined by me or under my direction and control, and that this U.S. Public Land Survey Monument Location Record is true and correct to the best of my knowledge and belief.

William C. Rohde Date: 6/11/98  
Signature

	16		

INDEX NO. L 9

RLS SEAL

SHEET NO. 1 OF 1

This form is intended to fulfill requirements of Chapter A-E 7.08 (3)(a)(b)(c)(d)(e)(f)(g)(h)(i) U.S. Public Land Survey Monument Location Record, Wisconsin Administrative Code. Use reverse side for geodetic location data and/or continuation purposes.

SECTION LOCATION MAP

INDEX NO. L 9  
3606 17 2000