

CERTIFIED LAND CORNER RESTORATION

Index No. N-4

State of Wisconsin } ss.
County of Oneida

History of original corner establishment:
No evidence of any previous corner.

I, Glen Barker, do hereby certify that on the 25th day of January, 1984, I found Estab. ~~of the E 1/16~~

corner of Sections 18 & 19, Township 6 East, North, Range 6 East, Fourth Principal Meridian, as described hereon; and that from this evidence I established a new monument and accessories as described hereon to perpetuate the original location of this corner.

Description of corner evidence found:
Total distance from section corner 17-18-19-20 to 1/4 corner between 18 & 19 is 2643.51'.
Set E 1/16 1321.75' intermediate.

Resident witnesses:

J. Clafin - R.L.S.

H. Wagoner

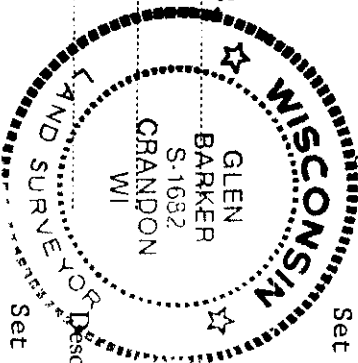

Description of monument and accessories I established to perpetuate the original location of this corner.

Set a 1" iron pipe with 2" diameter alloy cap stamped:

Monument projects 12" above ground.

Marked NBTs

Jack pine 10" S79E 38.75'
Jack pine 6" S47W 7.84'

Scribed 1/16 - B.T.

S1682
T36N R6E

E 1/16 S 18
S 19

CPI - 1984

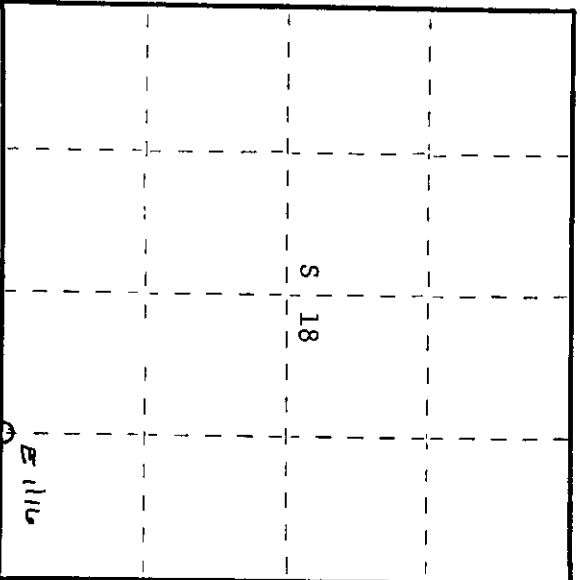

○ = Corner monument restored.

Dated at Oneida, Wis., this 20th day of Feb., 1984.

Signature: *Glen Barker* Title: Registered Land Surveyor Registration No. S1682
(County Surveyor, Registered Land Surveyor, or other duly authorized official)

Office of Register of Deeds, County of Oneida
Instrument was filed in this office for record on the 23rd day of May, 1984
at 1:08 o'clock P.M.

Doris George Kuehn
(Register of Deeds)

By: _____ Deputy

3606180010