

CERTIFIED LAND CORNER RESTORATION

Index No. K-5

State of Wisconsin

County of Oneida } ss.

I Glen Barker, do hereby certify that on the 9th day of February, 1984, I found Estab. ~~corner of~~ the N 1/16 corner of Sections 17 & 18 Township 36 North, Range 6 East, Fourth Principal Meridian, as described hereon; and that from this evidence I established a new monument and accessories as described hereon to perpetuate the original location of this corner.

History of original corner establishment:
Recovered 1" iron pipe N40W 5.0' of established corner.

Resident witnesses:
J. Clafflin - RLS
H. Wagoner

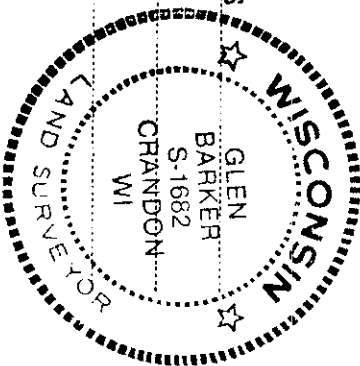

Description of corner evidence found:
Total distance from section corner 7-3-17-18 to 1/4 corner between sections 17 & 18 is 2625.36'.
Set N 1/16 1312.68 intermediate.

Description of monument and accessories I established to perpetuate the original location of this corner.
Set a 1" iron pipe with 2" diameter alloy cap stamped:
Monument projects 18" above ground.

Marked NRTs:
Jack pine 7" S26W 6.15' N 1/16 18 17
Jack pine 6" N59W 11.40'
Scribed 1/16 - B.T. CPI - 1984

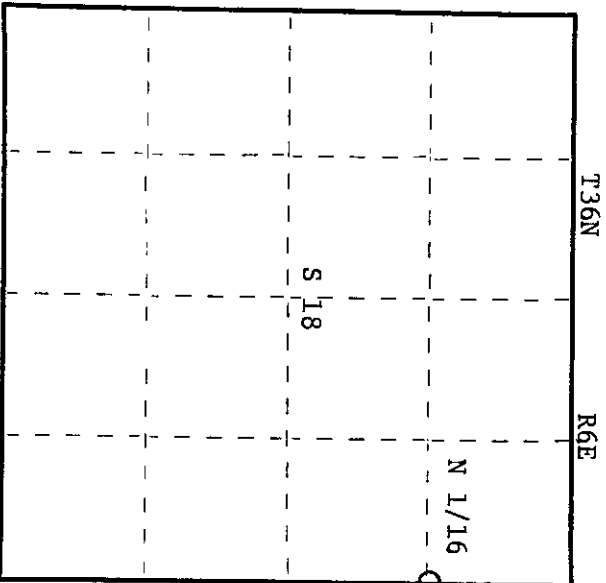

○ = Corner monument restored.

Dated at Rhinelander, Wis., this 20th day of February, 1984.

Signature: *Glen Barker* Title: Registered Land Surveyor Registration No. S1682
(County Surveyor, Registered Land Surveyor or other duly authorized official)

Office of Register of Deeds, County of Oneida, I hereby certify that the within instrument was filed in this office for record on the 23rd day of May, 1984 at 1:00 o'clock P.M.

Donna George Fuchs
(Register of Deeds)

By: Deputy

3606192000