

CERTIFIED LAND CORNER RESTORATION

Index No. P-4

State of Wisconsin

County of Oneida } ss.

History of original corner establishment:
No evidence of any previous corner.

I Glen Barker, do hereby certify that on the 16th day of February, 1984, I found & estab. ~~restored~~ the corner of Section 19 Township 36 North, Range 6 East, Fourth Principal Meridian, as described hereon; and that from this evidence I established a new monument and accessories as described hereon to perpetuate the original location of this corner.

Resident witnesses:
J. Claflin - RLS
H. Wagoner

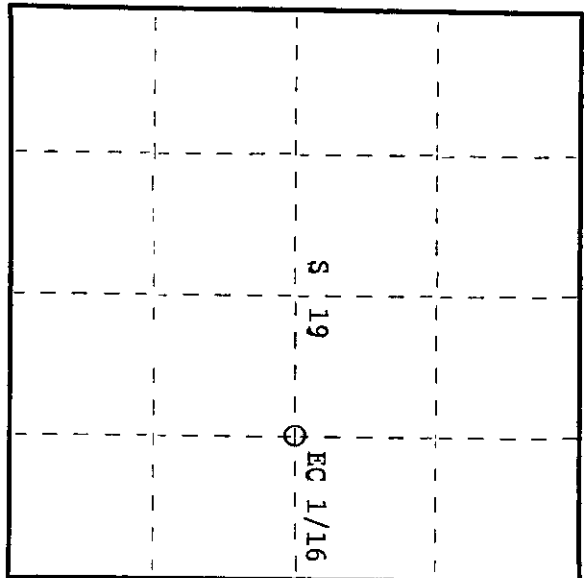
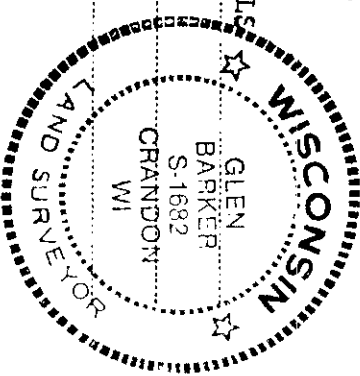

Description of corner evidence found:
Total distance from 1/4 corner between sections 19 & 20 to C 1/4 section 19 is 2630.31'. Set EC 1/16 1315.155' intermediate.

Description of monument and accessories I established to perpetuate the original location of this corner.
Set a 1" iron pipe with 2" diameter alloy cap stamped:
Monument projects 18" above ground. S1682
Marked NBTs T36N R6E

White pine 16" N77W 33.77' EC 1/16 S 19
White pine 12" N81E 41.0' CPI - 1984
Scribed 1/16 - B.T.

Dated at Rhinelander, Wis., this 22nd day of March, 1984

Signature: *Glen Barker* Title: Registered Land Surveyor Registration No. S1682
(County Surveyor, Registered Land Surveyor, or other duly authorized official)
Office of Register of Deeds, County of Oneida
Instrument was filed in this office for record on the 23rd day of May, 1984 at 11:00 o'clock M. I hereby certify that the within

Donna George Tucker
(Register of Deeds)

By: Deputy

3606192010