

CERTIFIED LAND CORNER RESTORATION

Index No. 0-5

State of Wisconsin } ss.
County of Oneida

I Glen Barker, do hereby certify that on the 2nd day of February, 1984, I ~~restored~~ Estab. ~~restored~~ the N 1/16 corner of Sections 19 & 20 Township 6 East, North, Range 6 East, Fourth Principal Meridian,

as described hereon; and that from this evidence I established a new monument and accessories as described hereon to perpetuate the original location of this corner.

Resident witnesses:

J. Clafin - RI
H. Wagoner

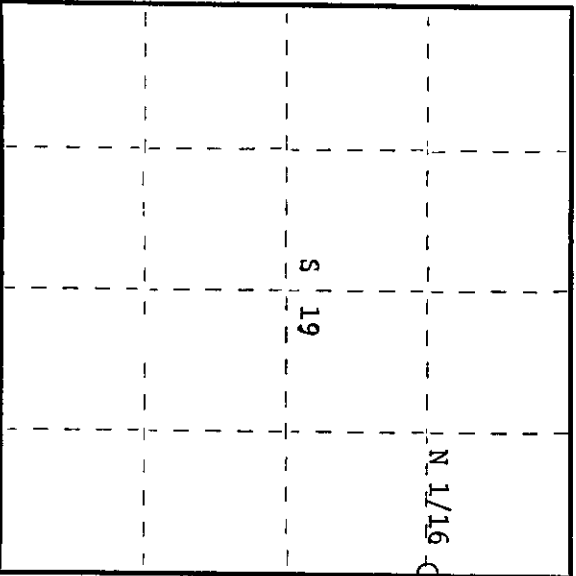
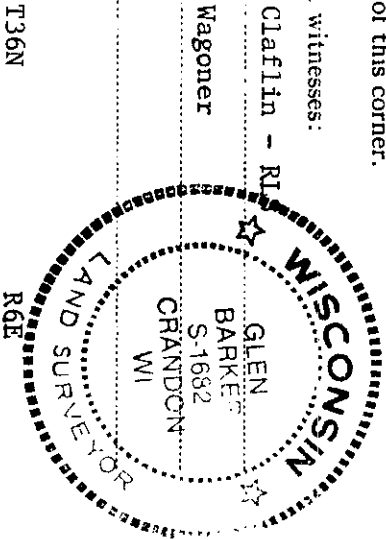

○ = Corner monument restored.

History of original corner establishment:
No evidence of any previous corner.

Description of corner evidence found:

Total distance from section corner 17-18-19-20 to 1/4 corner between Sections 19 & 20 is 2631.08'.
Set N 1/16 1315.54' intermediate.

Description of monument and accessories I established to perpetuate the original location of this corner.

Set a 1" iron pipe with 2" diameter alloy cap stamped:

Monument projects 18" above ground.

Marked NBTs

Black spruce 8"	S89W	88.40'	N 1/16 19 20
Red oak 5"	N48W	101.31'	T36N R6E
Scribed - 1/16 B.T.			CPI - 1984

Dated at Rhinelander, Wis., this 22nd day of March, 1984

Signature: *Glen Barker* Title: Registered Land Surveyor Registration No. S1682
(County Surveyor, Registered Land Surveyor, or other duly authorized official)

Office of Register of Deeds, County of Oneida
Instrument was filed in this office for record on the 23rd day of May, 1984 at 4:08 o'clock P.M.
I hereby certify that the within

Terri George Tucker
(Register of Deeds)

By: Deputy

3606193000