

CERTIFIED LAND CORNER RESTORATION

Index No. Q - 3

State of Wisconsin } ss.
County of Oneida

History of original corner establishment:
Someones 4" squared cedar post

I Glen Barker, do hereby
certify that on the 23rd day
of February, 19 84, I ~~found~~ re-established
~~the~~ NC 1/16
corner of Section 19
Township 36, North, Range
6 East, Fourth Principal Meridian,
as described hereon; and that from this evidence
I established a new monument and accessories
as described hereon to perpetuate the original
location of this corner.

Resident witnesses:
J. Clafin - R.
H. Wagoner

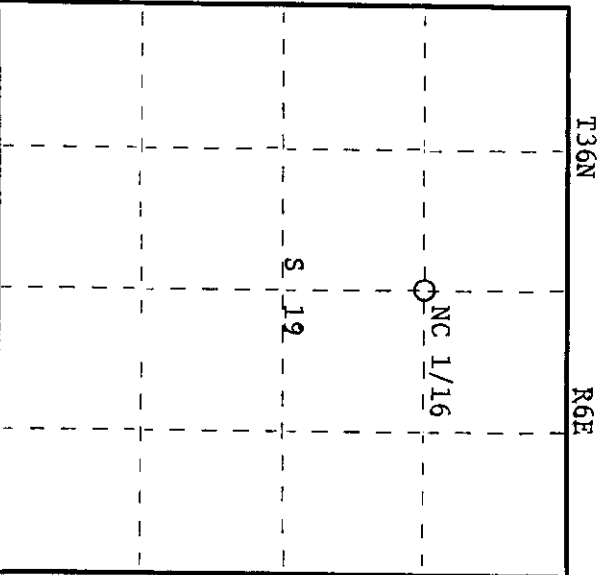
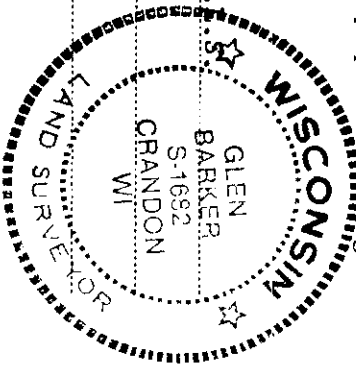

○ = Corner monument restored.

Description of corner evidence found:

Total distance from 1/4 corner between sections 18 & 19 to C 1/4 Section 19 is
2643.70'
Set NC 1/16 1321.85' intermediate
4" squared cedar post bears N61W 4.40 ft. of new position.

Description of monument and accessories I established to perpetuate the original location of this corner.

Set a 1" iron pipe with 2" diameter alloy cap stamped: S1682
Monument projects 18" above ground T36N R6E
Marked NBTs S 19
Tamarack 6" N18W 44.98'
Jack pine 5" N68E 13.93' NC 1/16
Scribed 1/16 - B.T. GPI - 1984

Dated at Rhinelander, Wis., this 22nd day of March, 19 84

Signature Glen Barker Title Registered Land Surveyor Registration No. S1682
(County Surveyor, Registered Land Surveyor, or other duly authorized official)

Office of Register of Deeds, County of Oneida, I hereby certify that the within
instrument was filed in this office for record on the 23rd day of May, 19 84
at 11:08 o'clock A. M.

Tonia George Kuehn
(Register of Deeds)

By: _____ Deputy

3606193020