

CERTIFIED LAND CORNER RESTORATION

Index No. R-8

State of Wisconsin }
County of Oneida } ss.

History of original corner establishment:
An iron rod 1.55' west of new position.

I, Glen Barker, do hereby certify that on the 4th day of March, 1984, I found ~~restored~~ established the E 1/16 corner of Sections 20 & 29 Township 36 North, Range 6 East, Fourth Principal Meridian, as described hereon; and that from this evidence I established a new monument and accessories as described hereon to perpetuate the original location of this corner.

Resident witnesses:

J. Clafin, Reg. Land Surveyor
H. Wagoner

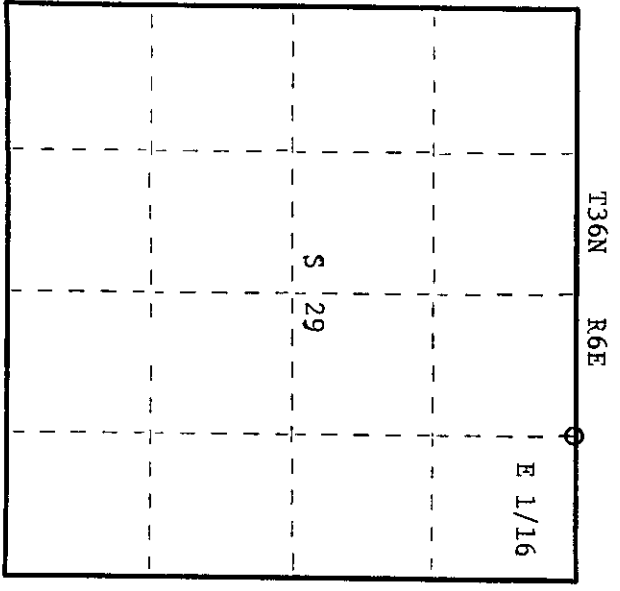
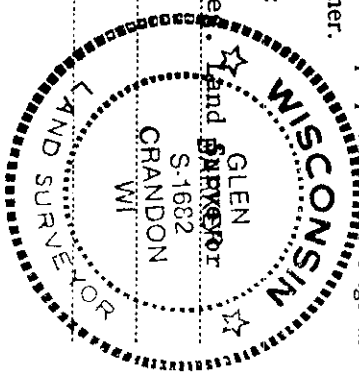

○ = Corner monument restored.

Description of corner evidence found:

Total distance from section corner 20-21-28-29 to 1/4 corner between sections 20 & 29 is 2506.43'.
Set E 1/16 1253.215' intermediate.

Description of monument and accessories I established to perpetuate the original location of this corner.

Set a railroad spike in centerline of Prairie Rapids Road for true corner.
Set a 1" iron pipe with 2" diameter alloy cap for reference corner 33.0' south of true corner - cap stamped:

Marked NBTs:
Red Pine 8" N9°W 59.46'
Red Pine 7" N40E 54.40'
scribed 1/16-B.T.

S1682
T36N R6E
E 1/16 S+20 Ref.
S+29 Cor.
N 33 ft.
CPI - 1984

Dated at Rhineland, Wis., this 19th day of April, 1983

Signature Glen Barker Title Registered Land Surveyor Registration No. 1682
(County Surveyor, Registered Land Surveyor, or other duly authorized official)

Office of Register of Deeds, County of Oneida, I hereby certify that the within instrument was filed in this office for record on the 23rd day of May, 1984 at 11:58 o'clock a. M.

Doris Tenage Kuehn
(Register of Deeds)

By: _____ Deputy