

CERTIFIED LAND CORNER RESTORATION

Index No. **Q-8**

State of Wisconsin }
County of Oneida } ss.

I Glen Barker do hereby certify that on the 18th day of April 19 84, I ~~restored~~ re-established the SE 1/16 corner of Section 20

Township 35 North, Range 6 East, Fourth Principal Meridian,

as described hereon; and that from this evidence I established a new monument and accessories as described hereon to perpetuate the original location of this corner.

Resident witnesses:

Norman Spiess
H. Wagoner

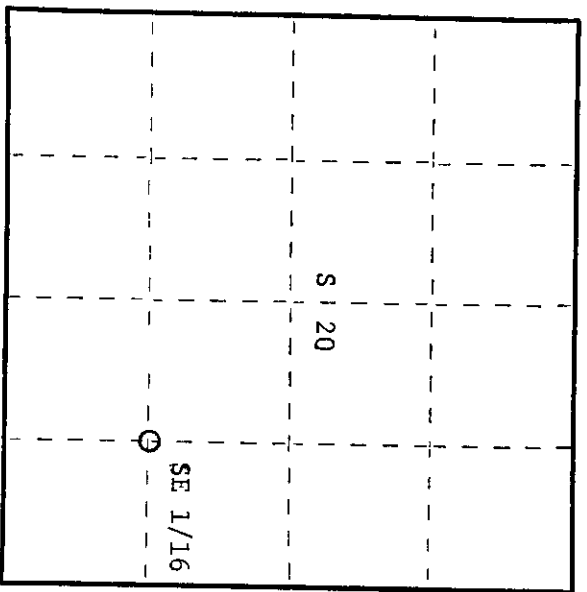
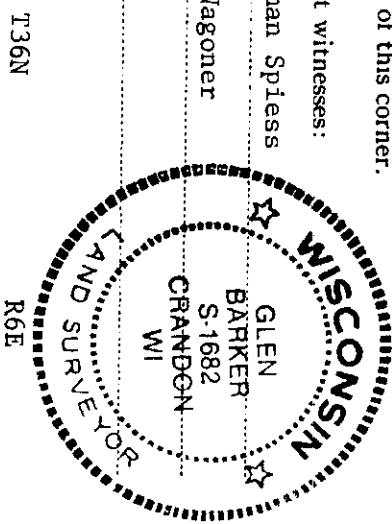

○ = Corner monument restored.

History of original corner establishment:
No evidence of any previous corner.

Description of corner evidence found:

Corner established by subdivision of the SE 1/4 Section 20, SE 1/16 sets 1276.44' of SC 1/16 and 1327.23 of EC 1/16.

Description of monument and accessories I established to perpetuate the original location of this corner.

- Set a 1" iron pipe with 2" diameter alloy cap stamped S1682
- Monument projects 18" above ground. T36N R6E
- Marked NBTs
- Red pine 8" N20E 4.75'
- Red pine 7" S78W 16.76'
- 1/16 - B.T. SE 1/16
- CPI - 1984

Dated at Rhinelander, Wis., this 17th day of May, 19 84

Signature Glen Barker Title Registered Land Surveyor Registration No. 1682
(County Surveyor, Registered Land Surveyor, or other duly authorized official)

Office of Register of Deeds, County of Oneida, I hereby certify that the within instrument was filed in this office for record on the 23rd day of May, 19 84 at 1:00 o'clock P.M.

Dennis George Fischer
(Register of Deeds)

By _____ Deputy

3606201010