

U.S. PUBLIC LAND SURVEY MONUMENT RECORD

Note: This form is intended and designed to fulfill all requirements of Wisconsin Administrative Code, Chapter A-E 7.08 U.S. Public Land Survey Monument Record (3) (a) (b) (c) (d) (e) (f) (g) (h) (i). An additional sheet may be added if necessary to conform with said requirements.

(a) Corner location: Township 36 North
 Range 6 East/West

Town/ Nokomis

County Oneida

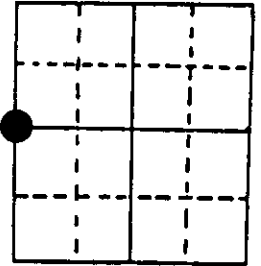

Section 22

(b) (f) (g) (h) Description of monument found at this corner and if it was accepted, state all evidence (material, testimonial, occupational, plats, records, other monuments) used as a basis for accepting. If not accepted or if nothing was found, state evidence used as basis for establishing location. If reestablished through lost corner proportionate methods, indicate all monuments, distances and directions used to establish. Indicate type of monument found or set and sign post.

Oct. 1862, Orig. cor. estab. by Joseph H. Jenkins, North between 21 & 22..... 40.00 set 1/4 sec. post to Sections 21 & 22, B.T.s, Y. Pine 20 N 54° E 25 & Y. Pine 20 N 48° W 17.

Dec. 1903, D.H. Vaughan, at this corner found NW tree down, cut it off, turned it over and found marks O.K., Ira Smith was with him. He also found stump of N.E. tree. Set post and made new bearing, W. Pine 20 S 46° E 88 links. Remarked original stump.

Feb. 1978, I found a 2" x 2" x 1/4" angle iron for the corner in the centre-line of Abe Road.

Sep. 1991, I replaced the angle iron with a 2" x 30" Oneida County Capped Monument for the corner and witnessed it as shown below.

(c) (d) (e) Plan view of corner with ties to at least 4 witness monuments. If in disagreement with previously established corner, show the distances between the two corners and also indicate the ties to the disputed corner.

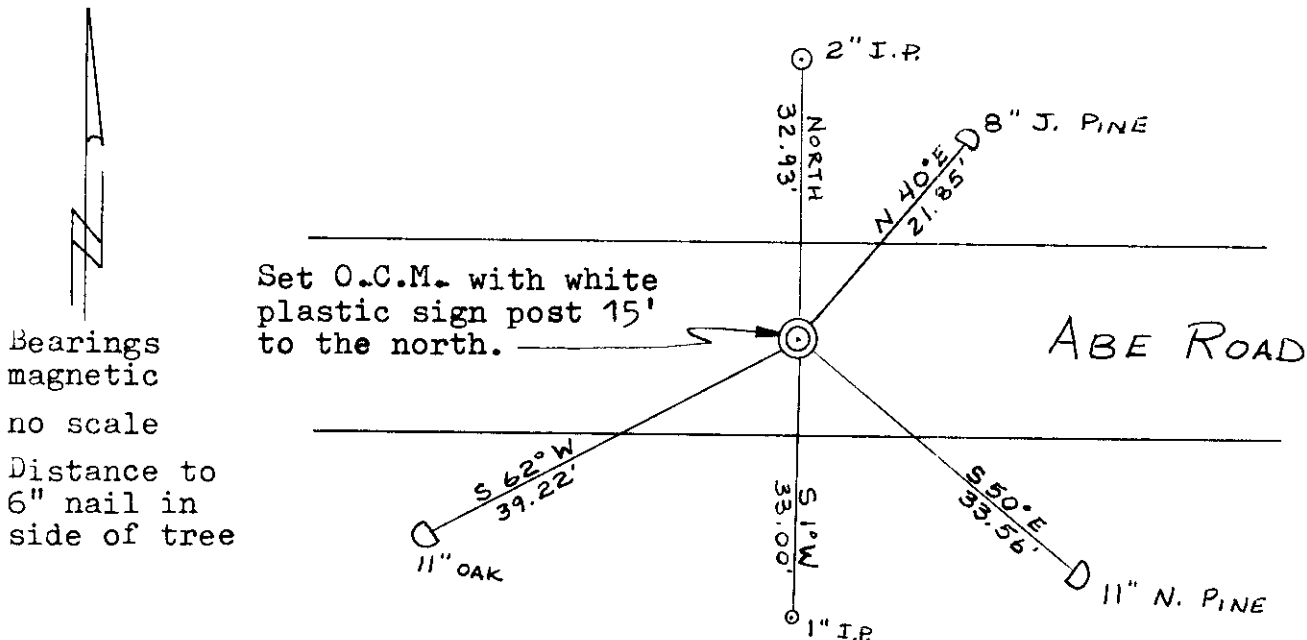

Bearings magnetic
 no scale
 Distance to 6" nail in side of tree

(i) I, Lester J. Schmit R.L.S. 1192
 (type or print name) certify that the corner location on this record was determined by me or under my direction and control and that this U.S. Public Land Survey Monument Record is correct and complete to the best of my knowledge and belief.

Lester J. Schmit 14 Oct 91
 Signature Date



Stamp
 3606212000

Index No. P-13