

State of Wisconsin }
 County of Oneida } ss.

I, Glen Barker, do hereby certify that on the 5th day of March, 1984, I ~~have~~ established the SW 1/16 corner of Section 29 Township 36 North, Range 6 East, Fourth Principal Meridian, as described hereon; and that from this evidence I established a new monument and accessories as described hereon to perpetuate the original location of this corner.

Resident witnesses:

J. Clafin, R6E Land Surveyor
H. Wagoner
S. 1682
CRANDON WI

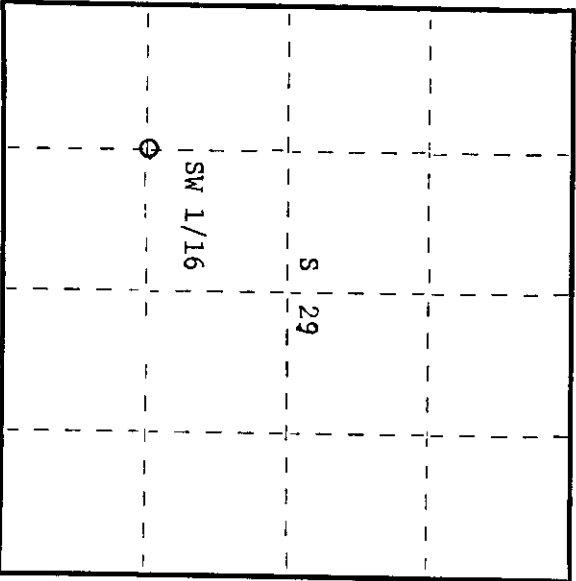
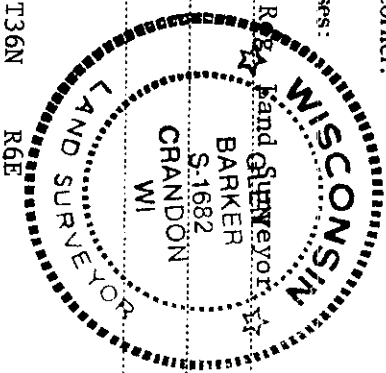

○ = Corner monument restored.

CERTIFIED LAND CORNER RESTORATION

Index No. U-6

History of original corner establishment:

Old fence corner bears N14W 21.53' of monument.

Description of corner evidence found:

Corner established by subdivision of the SW 1/4 section 29. SW 1/16 sets 1331.22' of WC 1/16 and 1326.48' of SC 1/16.

Description of monument and accessories I established to perpetuate the original location of this corner.

Set a 1" iron pipe with 2" diameter alloy cap stamped:
 Monument projects 18" above ground.
 Marked NBTs:

Jack Pine 7" South 14.17'
 Jack Pine 10" East 32.85'
 scribed 1/16-B.T.

S1682
 T36N R6E
 SW 1/16 S 29
 CPI - 1984

Dated at Rhineland, Wis., this 19th day of April, 1984

Signature Glen Barker Title Registered Land Surveyor Registration No. 1682
 (County Surveyor, Registered Land Surveyor, or other duly authorized official)

Office of Register of Deeds, County of Oneida
 Instrument was filed in this office for record on the 23rd day of May, 1984
 at 11:00 o'clock A.M. I hereby certify that the within

Doris Verage Fuesler
 (Register of Deeds)

By: _____ Deputy

3606291030