

CERTIFIED LAND CORNER RESTORATION

Index No. 9-7

State of Wisconsin }  
County of Oneida } ss.

I Glen Barker do hereby certify that on the 2nd day of March 19 83, I ~~restored~~ re-established the NC 1/16 corner of Section 29 Township 36 North, Range 6 East, Fourth Principal Meridian, as described hereon; and that from this evidence I established a new monument and accessories as described hereon to perpetuate the original location of this corner.

Resident witnesses:  
J. Claflin - RLS  
H. Wagoner

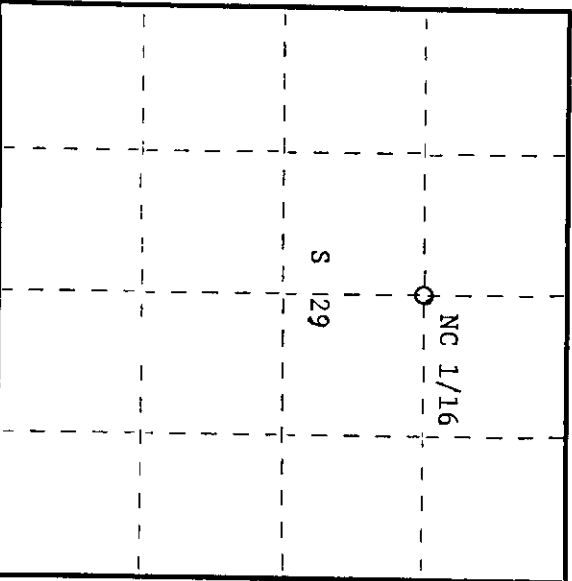
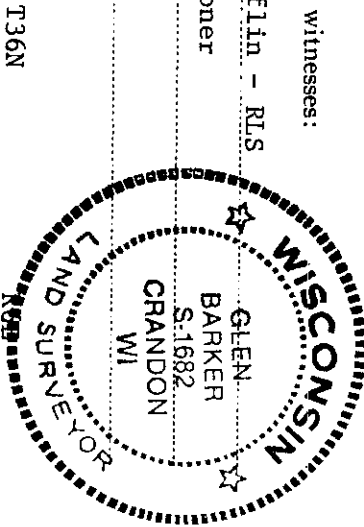

○ = Corner monument restored.

History of original corner establishment:

3 1/2" iron pipe for reference monument west 28.38' of true corner.

Description of corner evidence found:

Total distance from 1/4 corner between sections 20 & 29 to C 1/4 section 29 is 2672.73'.  
Set NC 1/16 1336.365' intermediate.

Description of monument and accessories I established to perpetuate the original location of this corner.  
Set a railroad spike in center line of Lee Road for true corner. Set a 1" iron pipe with 2" diameter alloy cap 33.0' west of true corner for reference monument. Cap stamped: Monument projects 18" above ground.

Marked NBT to true corner  
Jack pine 6" N53W 40.25' S1682 T36N R6E  
Jack pine 10" S38W 46.58' S 29 REF. Cor. NC 1/16  
Scribed 1/16 - BT E. 33 Ft. CPI - 1984

Dated at Rhinelander, Wis., this 19th day of April, 19 84.  
Signature: Glen Barker Title: Registered Land Surveyor Registration No. 1682  
(County Surveyor, Registered Land Surveyor, or other duly authorized official)  
Office of Register of Deeds, County of Dodge, I hereby certify that the within instrument was filed in this office for record on the 23rd day of May, 19 84 at 11:50 o'clock A. M.

Doris Tenage Fuchs  
(Register of Deeds)