

CERTIFIED LAND CORNER RESTORATION

Index No. 1-2

State of Wisconsin } ss.
County of Oneida }

I Glen Barker, do hereby certify that on the 8th day of December, 1983, I ~~restored~~ Estab. ~~corner of~~ the W 1/16 corner of Sections 30 & 31 Township 36 North, Range 6 East, Fourth Principal Meridian, as described hereon; and that from this evidence I established a new monument and accessories as described hereon to perpetuate the original location of this corner.

History of original corner establishment:
No evidence of any previous corner.

Description of corner evidence found:
Total distance from section corner 25-36/30-31 T36N R5 & 6E to previously established 1/4 corner between sections 30 & 31 is 2485.13'. On a proportional measurement to the original survey with a distance of 2465.76'. Set W 1/16 1154.76' of section corner and 1330.37' of 1/4 corner and on a straight line between the two.

Resident witnesses:

J. Claflin - RLS
H. Wagoner

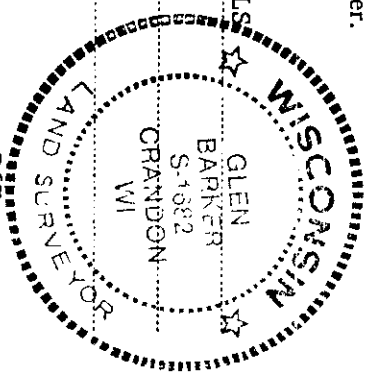

T36N R6E

Description of monument and accessories I established to perpetuate the original location of this corner.
Set a rail road spike in C.T.H. "Y" for true corner. Set a 1" iron pipe with 2" diameter alloy cap 50.0' north of true corner for reference corner. Cap stamped:

Marked NBTs to true corner:
Red pine 6" N36W 67.42' T36N R6E 1682
Red pine 6" N34E 65.60' W 1/16 S30 REF S31 Cor. S.50. Ft. GPI - 1983

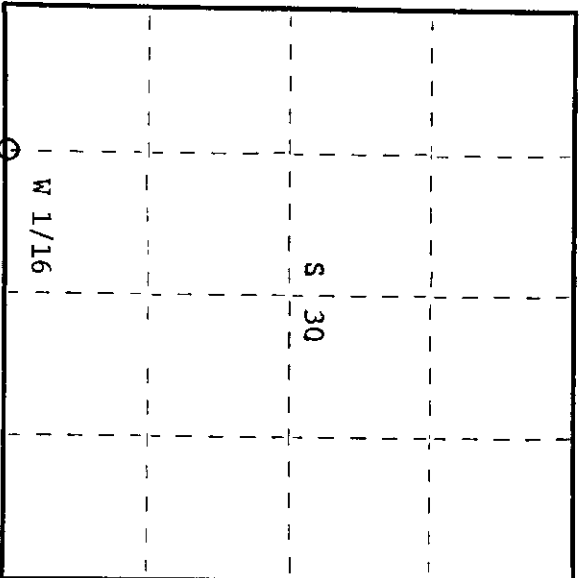

○ = Corner monument restored.

Dated at Rhinelander, Wis., this 13th day of February, 1984

Signature: *Glen Barker* Title: Registered Land Surveyor Registration No. S1682
(County Surveyor, Registered Land Surveyor, or other duly authorized official)

Office of Register of Deeds, County of Oneida
Instrument was filed in this office for record on the 23rd day of May, 1984 at 11:00 o'clock A.M.

Doris George Kuehn
(Register of Deeds)

By: _____ Deputy

3606 30 000

U.S. PUBLIC LAND SURVEY MONUMENT RECORD

Note: This form is intended and designed to fulfill all requirements of Wisconsin Administrative Code, Chapter A-E 7.08 U.S. Public Land Survey Monument Record (3) (a) (b) (c) (d) (e) (f) (g) (h) (i). An additional sheet may be added if necessary to conform with said requirements.

(a) Corner location: Township 36 North
 Range 6 East/West

COR ID
 43606300030

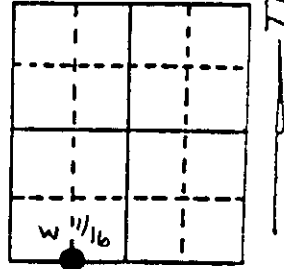

Section 30

Town/City/Village NOKOMIS
 County ONEIDA

(b) (f) (g) (h) Description of monument found at this corner and if it was accepted, state all evidence (material, testimonial, occupational, plats, records, other monuments) used as a basis for accepting. If not accepted or if nothing was found, state evidence used as basis for establishing location. If reestablished through lost corner proportionate methods, indicate all monuments, distances and directions used to establish. Indicate type of monument found or set and sign post.

RAILROAD SPIKE FOUND, SET BY GLEN BARKER 5-1682 IN 1983

BT^S FOUND

6" RED PINE N36°W, 67.42 FT. (REC. 67.32 FT.)
 6" RED PINE N34°E, 65.50 FT. (65.60 FT.)

REF. MON. 1" DIA. I.P. 2" DIA. ALLOY TABLET NORTH 50 FT., STAMPED

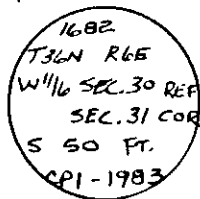

This corner was referenced out in advance of road construction as an act of preserving survey evidence. This corner has not been tested for its accuracy during the course of this preservation and it is recommended that the corner be evaluated for its validity by those using it.

(c) (d) (e) Plan view of corner with ties to at least 4 witness monuments. If in disagreement with previously established corner, show the distances between the two corners and also indicate the ties to the disputed corner.

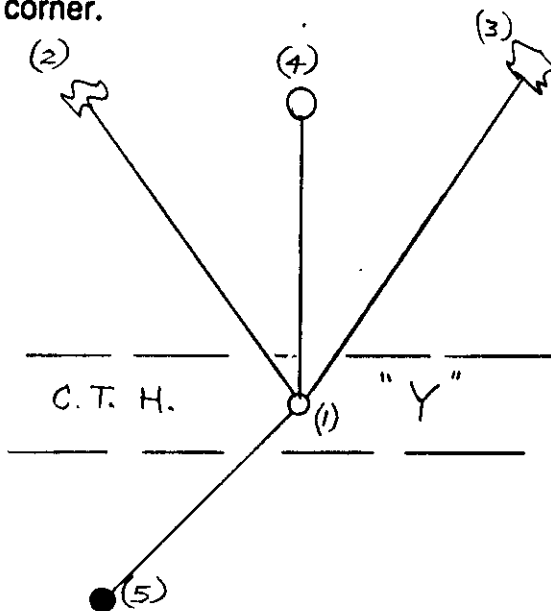

- (1) RAILROAD SPIKE FOUND
- (2) NAIL IN 6" R. PINE N36°W, 67.32 FT. (REC. 67.42)
- (3) NAIL IN 6" R. PINE N34°E, 65.50 FT. (65.60)
- (4) REF. MON. NORTH 49.95 FT. (50 FT.)
- (5) 3/4" DIA. IRON ROD, SET S45°W, 60.00 FT.

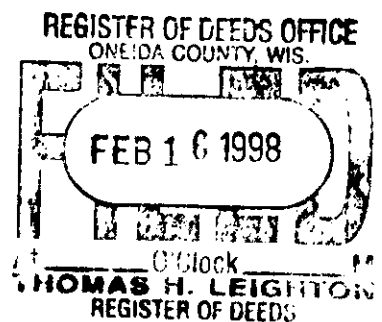

(i) I, DENNIS B. ROBERTS
 (type or print name) certify that the corner location on this record was determined by me or under my direction and control and that this U.S. Public Land Survey Monument Record is correct and complete to the best of my knowledge and belief.

Dennis B. Roberts 12-03-97
 Signature Date



Index No. V

U.S. PUBLIC LAND SURVEY MONUMENT RECORD

Note: This form is intended and designed to fulfill all requirements of Wisconsin Administrative Code, Chapter A-E 7.08 U.S. Public Land Survey Monument Record (3) (a) (b) (c) (d) (e) (f) (g) (h) (i). An additional sheet may be added if necessary to conform with said requirements.

(a) CORNER LOCATION: WISCORS - Oneida County
 W 1/16 Cor. of Secs. 30 & 31 N: 140,112.70 USft
 Township 36 North E: 166,729.36 USft
 Range 6 East of the 4th P.M. Datum: NAD 1983(2011)
 Town of Nokomis County of Oneida

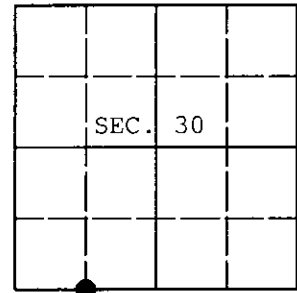

(b) HISTORY OF ORIGINAL CORNER ESTABLISHMENT

Original Surveyor: _____ Original Accessories: _____
 Date of Survey: Commenced: _____
 Completed: _____

(b) (f) (g) (h) Description of monument found at this corner and if it was accepted, state all evidence (material, testimonial, occupational, plats, records, other monuments) used as a basis for accepting. If not accepted or if nothing was found, state evidence used as basis for establishing location. If re-established through lost corner proportionate methods, indicate all monuments, distances and directions used to establish. Indicate type of monument and sign post found or set.

This is a perpetuation of a previous USPLS Monument Record by Dennis B. Roberts, RLS dated December 3, 1997 and filed in the office of the Oneida County Register of Deeds. A complete history of the corner can be found on the previous monument record. I accept the previous location as a true and faithful perpetuation or reestablishment of the original corner location and further perpetuate it as follows.

June 27, 2013: Prior to road construction, I found and accepted the record monument, a railroad spike 2 ft. South of the centerline of County Highway Y. I performed a GPS observation referenced to the WISCORS GNSS Network. I found or established accessories as shown below.

August 8, 2015: Following road construction, I returned and set a cotton picker spindle at the corner point from the reference monuments established previously. I performed a second GPS observation referenced to the WISCORS GNSS Network. The coordinates shown are the mean of the two observations that differed by 0.07 ft.

(c) (d) (e) Plan view of corner with ties to at least 4 witness monuments. If in disagreement with previously established corner, show the distances between the two corners and also indicate the ties to the disputed.

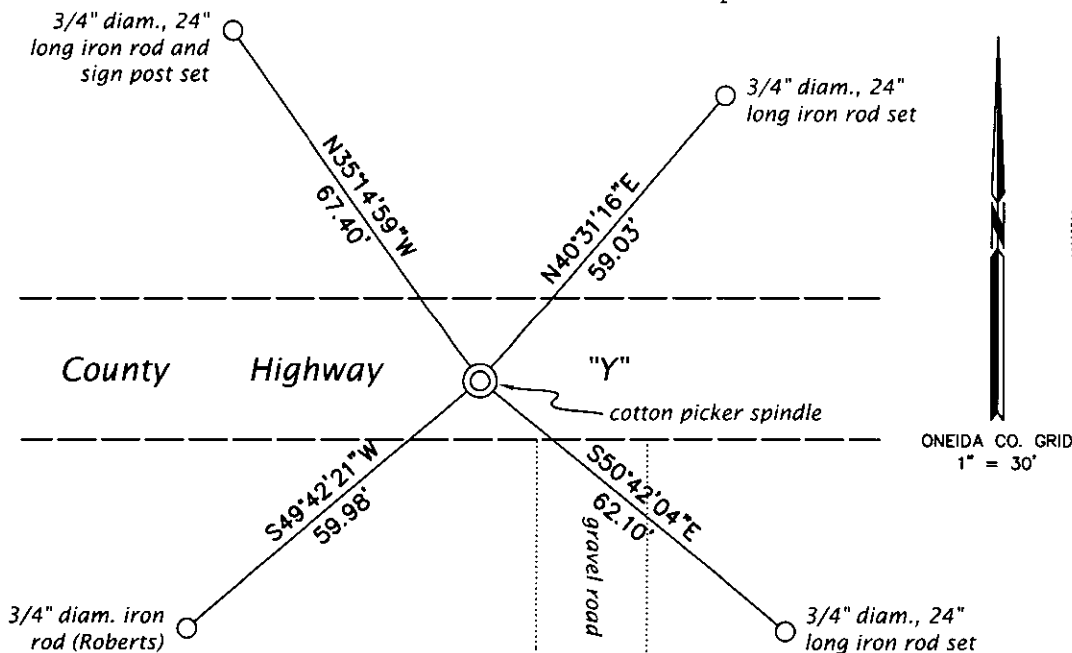

REGISTER OF DEEDS OFFICE:
 ONEIDA COUNTY
 FILED

OCT 15 2015

AT _____ O'CLOCK _____ M
 KYLE J. FRANSON
 REGISTER OF DEEDS

(i) I, Jeffrey W. Austin, Professional Land Surveyor No. S-1885, hereby certify that the corner location on this record was determined by me or under my direction and control and that this U.S. Public Land Survey Monument Record is correct and complete to the best of my knowledge and belief.

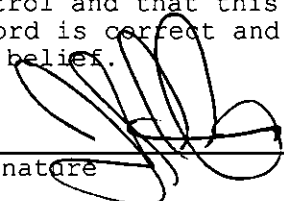

 Signature

OCT. 11, 2015

 Date