

CERTIFIED LAND CORNER RESTORATION

Index No. U-4

State of Wisconsin

County of Oneida } ss.

History of original corner establishment:
No evidence of any previous corner

I Glen Barker do hereby certify that on the 16th day of December, 1983, IXSHEKA Estab.

~~xxxxxxx~~ of the SE 1/16 corner of Section 30 Township 36 North, Range 6 East, Fourth Principal Meridian, as described hereon; and that from this evidence I established a new monument and accessories as described hereon to perpetuate the original location of this corner.

Description of corner evidence found:
Corner established by subdivision of the SE 1/4.
SE 1/16 sets 1327.35' of EC 1/16 and 1324.89' of SC 1/16.

Resident witnesses:

J. Claflin - RL
H. Wagoner

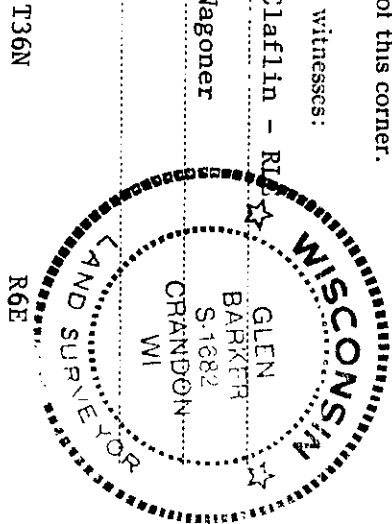

Description of monument and accessories I established to perpetuate the original location of this corner.
Set a 2" iron pipe with 2" diameter alloy cap stamped:
Monument projects 18" above ground.

Marked NBTs:
Jack pine 8" S13E 12.42' T36N R6E
Jack pine 4" N84E 28.34' S1682
Scribed 1/16 - B.T. SE 1/16 S 30
CPI - 1983

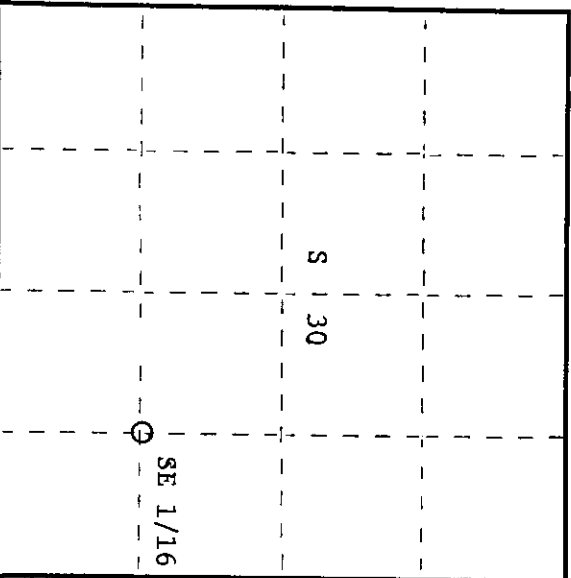

○ = Corner monument restored.

Dated at Rhineland, Wis., this 13th day of February, 1984

Signature Glen Barker Title Registered Land Surveyor Registration No. S1682
(County Surveyor, Registered Land Surveyor, or other duly authorized official)

Office of Register of Deeds, County of Oneida hereby certify that the within instrument was filed in this office for record on the 13th day of February, 1984 at 10:00 o'clock A. M.

Louise Savage Kuehn
(Register of Deeds)

By: _____ Deputy

3606301010