

U.S. PUBLIC LAND SURVEY MONUMENT RECORD

Note: This form is intended and designed to fulfill all requirements of Wisconsin Administrative Code, Chapter A-E 7.08 U.S. Public Land Survey Monument Record (3) (a) (b) (c) (d) (e) (f) (g) (h) (i). An additional sheet may be added if necessary to conform with said requirements.

(a) Corner location: Township 36 North

Range 7 East/West

Town/City/Village Woodboro

County Oneida

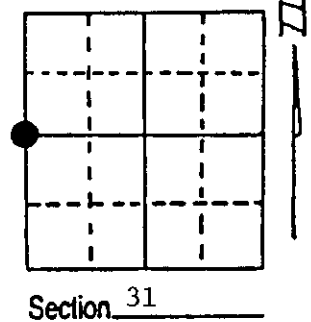

(b) (f) (g) (h) Description of monument found at this corner and if it was accepted, state all evidence (material, testimonial, occupational, plats, records, other monuments) used as a basis for accepting. If not accepted or if nothing was found, state evidence used as basis for establishing location. If reestablished through lost corner proportionate methods, indicate all monuments, distances and directions used to establish. Indicate type of monument found or set and sign post.

8/31/60 - Alfred Millard established this corner and set a wood post with two BTs:
 8" Spruce Pine, S27°W, 7 Links 14" Spruce Pine, N45°W, 22 Links

1916 - Railroad plat ties to corner.

5/1/1974 - DOT found 1" iron pipe with 4" x 4" wood post along side.

7/25/89 - Milo E. Stefan found 1" x 36" iron pipe in post hole, with 4" x 4" x 6' scribed cedar post along side a 16" Jack Pine, S58°W, 66.95' - scribed in BT face many years ago (30 - 70). 14" Jack Pine, N41°W, 21.73' - scribed in BT face many years ago (30 - 70). We made two new BTs, established a Witness Corner and placed two plastic sign posts. (see below). Stump holes support iron pipe from original BTs remains.

(c) (d) (e) Plan view of corner with ties to at least 4 witness monuments. If in disagreement with previously established corner, show the distances between the two corners and also indicate the ties to the disputed corner.

- 1) 1" x 36" iron pipe with 4" x 4" x 6' cedar post along side.
- 2) 2" x 30" aluminum Oneida County Monument, set for a Witness Corner, N85°E, 92.05'
- 3) 7" Jack Pine, N62°E, 109.00'
- 4) 8" Jack Pine, S70°E, 95.91'
- 5) 16" Jack Pine, S58°W, 66.95'
- 6) 14" Jack Pine (dead), N41°W, 21.73'
- 7) Plastic sign posts

Distances to nail in side of BTs.
 BTs scribed "BT" in stump blaze.

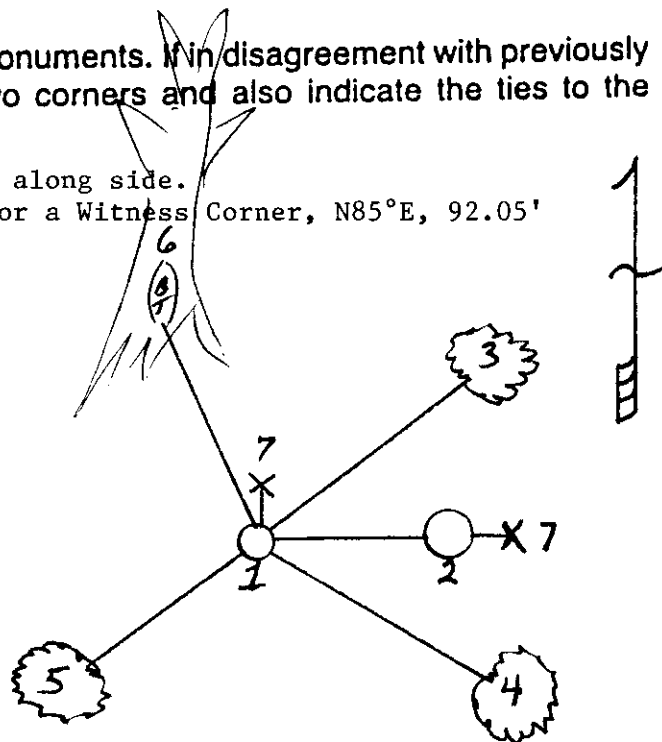

(i) I, Milo E. Stefan
 (type or print name) certify that the corner location on this record was determined by me or under my direction and control and that this U.S. Public Land Survey Monument Record is correct and complete to the best of my knowledge and belief.

Milo E. Stefan
 Signature

8/5/89
 Date



Index No. X-1

3606362000