

U.S. PUBLIC LAND SURVEY MONUMENT RECORD

Note: This form is intended and designed to fulfill all requirements of Wisconsin Administrative Code, Chapter A-E 7.08 U.S. Public Land Survey Monument Record (3) (a) (b) (c) (d) (e) (f) (g) (h) (i). An additional sheet may be added if necessary to conform with said requirements.

(a) Corner location: Township 36 North
 Range 7 East/West

Town/City/Village WOODBORO

County ONEIDA

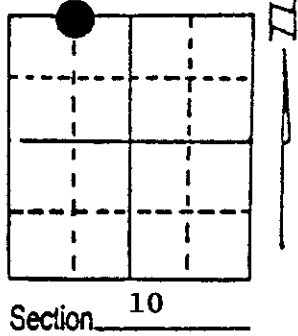

(b) (f) (g) (h) Description of monument found at this corner and if it was accepted, state all evidence (material, testimonial, occupational, plats, records, other monuments) used as a basis for accepting. If not accepted or if nothing was found, state evidence used as basis for establishing location. If reestablished through lost corner proportionate methods, indicate all monuments, distances and directions used to establish. Indicate type of monument found or set and sign post.

- Sept. 10, 1893 B.F. Dorr, Oneida County Surveyor, indicated in his notes a 8" Sugar N5½E 21½ links witnessing the corner.
- July 27, 1937 V. Maine, Oneida County Surveyor, indicated in his survey notes that he ran west from the original N1/4 Sec. 10, mag var 18°50'E 41.26 chains to the original NW corner of Section 10 and set a Oak stake for the 1/8 corner at 20.63 chains witnessed by a 8" Sugar S1°E .57 ch and in his 1937 diary he also indicates a 6" Oak West .358
- October 12, 1989 Michael Romportl - Oneida County Cartographer/Surveyor and Richard Rollman, Oneida County Forest Administrator, visited this corner to verify that the iron pipe now marking this corner is the same location of that established by Maine.

OVER

(c) (d) (e) Plan view of corner with ties to at least 4 witness monuments. If in disagreement with previously established corner, show the distances between the two corners and also indicate the ties to the disputed corner.

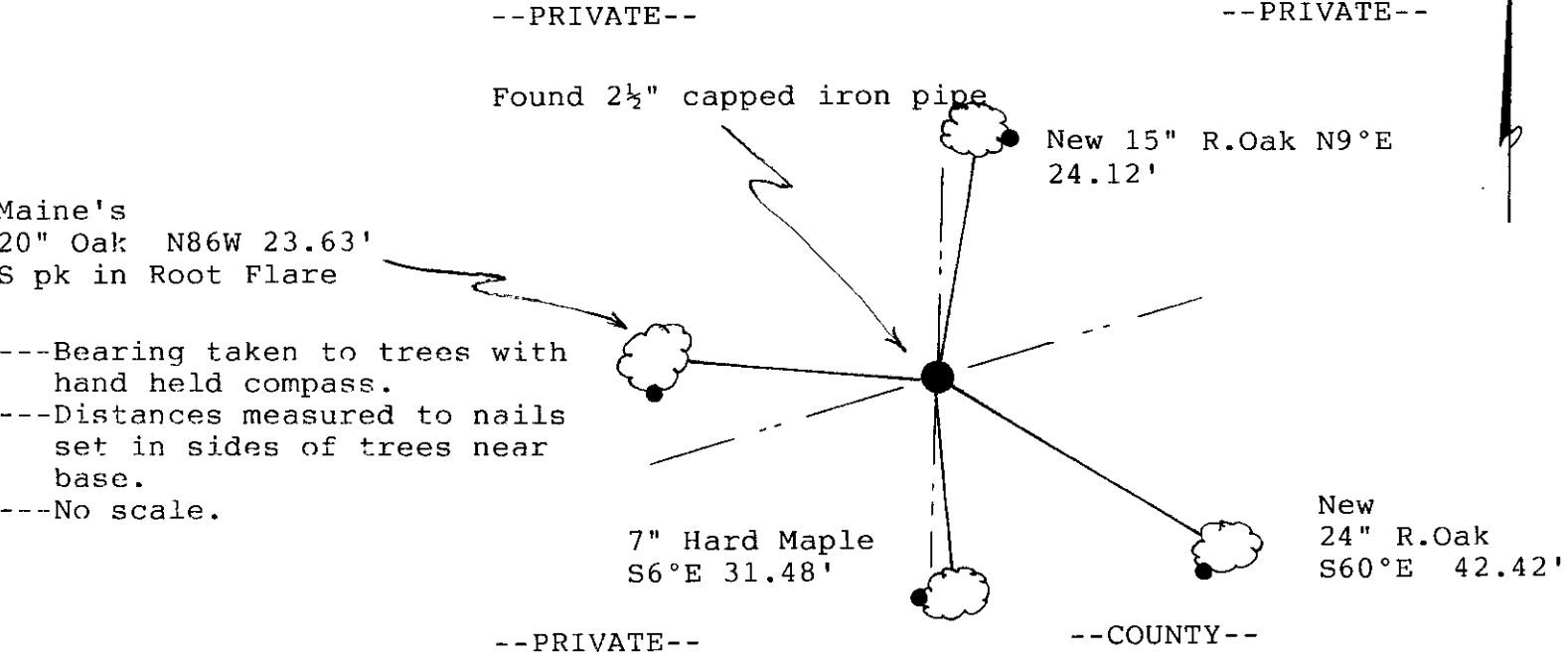

(i) I, MICHAEL J. ROMPORTL
 (type or print name) certify that the corner location on this record was determined by me or under my direction and control and that this U.S. Public Land Survey Monument Record is correct and complete to the best of my knowledge and belief.

Michael J. Romportl 10/23/89
 Signature Date

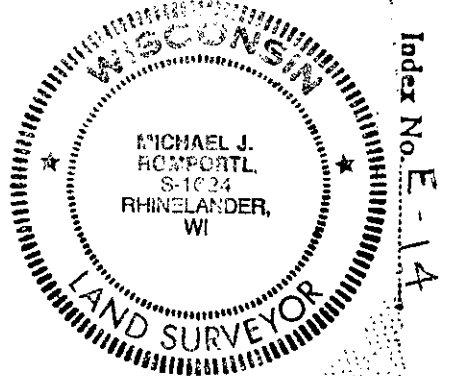

3607030030



Stock No. 26273

We began at the NW corner of Section 10 and ran a compass bearing Easterly and measured with a chain at approximate intervals of 100' to find the location of the 1/8 corner. Distance measured approximately 1360' to 1/8 corner.

At the location we found a 2½" capped iron pipe stamped 1/8 protruding 2½' above grade. No evidence of Maines Sugar witness was found, however we found a 20" Red Oak with a seam visible N86°W 23.6' to face. This appears to be Maines tree but did not want to cut it open to look for scribing since it is on private property. We also found a 8" Soft Maple @ N70°W 7.5' with a Wisconsin Conservation aluminum location poster nailed to it. Scribed on the tag is "IP set 1/6/56" also "R.A.Peters 7/6/58 or 53". It was common practice for surveyors or cruisers to write on the tag when they visited a corner. We ran from this corner easterly with compass bearing and again measured with a chain at approximate intervals of 100' to find the N¼ of Section 10. Measured approximately 1355' to 1/4 corner. Therefore it appears Maine set the 1/8 corner very close to 1/2 way between the NW and N1/4.

I conclude that the 1/8 corner marked by the iron pipe is very close to the same location established by Maine and further witnessed the corner as shown in the sketch on reverse side to preserve the corner location. Mr. Rollman pointed out that this was the corner which was used to mark a line south between private and county lands.