

This form is intended to fulfill the requirements of Chapter A-E 7.08 (3)(a) thru (i) U.S. Public Land Survey Monument Location Record, Wisconsin Administrative Code. Use the reverse side of form for continuation.

**U.S. PUBLIC LAND SURVEY MONUMENT LOCATION RECORD**

USPLS CORNER: WEST WITNESS MC SECTION: 23 TOWNSHIP: 36 NORTH RANGE: 7 EAST

NAME OF WATERWAY FOR M.C. CORNER : NOSE LAKE SECTION LINE: NORTH

(CITY)(VILLAGE)(TOWN) OF: WOODBORO COUNTY OF: ONEIDA

Description of monument found or placed and all other evidence used as the basis for monument location; including monuments and related measurements required if the corner location was reestablished by lost corner proportionate methods. Also indicate name of original surveyor, original survey date and the corner monument, bearing trees, witness or other reference monuments established; including measured bearing and distance ties, from available records.

Found and accepted an old 2" dia. galvanized iron pipe with stamped brass plug/cap 24" up in lake ice 2'+- North of lake shoreline bearing N55°W this date; monument is tipped slightly to NNW but very stable, so new ties measured to cap center. Corner is located on the North side of a point of land into Nose Lake at Fire No. 7625 West Point Road.

In November 1862, Joseph H. Jenkins/GLO set a wood post as the original corner and marked OBTs: a 7" Py N04°W 20 links and an 8" Birch N77°W 72 links; all are now obliterated.

In July 1937, V.M. Maine notes propable monument at this corner by a circle symbol on his field notes sketch of Section 23 in Oneida County survey records; it is likely that Maine set this brass capped pipe in 1937 as he often did at PLSS corners.

In December 1963, James G. Griffin/RLS 755 notes this corner by map symbol as a probable iron pipe monument per Plat of Survey filed as C-793 in Oneida County survey records, as in 1964 he notes this corner as an Oneida County capped iron pipe per Plat of Wal-Hun-Woods in Oneida County records.

In December 1995, Aero-Metric, Inc. found a 2" iron pipe with stamped cap at this corner per their GPS location sheet in Oneida County survey records. In January 1997, Michael J. Romportl/RLS 1624 found a brass capped monument at this corner per Plat of Survey filed as B-5026 in Oneida County survey records.

This recovery completed November 21, 2002; there were no direct witnesses.

Plan view map of monument location with bearing and distance ties to a minimum of four(4) described witness or reference monuments of concrete, natural stone, iron, live bearing trees or equivalent material. If applicable, also show a minimum of two(2) bearing and distance ties to any other monument found and not accepted; including the bearing and distance from the accepted monument.

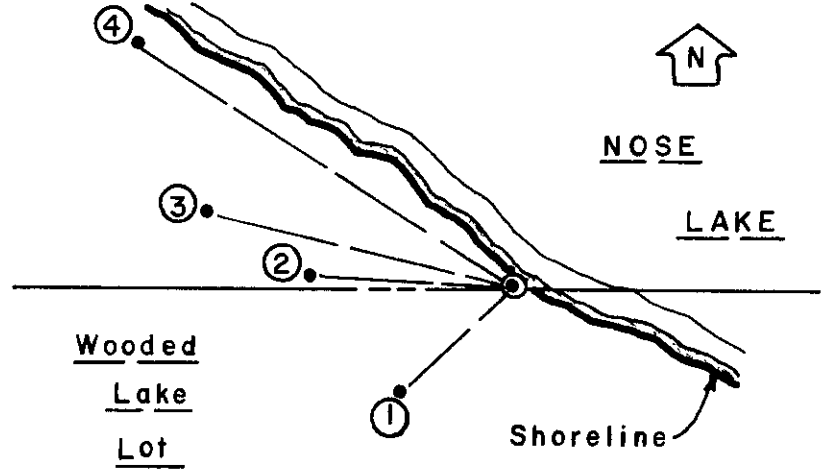

**WITNESS MONUMENT TIES:**

- ① New 9" Mr BT S46°W 16.54'.
- ② New 11" Bw BT N86°W 20.80'.
- ③ New 7" Pw BT N76°W 32.62'.
- ④ New 6" Pw BT N57°W 46.00'.

Standard white poly 'T' marker post set 20" South of corner monument at lake shoreline.

SCALE: 1" = 20'

Unless otherwise indicated, all bearing tree ties are to a .25" dia. by 2.5" long PK nail with a 1.25" dia. steel washer driven into unblazed right face and a .25" dia. by 2.5" long PK nail with a 2" dia. steel washer stamped BT is also driven into unblazed face of bearing tree at DBH; the basis for measured bearings is by compass to nearest degree and all tie distances are measured horizontal by steel tape corrected to nearest 1/100th feet at standard temperature of 68° F.

RLS SEAL:



LAND SURVEYOR CERTIFICATE:

I, William C. Rohde, hereby certify that I am duly licensed as a Professional Land Surveyor in the State of Wisconsin; that this USPLS monument location was determined by me and/or under my direct supervision and control; and that this U.S. Public Land Survey Monument Location Record is true and correct to the best of my knowledge and belief.

Signed: *William C. Rohde*  
William C. Rohde RLS 841

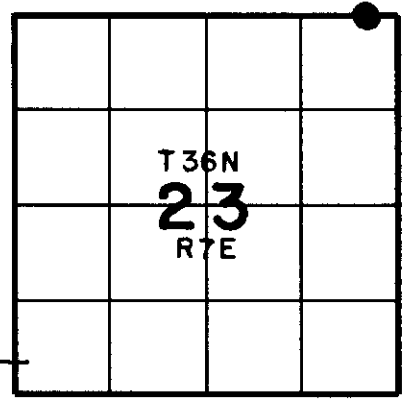

SECTION LOCATION MAP  
INDEX NO. N 20-21

Date Signed: March 1, 2003

3607140002