

CERTIFIED LAND CORNER RESTORATION

State of Wisconsin

County of ONEIDA

ss.

Sta. 52 + 86.40

2" IRON PIPE WITH BRASS CAP

I, Herbert Moore, do hereby certify that on the tenth day of October, 1975, I found evidence of the east quarter corner of Sec. 16, Township 36 North, Range 7 East, Fourth Principal Meridian, as described hereon; and that from this evidence I established a new monument and accessories as described hereon to perpetuate the original location of this corner:

Description of original monument and accessories and subsequent restorations:

The original monument for the east quarter corner of Sec. 16 has been reported to be in a location north of Trout Creek and it seems to be incorrect as there is no evidence of witness trees reported in that location. The incorrect corner has not been removed.

Wood Hub Sta. 44+55.70

158°-47'

Wood Hub Sta. 40+80.10

North edge of swamp wood hub Sta. 37+13.75

Description of corner evidence found:

A traverse was run from the SE corner of Sec. 16 to the NE corner of the section, and the quarter corner established as indicated on the plat of survey shown on this sheet

Enter swamp Sta. 28+95.00

Description of monument and accessories I established to perpetuate the location of this corner:

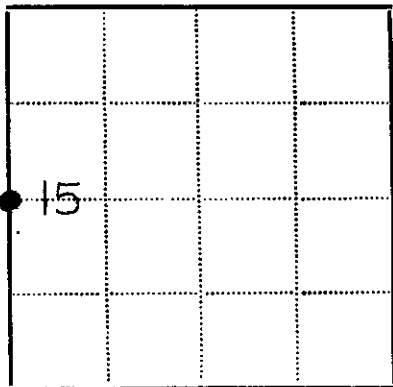
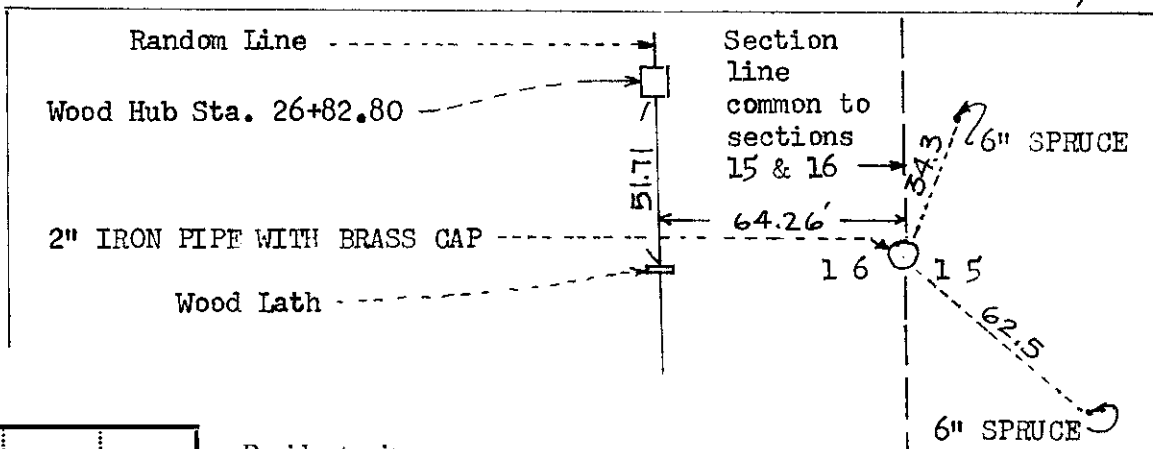

● - Corner monument restored
□ -

Resident witnesses Oscar Egger

Dated at Rhineland Wisconsin, this 11 day of October 1975

Signature Herbert Moore Title County Surveyor
(County Surveyor, Registered Land Surveyor, or other duly authorized official)

Surveyors Registration No. 407

Office of REGISTER OF DEEDS County of ONEIDA
I hereby certify that the within instrument was filed in this office for record on the 15th day of October 1975, and was filed in Book No. 1 Page No. of County Records.

Signature Doris Verage Kuehn Title Register of Deeds

Township 36 N, Range 7 East, Section 16, Index No., Page No.

3607162000

2" IRON PIPE WITH BRASS CAP

L-13