

52-3

Resident witnesses _____

Dated at Rhinelanders Wisconsin, this 12 day of Dec. 1981

Signature _____ Title R.L.S.

(County Surveyor, Registered Land Surveyor, or other duly authorized official)

Surveyors Registration No. 1383

Office of REGISTER OF DEEDS County of Oneida

I hereby certify that the within instrument was filed in this office for record on the 17th day of September 1982 and was filed in Book No. _____ of County Records.

Signature _____ Title REGISTER OF DEEDS

Range _____ Section _____ Index No. _____ Township _____ Page No. _____

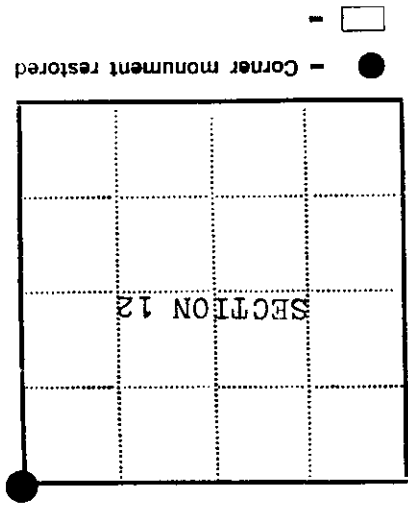

bearings magnetic, distances to p.k. nail in face of scribed blaze.

cedar 6" S 32 E 55.18' / cedar 4" S 81 E 59.00
 utility pole (P.K. in face of pole) S 45 W 59.85'
 Found 1" iron pipe S 83 W 25.04' (W.E. Bandows)
 Found 3/4" iron pipe S 75 E 33.31'
 Left bank of the Wisconsin River North 10'

corner found in place 2 1/2" iron pipe 4" above ground, pipe in good condition did not replace witnessed to the following:

Description of monument and accessories I established to perpetuate the location of this corner:

- 1896 D.H. Vaughn at corner
- 1898 B.F. Dorr at corner
- 1948 R.R. Vincentsen iron pipe at corner
- 1955 R.E. Badow iron pipe at corner
- 1971 N. Lotrus found iron pipe at corner
- Description of corner evidence found:
- 1973 A.M. Hess found iron pipe at corner
- 1975 Wisconsin Dept. of Transportation found 2 1/2" iron pipe at corner
- 1978 W.E. Badow found 2 1/2" iron pipe at corner set iron pipe westerly
- 1979 W. Imnich found 2 1/2" iron pipe at corner tied to previous surveys

80.00 Left bank Wisconsin River set post of meander corner and corner to sections 1, 6, 7 & 12 Birch 10 SW 71k. 1/2 Birch 7 S70E 161k.

Description of original monument and accessories and subsequent restorations:
 Hiram C. Fellows Government Surveyor 1859

I, William Imnich, do hereby certify that on the 12th day of Dec. 1981, I found evidence of the Northeast corner corner of Section 12 Township 36 North Range 8 East Fourth Principal Meridian, as described hereon; and that from this evidence I established a new monument and accessories as described hereon to perpetuate the original location of this corner:

State of Wisconsin }
 County of Oneida } ss.

CERTIFIED LAND CORNER RESTORATION