

At \_\_\_\_\_ O'Clock \_\_\_\_\_ M  
**THOMAS H. LEIGHTON**  
REGISTER OF DEEDS  
Recorders Data

This form is intended to fulfill the requirements of Chapter A-E7.08 (3)(a) thru (i) U.S. Public Land Survey Monument Location Record, Wisconsin Administrative Code. Use the reverse side of form for continuation.

**U.S. PUBLIC LAND SURVEY MONUMENT LOCATION RECORD**

USPLS CORNER: NW SECTION: 11 TOWNSHIP: 36 NORTH RANGE: 8 EAST

NAME OF WATERWAY FOR M.C. CORNER: N/A SECTION LINE: N/A

~~(CITY)VILLAGE(TOWN)~~ OF: CRESCENT COUNTY OF: ONEIDA

Description of monument found or placed and all other evidence used as the basis for monument location; including monuments and measurements required if the corner location was reestablished by lost corner proportionate methods. Also indicate name of the original surveyor, original survey date and the corner monument, bearing trees, witness or other reference monuments established, including measured bearing and distance ties, from available survey records.

In July 1863, William E. Daugherty/GLO set a wood post as the original corner and noted OBTs: a 10" Bw S11°W 23 links and a 9" Bw N72°E 25 links; all are now obliterated. On October 16, 1931 Harold C. Hall found an iron pipe at the corner which agreed with previous BT stumps by Vaughan and stump hole of original GLO Bw BT S11°W. On October 31, 1931 Harold C. Hall set a 6" x6"x36" concrete monument with 6" exposed in place of the iron pipe he had found at the corner on October 16, 1931, and noted witness ties of S64°E .386 chains to a Vaughan stump; N34°40'W .952 chains to a Vaughan stump; S11°W .229 chains to original GLO Bw stump hole and S77°E .182 chains to an 'X' chiseled onto a 3' x 5' boulder; all witness ties are now obliterated.

In June 1934, during a Dependent Resurvey of Section 2, Township 36 North, Range 8 East, Hal D. Craig of GLO found and accepted the concrete monument set by Hall in 1931 at this corner and noted witness ties of S76.5°E 18 links to a cross cut found on top of a 5' dia. x 3' high boulder (previously noted by Hall); a 10" Pw stump S63.5°E 39 links and scribed "S11 BT"; and a 7" Pr S86°45'E 200 links scribed "T36N R8E S11 BT"; all witnesses are now obliterated. See GLO Field Notes filed as L-362F in Oneida County survey records.

On June 13, 2006 I found a disturbed 6" sq. concrete monument with top broken off at this corner which I carefully removed and reset its location with a standard 2" dia. x 30" long aluminum pipe monument with stamped Oneida County cap to grade level and secured with granular fill for new ties noted below. I was assisted by Richard Sener, Rhinelander Airport employee. Corner falls in a large open graded and mowed airport area field with no convenient BTs nearby.

Plan view map of monument location with bearing and distance ties to a minimum of four(4) described witness or reference monuments of concrete, natural stone, iron, live bearing trees or equivalent material. If applicable, also show a minimum of two(2) bearing and distance ties to any other monument found and not accepted; including the bearing and distance from the accepted monument.

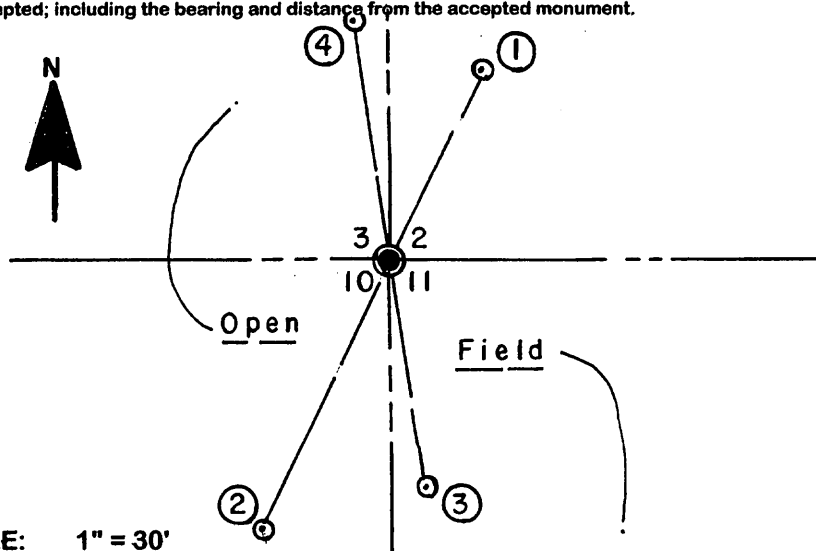

**WITNESS MONUMENT TIES:**

- ① 5/8" dia. x 24" long rebar set with yellow poly Reference Mark cap flush N26°E 33.01'.
- ② Same set S26°W 46.66'.
- ③ Same set N09°W 38.15'.
- ④ Same set S09°E 35.86'.

All set on a right line thru the monument cap center with a T1 Wild Theodolite.

Standard white poly 'T' marker post set 12" South of the corner monument.

SCALE: 1" = 30'

Unless otherwise indicated, all bearing tree ties are to a .25" dia. by 2.5" long PK nail with a 1.25" dia. steel washer driven into unblazed right face and a .25" dia. by 2.5" long PK nail with a 2" dia. steel washer stamped BT is also driven into unblazed face of bearing tree at DBH; the basis for measured bearings is by compass to nearest degree and all tie distances are measured horizontal by steel tape corrected to nearest 1/100th feet at standard temperature of 68° F.

RLS SEAL:



**LAND SURVEYOR CERTIFICATE:**

I, William C. Rohde, hereby certify that I am duly licensed as a Professional Land Surveyor in the State of Wisconsin; that this USPLS monument location was determined by me and/or under my direct supervision and control; and that this U.S. Public Land Survey Monument Location Record is true and correct to the best of my knowledge and belief.

Signed: *William C. Rohde*  
William C. Rohde RLS 841

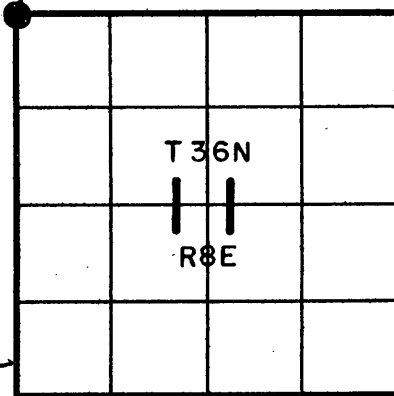

SECTION LOCATION MAP  
INDEX NO. E 17