

This form is intended to fulfill the requirements of Chapter A-E7.08 (3)(a) thru (i) U.S. Public Land Survey Monument Location Record, Wisconsin Administrative Code. Use the reverse side of form for continuation.

U.S. PUBLIC LAND SURVEY MONUMENT LOCATION RECORD

USPLS CORNER: SOUTH WITNESS MC SECTION: 18 TOWNSHIP: 36 NORTH RANGE: 9 EAST
 NAME OF WATERWAY FOR M.C. CORNER : JULIA LAKE SECTION LINE: WEST
 (CITY)(VILLAGE)(TOWN) OF: PELICAN COUNTY OF: ONEIDA

Description of monument found or placed and all other evidence used as the basis for monument location; including monuments and measurements required if the corner location was reestablished by lost corner proportionate methods. Also indicate name of the original surveyor, original survey date and the corner monument, bearing trees, witness or other reference monuments established, including measured bearing and distance ties, from available survey records.

Found old 1" dia. iron pipe with uncapped top 2" up and tipped about 2" South at top due to subsurface rooting, so I replumbed the iron pipe and drove a standard 2" dia. by 30" long aluminum pipe monument with stamped Oneida County cap over it to 3" above grade. Also found a standard white poly "T" marker post 6" SE and flagging only on nearby trees; corner falls about 6.5' South of irregular vegetated lake shoreline bearing N35°W & S60°E and is accessible on foot via a gravelled pathway South from Cranes Road.

In July 1859, H.C. Fellows/GLO set a wood post as original meander corner and noted OBTs: 10" Tamarack S28°E 11 links and a 10" Tamarack N60°W 6 links; all now obliterated beyond recovery purposes.

In July 1973, Genisot & Associates, Inc. of Rhinelander, Wisconsin indicate an iron pipe set at this corner per legend on Plat of Survey filed as B-5200 in Oneida County survey records.

In March 2002, Charles L. Oleinik/RLS 2439 indicates a 1" iron pipe found per legend on Plat of Survey filed as C-1877 in Oneida County survey records.

This corner previously located by GPS control survey per Oneida County survey records.

Recovery completed 09/21/04; there were no direct witnesses.

Plan view map of monument location with bearing and distance ties to a minimum of four(4) described witness or reference monuments of concrete, natural stone, iron, live bearing trees or equivalent material. If applicable, also show a minimum of two(2) bearing and distance ties to any other monument found and not accepted; including the bearing and distance from the accepted monument.

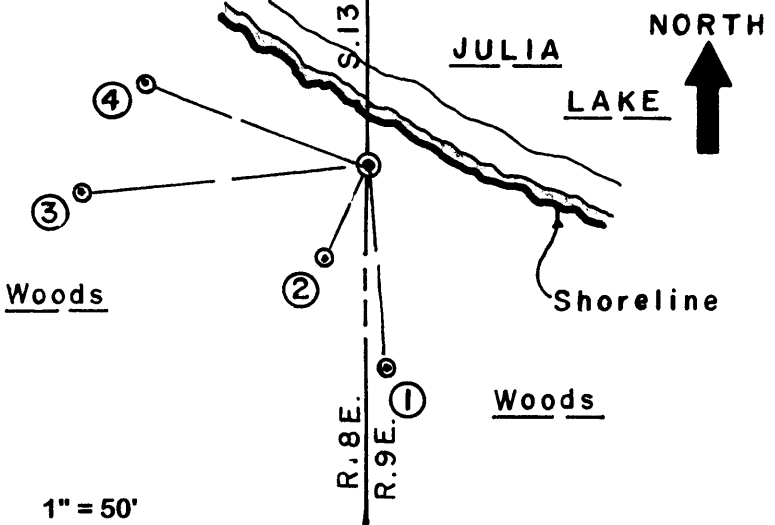

- WITNESS MONUMENT TIES:**
- ① New 14" Spruce BT S05°E 53.28'
 - ② New 14" Spruce BT S25°W 27.35'.
 - ③ New 9" Spruce BT S84°W 74.82'.
 - ④ New 14" Spruce BT N69°W 62.13'.
- No older BTs readily observed nearby.
 I flagged monument, T post and all new BTs blaze orange.

SCALE: 1" = 50'

Unless otherwise indicated, all bearing tree ties are to a .25" dia. by 2.5" long PK nail with a 1.25" dia. steel washer driven into unblazed right face and a .25" dia. by 2.5" long PK nail with a 2" dia. steel washer stamped BT is also driven into unblazed face of bearing tree at DBH; the basis for measured bearings is by compass to nearest degree and all tie distances are measured horizontal by steel tape corrected to nearest 1/100th feet at standard temperature of 68° F.

RLS SEAL:



LAND SURVEYOR CERTIFICATE:

I, William C. Rohde, hereby certify that I am duly licensed as a Professional Land Surveyor in the State of Wisconsin; that this USPLS monument location was determined by me and/or under my direct supervision and control; and that this U.S. Public Land Survey Monument Location Record is true and correct to the best of my knowledge and belief.

Signed William C. Rohde
 William C. Rohde RLS 841

